

For Lease: BLACKHAWK OFFICE SPACE DANVILLE | CA



4155 BLACKHAWK PLAZA CIRCLE

PROPERTY HIGHLIGHTS

- Located above Blackhawk Plaza and across from Tassajara Crossing retail center
- **1,475 RSF** on the upper level and **6,477 RSF** on the lower level (divisible)
- Attractive building interiors
- Ideal space for a startup or established company
- Floor plans on reverse side
- Abundance of free surface lot parking
- Easy access to I-580 and I-680
- Call to schedule a tour and hear about **leasing incentives**

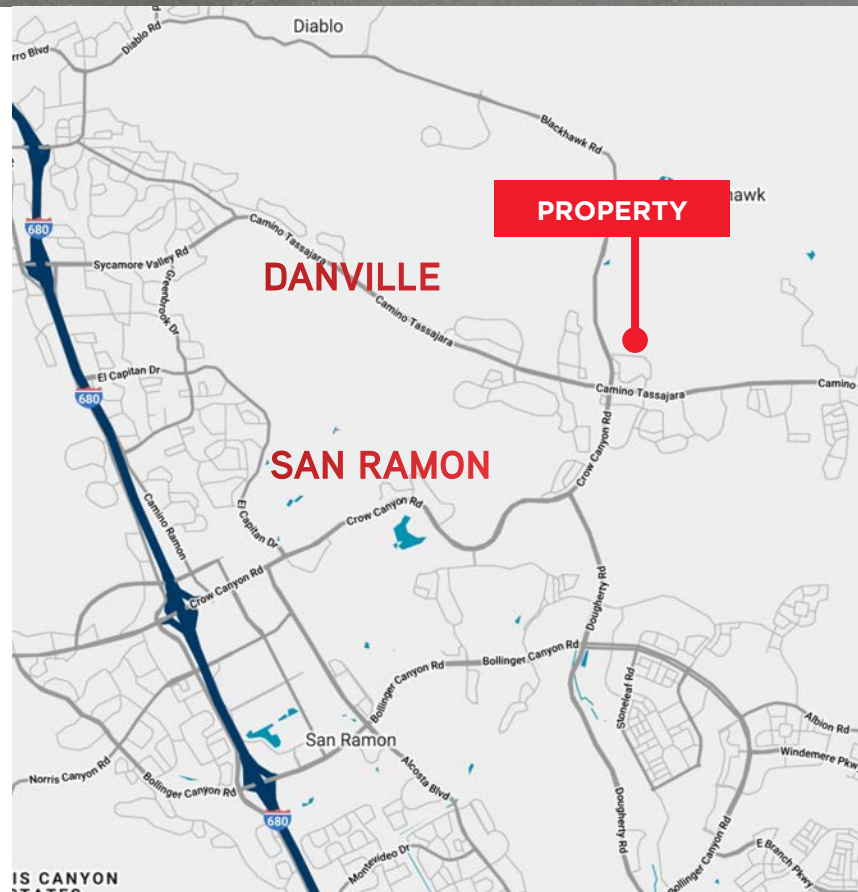

MICHAEL COPELAND

Managing Director | +1 925 621 3855 | michael.copeland@cushwake.com | CA License #00898210

CUSHMAN & WAKEFIELD

For Lease:
BLACKHAWK OFFICE SPACE
DANVILLE | CA



MICHAEL COPELAND

Managing Director | +1 925 621 3855 | michael.copeland@cushwake.com | CA License #00898210



For Lease: BLACKHAWK OFFICE SPACE DANVILLE | CA

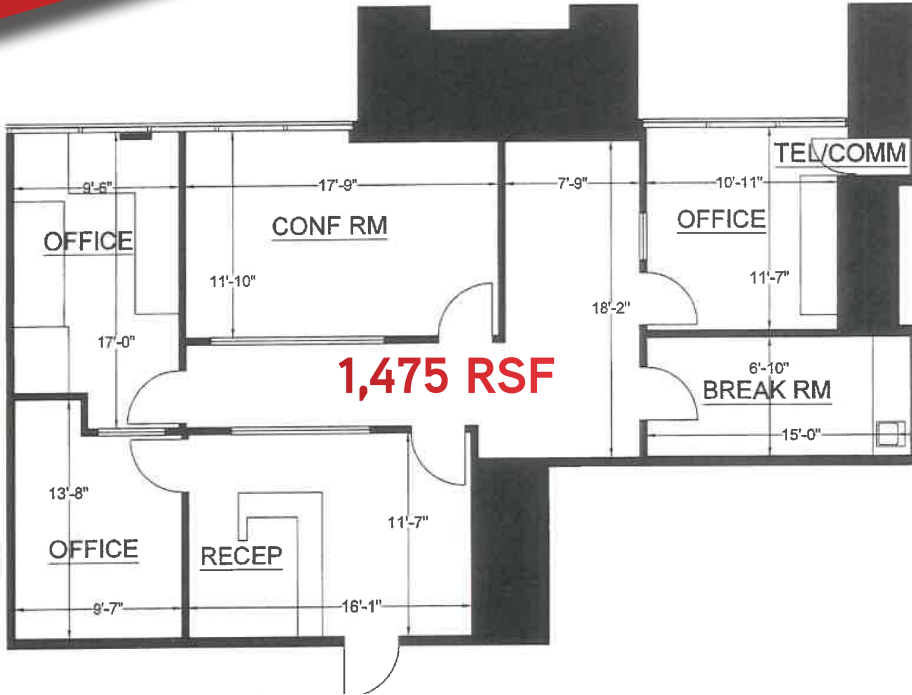

UPPER LEVEL

LOWER LEVEL

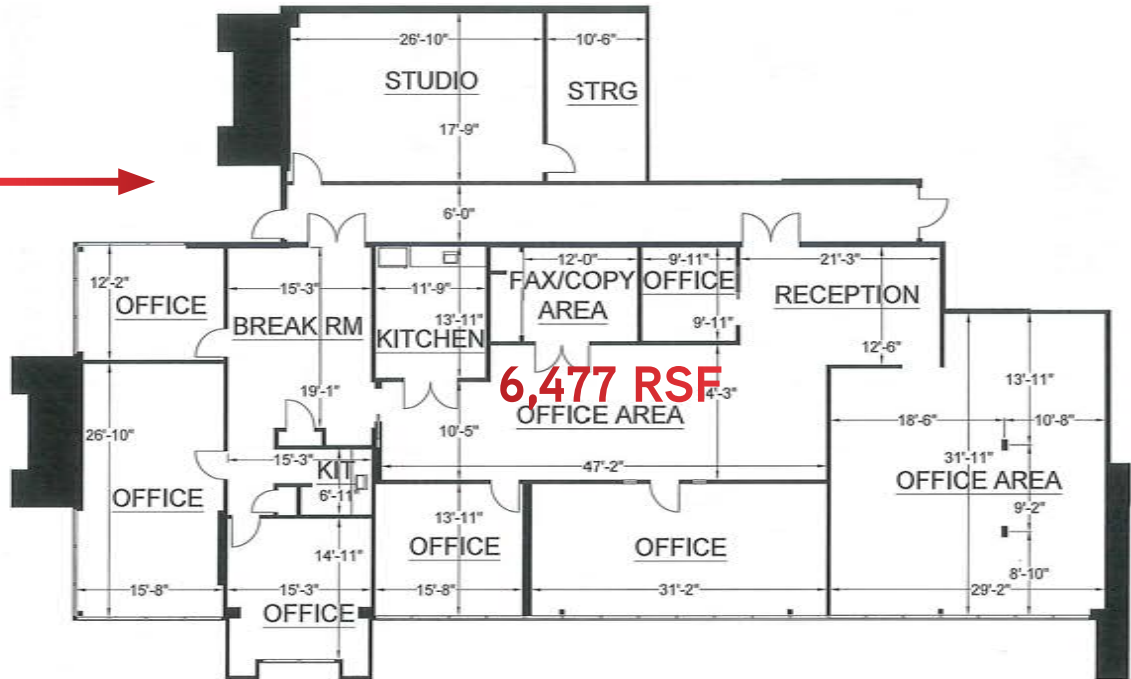

©2023 Cushman & Wakefield. All rights reserved. The information contained in this communication is strictly confidential. This information has been obtained from sources believed to be reliable but has not been verified. NO WARRANTY OR REPRESENTATION, EXPRESS OR IMPLIED, IS MADE AS TO THE CONDITION OF THE PROPERTY (OR PROPERTIES) REFERENCED HEREIN OR AS TO THE ACCURACY OR COMPLETENESS OF THE INFORMATION CONTAINED HEREIN, AND SAME IS SUBMITTED SUBJECT TO ERRORS, OMISSIONS, CHANGE OF PRICE, RENTAL OR OTHER CONDITIONS, WITHDRAWAL WITHOUT NOTICE, AND TO ANY SPECIAL LISTING CONDITIONS IMPOSED BY THE PROPERTY OWNER(S). ANY PROJECTIONS, OPINIONS OR ESTIMATES ARE SUBJECT TO UNCERTAINTY AND DO NOT SIGNIFY CURRENT OR FUTURE PROPERTY PERFORMANCE.

MICHAEL COPELAND

Managing Director | +1 925 621 3855 | michael.copeland@cushwake.com | CA License #00898210

