

1145 E
22nd Street
Indianapolis, IN 46202

AS-IS SALE
LENDER OWNED PROPERTY

\$75/SF
\$1,780,125

EXCLUSIVE LEASING AGENT



1145 E 22ND STREET

As-Is Sale / Lender-owned Property, listed below market

- 23,735 SF, two-story building located along the Monon Trail and E. 22nd Street
- Four (4) parcels combine for 0.95 AC, and include the courtyard and west parking lot
- Ideal user is an owner/occupant, 15,322 SF available RSF, common areas represent 35%
- Two (2) short-term lease are in place thru March 2025, representing 22% of the current occupancy
- The immediate area is zoned CS, and will require a City hearing for its intended use.
- Adjacent property south of the premises, 2130 Yandes St, is not included in the sale
- Playground and parking lot east of the parcel are not a part of the property
- Sale Price: \$75/SF - \$1,780,125
- OPEX: \$7.60 PSF

This charming 2-story, brick building, was a former Charter School and office for local NFPs. The property features bright, open-air offices, with a courtyard, kitchenette, elevator, and key-fob security entry. Surrounded by new residential projects, with close proximity to Downtown, the area has new sidewalks and bike lanes. Join the neighborhood redevelopment along E. 22nd Street: King Park, Kennedy King and now Martindale Brightwood!

1145 E 22ND STREET

FIRST FLOORPLAN



LEGEND

CIRCULATION/ SHARED: 4,398 SF
 TENANT: 7,250 SF
COMBINED: 11,648 SF

385 SF VERTICAL CIRCULATION
 4,013 SF COMMON SPACE

SUITE 105 VACANT
 SUITE 103 KIPP INDY

SUITE 101 KIPP INDY
 SUITE 102 KIPP INDY

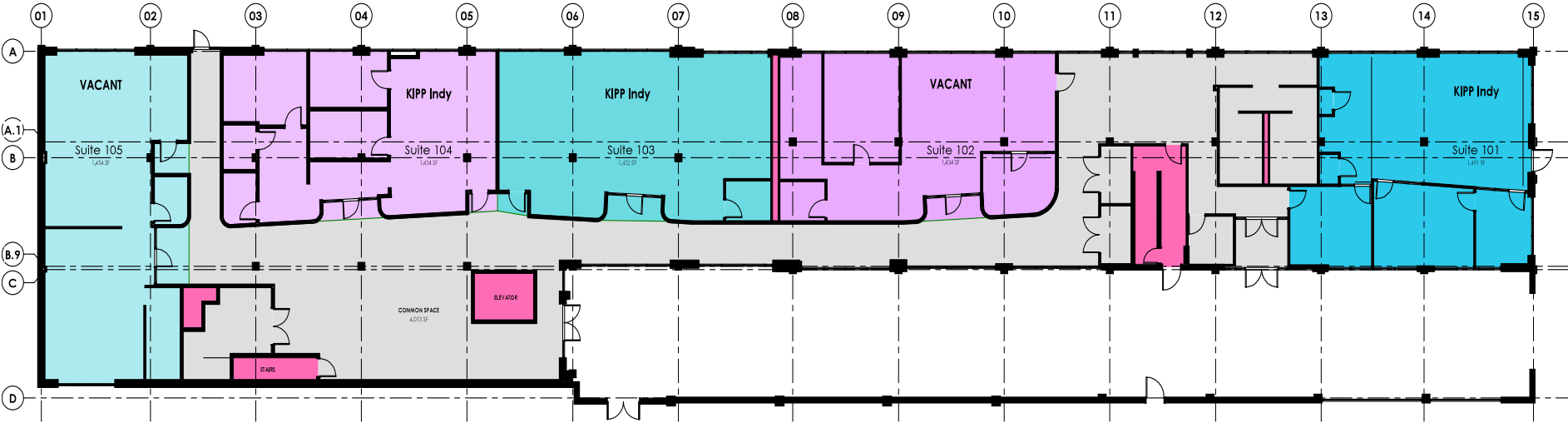

1145 E 22ND STREET

SECOND FLOORPLAN



LEGEND

CIRCULATION/ SHARED: 4,014 SF
 TENANT: 8,072 SF
COMBINED: 12,086 SF

448 SF VERTICAL CIRCULATION
 3,566 SF COMMON SPACE

SUITE 205 VACANT 1,117 SF VACANT
 SUITE 203B VACANT SUITE 203 A VACANT
 SUITE 202 VACANT SUITE 205 VACANT
 SUITE 205 IRIS ROSA DANCE STUDIO 12,610 SF GROSS

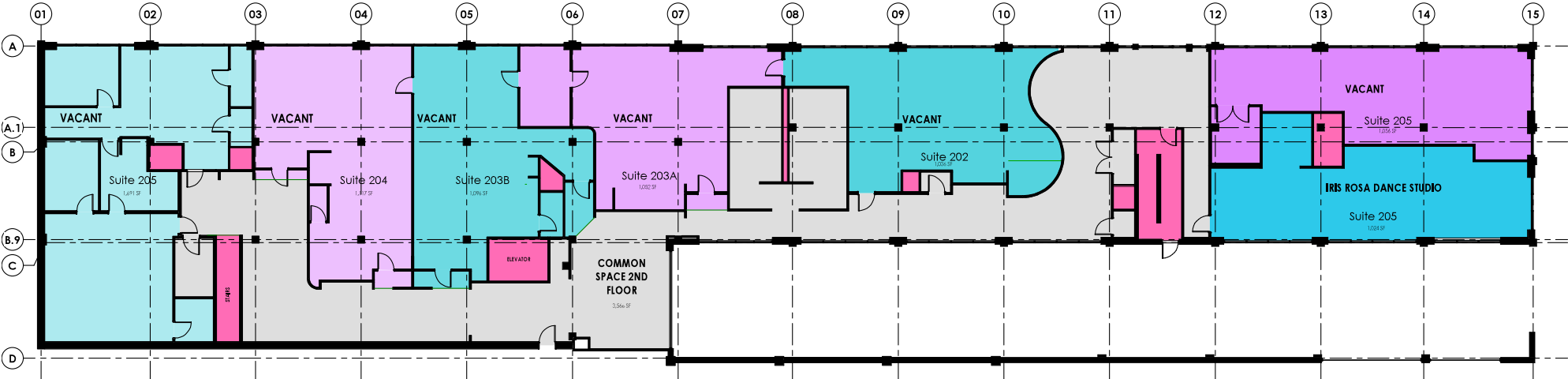

1145 E
22nd Street
Indianapolis, IN 46202

AS-IS SALE
LENDER OWNED PROPERTY

For more information, please contact:

CARMEN THOMPSON

Senior Associate

Direct: +1 317 352 5430

carmen.thompson@cushwake.com

WWW.CUSHMANWAKEFIELD.COM

EXCLUSIVE LEASING AGENT



©2024 Cushman & Wakefield. All rights reserved. The information contained in this communication is strictly confidential. This information has been obtained from sources believed to be reliable but has not been verified. NO WARRANTY OR REPRESENTATION, EXPRESS OR IMPLIED, IS MADE AS TO THE CONDITION OF THE PROPERTY (OR PROPERTIES) REFERENCED HEREIN OR AS TO THE ACCURACY OR COMPLETENESS OF THE INFORMATION CONTAINED HEREIN, AND SAME IS SUBMITTED SUBJECT TO ERRORS, OMISSIONS, CHANGE OF PRICE, RENTAL OR OTHER CONDITIONS, WITHDRAWAL WITHOUT NOTICE, AND TO ANY SPECIAL LISTING CONDITIONS IMPOSED BY THE PROPERTY OWNER(S). ANY PROJECTIONS, OPINIONS OR ESTIMATES ARE SUBJECT TO UNCERTAINTY AND DO NOT SIGNIFY CURRENT OR FUTURE PROPERTY PERFORMANCE.