

FOR SALE

2260 Del Paso Road

Sacramento, CA

±8,393 SF AVAILABLE FOR OWNER/USER



*Minimum 3-Year Deal

CHAD COOK, MCR, SIOR, CCIM

Senior Director

chad.cook@cushwake.com

+1 916 329 1562

Lic #01711687

ZACH MOSLE, CCIM

Director

zach.mosle@cushwake.com

+1 916 329 1543

Lic #01924595

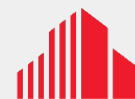

**CUSHMAN &
WAKEFIELD**

FOR SALE

2260 Del Paso Road

Sacramento, CA

SALES PRICE: \$3,250,000

PROPERTY HIGHLIGHTS

- ±8,393 SF available for sale
- Excellent visibility, building top signage available
- Ideal location at the intersection of Truxel Road and Del Paso Road
- Close proximity to retail amenities / restaurants
- Directly across the street from Raley's Center
- Desirable new construction and attractive landscaping
- Immediate access to Interstate 80 and Interstate 5
- Anchor tenants include Lyon Real Estate, Guild Mortgage, Realty ONE Group, Placer Title Company, Suncrest Health Services



CHAD COOK, MCR, SIOR, CCIM

Senior Director

chad.cook@cushwake.com

+1 916 329 1562

Lic #01711687

ZACH MOSLE, CCIM

Director

zach.mosle@cushwake.com

+1 916 329 1543

Lic #01924595



**CUSHMAN &
WAKEFIELD**

FOR SALE

2260 Del Paso Road

Sacramento, CA

Full Building Layout

±8,393 SF

Suite 150
±2,721 SF

Suite 100
±5,672 SF

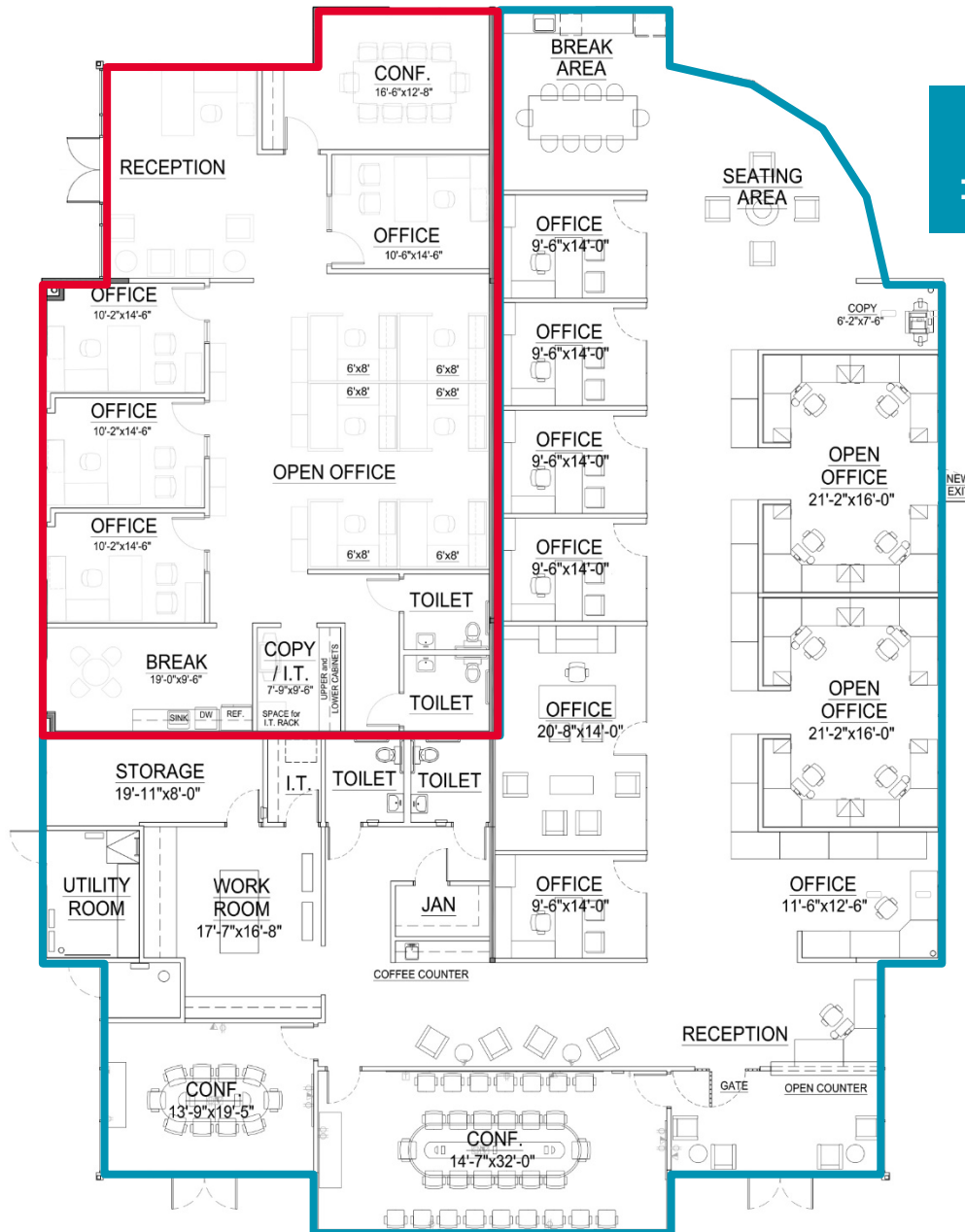

CHAD COOK, MCR, SIOR, CCIM

Senior Director

chad.cook@cushwake.com

+1 916 329 1562

Lic #01711687

ZACH MOSLE, CCIM

Director

zach.mosle@cushwake.com

+1 916 329 1543

Lic #01924595

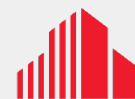

**CUSHMAN &
WAKEFIELD**

FOR SALE

2260 Del Paso Road

Sacramento, CA

PHOTOS



CHAD COOK, MCR, SIOR, CCIM

Senior Director

chad.cook@cushwake.com

+1 916 329 1562

Lic #01711687

ZACH MOSLE, CCIM

Director

zach.mosle@cushwake.com

+1 916 329 1543

Lic #01924595



FOR SALE

2260 Del Paso Road

Sacramento, CA

Retail Trade Area Aerial



• PARKS •

- 1) North Natomas Regional Park
- 2) North Natomas Aquatic Complex
- 3) Airfield Park
- 4) Linden Park
- 5) Quail Park

• FOOD •

- 1) Peet's Coffee & tea
- 2) Jack's Urban Eats
- 3) Jamba Juice
- 4) Bonchon
- 5) Round Table Pizza
- 6) Panera Bread
- 7) Jack in the Box
- 8) Chipotle
- 9) Jersey Mike's
- 10) Pete's Restaurant and Brewhouse
- 11) Carl's Jr.
- 12) Dickey's BBQ Pit
- 13) Wendy's
- 14) Starbucks
- 15) In-N-Out
- 16) Sizzler
- 17) Panda Express
- 18) KFC
- 19) Taco Bell
- 20) IHOP
- 21) Wienerschnitzel

POINTS OF INTEREST

CENTENE REGIONAL HEADQUARTERS • NEW COSTCO • FUTURE SITE OF CALIFORNIA NORTHSTATE UNIVERSITY TEACHING HOSPITAL • DOWNTOWN SACRAMENTO • SMF • SPINE BIKE TRAIL • I-5 AND I-80 • NATOMAS AQUATICS CENTER

• HOTELS •

- 1) Homewood Suites by Hilton
- 2) Hampton Inn & Suites
- 3) Holiday Inn Express & Suites
- 4) Hilton Garden Inn
- 5) Hyatt House
- 6) Four Points
- 7) TownePlace Suites
- 8) Wyndham Garden

• BANKS •

- 1) Wells Fargo
- 2) Tri Counties Bank
- 3) Bank of America
- 4) Safe Credit Union
- 5) Five Star Bank

• GAS STATIONS •

- 1) Shell
- 2) Chevron
- 3) Safeway

• HEALTH & WELLNESS •

- 1) Planet Fitness
- 2) 9Round Kickboxing Fitness
- 3) Club Pilates

• SCHOOLS •

- 1) Inderkum High School
- 2) American River College
- Natomas Center
- 3) Natomas School of Music
- 4) Westlake Charter High School
- 5) Universal Technical Institute
- 6) Natomas Charter School Star Academy

• OTHER •

- 1) Raley's
- 2) Safeway
- 3) Kohl's
- 4) Marshalls
- 5) Rite Aid

FOR SALE

2260 Del Paso Road

Sacramento, CA

LOCATION MAP



±79,000

skilled tech & life science
employees in Greater Sacramento

5%

POPULATION GROWTH
in the next 5 years

34.8%

FUTURE JOB GROWTH
predicted over the next 10 years

2.2 M

CURRENT POPULATION
current population in 2023

©2024 Cushman & Wakefield. All rights reserved. The information contained in this communication is strictly confidential. This information has been obtained from sources believed to be reliable but has not been verified. No warranty or representation, express or implied, is made as to the condition of the property (or properties) referenced herein or as to the accuracy or completeness of the information contained herein, and same is submitted subject to errors, omissions, change of price, rental or other conditions, withdrawal without notice, and to any special listing conditions imposed by the property owner(s). Any projections, opinions or estimates are subject to uncertainty and do not signify current or future property performance.

CHAD COOK, MCR, SIOR, CCIM

Senior Director

chad.cook@cushwake.com

+1 916 329 1562

Lic #01711687

ZACH MOSLE, CCIM

Director

zach.mosle@cushwake.com

+1 916 329 1543

Lic #01924595

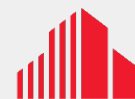

**CUSHMAN &
WAKEFIELD**