

FOR LEASE

2260 Del Paso Road

Sacramento, California

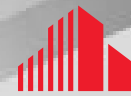

**CUSHMAN &
WAKEFIELD**

P R O F E S S I O N A L C E N T E R



Chad Cook, MCR, SIOR, CCIM

Senior Director

+1 916 329 1562

chad.cook@cushwake.com

Lic #01711687

Zach Mosle, CCIM

Director

+1 916 329 1543

zach.mosle@cushwake.com

Lic #01924595

400 Capitol Mall, Suite 1800

Sacramento, CA 95814

T +1 916 288 4800

cushmanwakefield.com

Cushman & Wakefield Copyright 2023. The information contained herein was lawfully obtained from sources we consider reliable. Cushman & Wakefield is not responsible and expressly disclaims all liability, for errors, omissions, prior sales, withdrawal from the market or change in price. Seller (or Lessor, as the case may be) and broker make no representation as to the environmental condition of the property and recommend Purchaser's (or Lessee's) independent investigation.

Property Highlights:

- ±2,721 SF available for lease
- New suite available: Suite 100, 5,672 SF
- Total contiguous space available as 8,393 SF
- Excellent visibility, building top signage available
- Ideal location at the intersection of Truxel Road and Del Paso Road
- Close proximity to retail amenities / restaurants
- Directly across the street from Raley's Center
- Desirable new construction and attractive landscaping
- Immediate access to Interstate 80 and Interstate 5
- Anchor tenants include: : Lyon Real Estate, Guild Mortgage, Realty ONE Group, Placer Title Company, Suncrest Health Services



SIGNAGE FACING DEL PASO ROAD

Chad Cook, MCR, SIOR, CCIM

Senior Director
 +1 916 329 1562
 chad.cook@cushwake.com
 Lic #01711687

Zach Mosle, CCIM

Director
 +1 916 329 1543
 zach.mosle@cushwake.com
 Lic #01924595

400 Capitol Mall, Suite 1800
 Sacramento, CA 95814
 T +1 916 288 4800
cushmanwakefield.com

Floor Plan:

Suite 150
±2,721 SF

Suite 100
±5,672 SF

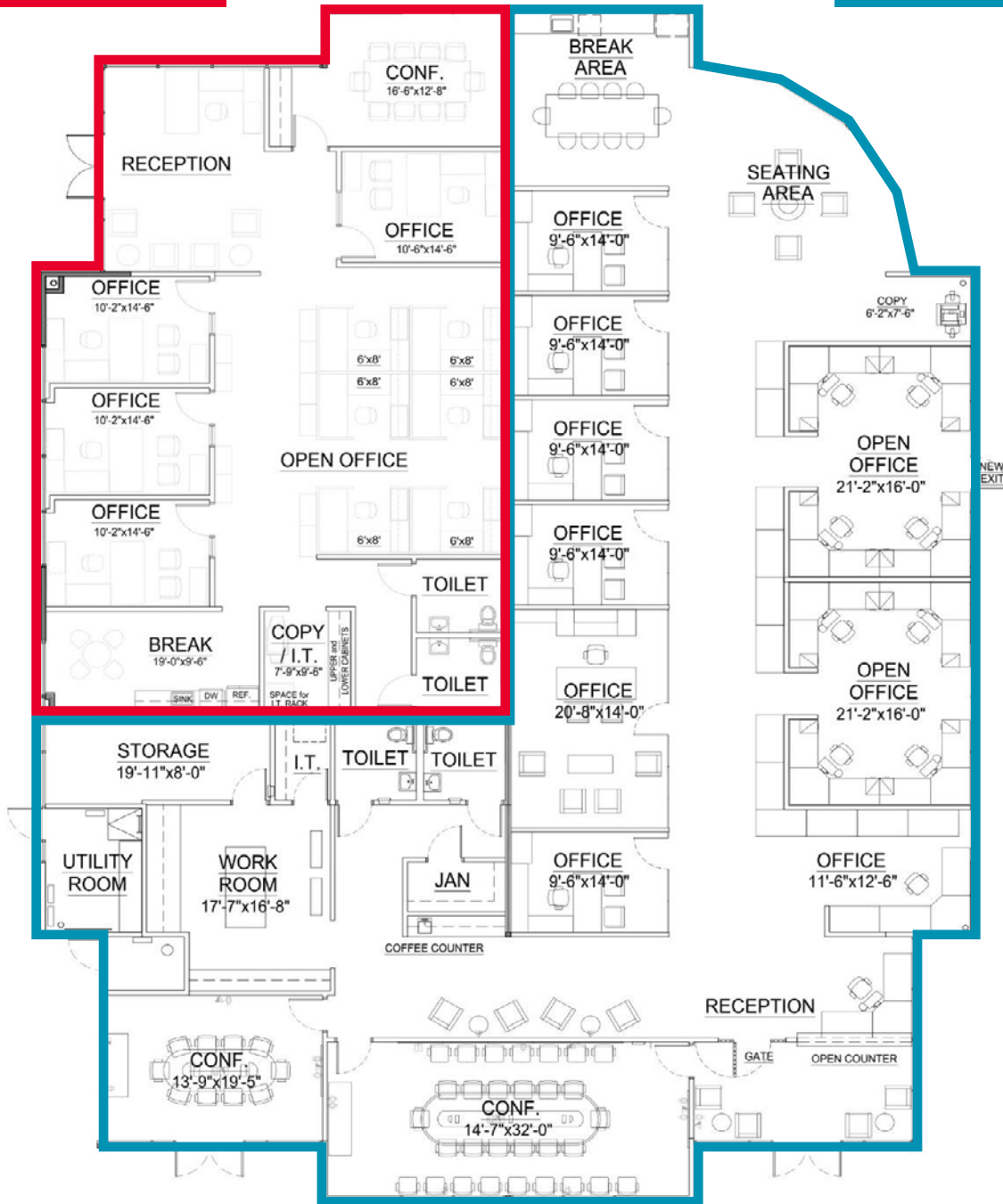

FLOOR PLAN

Chad Cook, MCR, SIOR, CCIM
Senior Director
+1 916 329 1562
chad.cook@cushwake.com
Lic #01711687

Zach Mosle, CCIM
Director
+1 916 329 1543
zach.mosle@cushwake.com
Lic #01924595

400 Capitol Mall, Suite 1800
Sacramento, CA 95814
T +1 916 288 4800
cushmanwakefield.com

Retail Trade Area Aerial



• PARKS •

- 1) North Natomas Regional Park
- 2) North Natomas Aquatic Complex
- 3) Airfield Park
- 4) Linden Park
- 5) Quail Park

• FOOD •

- 1) Peet's Coffee & tea
- 2) Jack's Urban Eats
- 3) Jamba Juice
- 4) Bonchon
- 5) Round Table Pizza
- 6) Panera Bread
- 7) Jack in the Box
- 8) Chipotle
- 9) Jersey Mike's
- 10) Pete's Restaurant and Brewhouse
- 11) Carl's Jr.
- 12) Dickey's BBQ Pit
- 13) Wendy's
- 14) Starbucks
- 15) In-N-Out
- 16) Sizzler
- 17) Panda Express
- 18) KFC
- 19) Taco Bell
- 20) IHOP
- 21) Wienerschnitzel

POINTS OF INTEREST

CENTENE REGIONAL HEADQUARTERS • NEW COSTCO • FUTURE SITE OF CALIFORNIA NORTHSTATE UNIVERSITY TEACHING HOSPITAL • DOWNTOWN SACRAMENTO • SMF • SPINE BIKE TRAIL • I-5 AND I-80 • NATOMAS AQUATICS CENTER

• HOTELS •

- 1) Homewood Suites by Hilton
- 2) Hampton Inn & Suites
- 3) Holiday Inn Express & Suites
- 4) Hilton Garden Inn
- 5) Hyatt House
- 6) Four Points
- 7) TownePlace Suites
- 8) Wyndham Garden

• BANKS •

- 1) Wells Fargo
- 2) Tri Counties Bank
- 3) Bank of America
- 4) Safe Credit Union
- 5) Five Star Bank

• GAS STATIONS •

- 1) Shell
- 2) Chevron
- 3) Safeway

• HEALTH & WELLNESS •

- 1) Planet Fitness
- 2) 9Round Kickboxing Fitness
- 3) Club Pilates

• SCHOOLS •

- 1) Inderkum High School
- 2) American River College Natomas Center
- 3) Natomas School of Music
- 4) Westlake Charter High School
- 5) Universal Technical Institute
- 6) Natomas Charter School Star Academy

• OTHER •

- 1) Raley's
- 2) Safeway
- 3) Kohl's
- 4) Marshalls
- 5) Rite Aid

Aerial: Centerpointe At Natomas Crossing



AERIAL

Chad Cook, MCR, SIOR, CCIM
Senior Director
+1 916 329 1562
chad.cook@cushwake.com
Lic #01711687

Zach Mosle, CCIM
Director
+1 916 329 1543
zach.mosle@cushwake.com
Lic #01924595

400 Capitol Mall, Suite 1800
Sacramento, CA 95814
T +1 916 288 4800
cushmanwakefield.com