

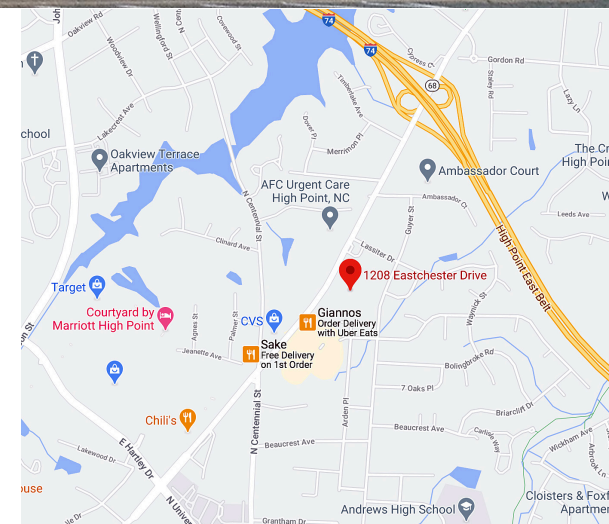

Property Highlights

- Located on Highway 68 (Eastchester Drive) between I-74 / 311 and Centennial Drive
- Minutes from downtown High Point
- 10 minutes from I-40
- 15 minutes to Piedmont Triad International Airport
- 20 minutes to downtown Greensboro and Winston-Salem
- 57,000 SF of Class A Office Space
- Two-story extension brick design with full reflective glass on the first floor
- Interior tropical atrium including a water garden and skylights
- Elegant marble floors throughout the first floor common area
- Abundant surface parking
- 24-hour access via electronic card key system
- On-site maintenance



Ryan Gioffre

Director
+1 336 821 3822
ryan.gioffre@cushwake.com

Seth Constable

Associate
+1 336 885 7815
seth.constable@cushwake.com

628 Green Valley Road, Ste. 202
Greensboro, NC 27408
Main +1 336 668 9999
Fax +1 336 668 0888
cushmanwakefield.com



1208 Eastchester Drive - The Arboretum

High Point, NC 27265



Ryan Gioffre
Director
+1 336 821 3822
ryan.gioffre@cushwake.com

Seth Constable
Associate
+1 336 885 7815
seth.constable@cushwake.com

628 Green Valley Road, Ste. 202
Greensboro, NC 27408
Main +1 336 668 9999
Fax +1 336 668 0888
cushmanwakefield.com

1st Floor Availability: Total of +/- 11,253 SF



Ryan Gioffre
Director
+1 336 821 3822
ryan.gioffre@cushwake.com

Seth Constable
Associate
+1 336 885 7815
seth.constable@cushwake.com

628 Green Valley Road, Ste. 202
Greensboro, NC 27408
Main +1 336 668 9999
Fax +1 336 668 0888
cushmanwakefield.com

2nd Floor Availability: Total of +/- 5,618 SF

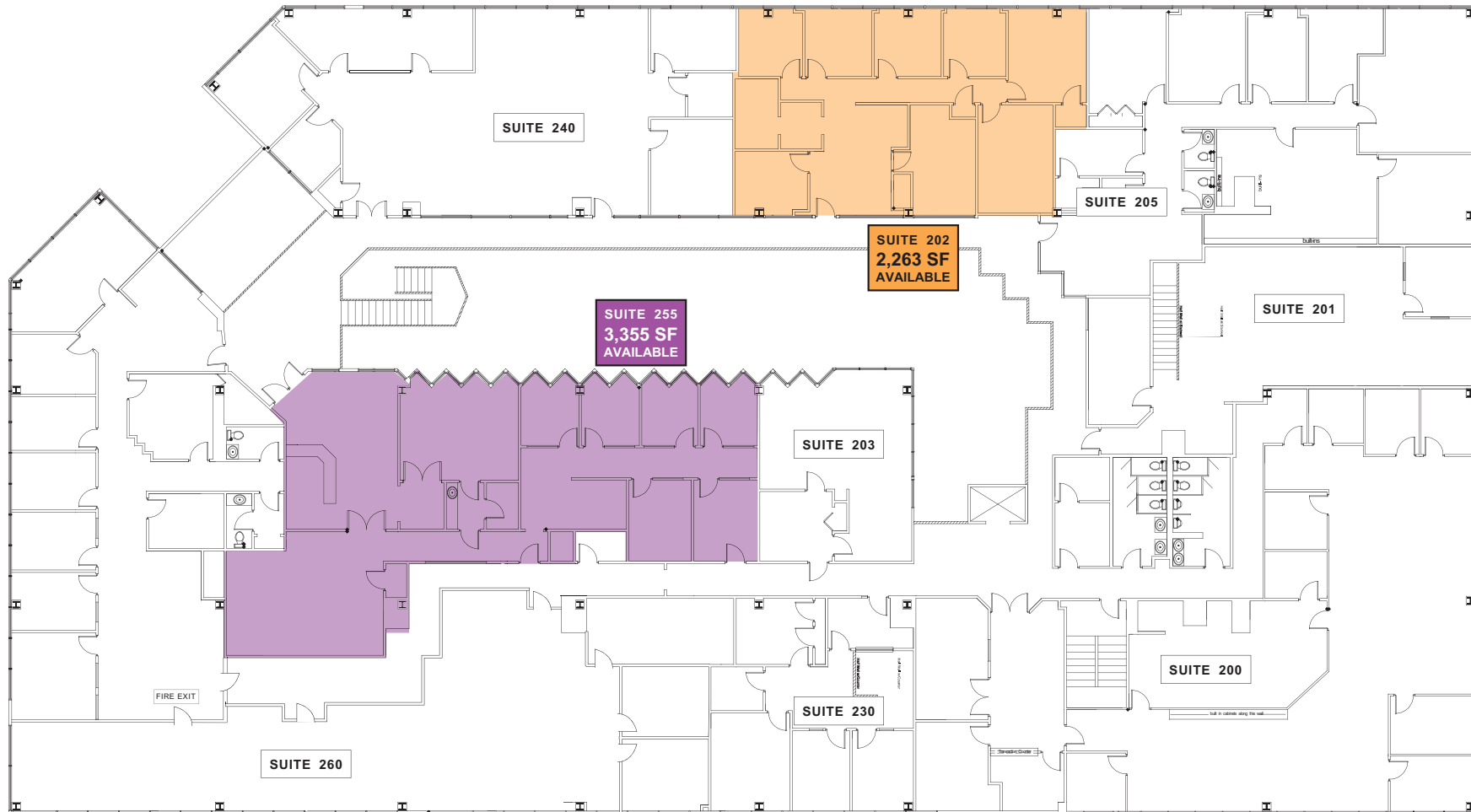

Ryan Gioffre

Director

+1 336 821 3822

ryan.gioffre@cushwake.com

Seth Constable

Associate

+1 336 885 7815

seth.constable@cushwake.com

628 Green Valley Road, Ste. 202

Greensboro, NC 27408

Main +1 336 668 9999

Fax +1 336 668 0888

cushmanwakefield.com