



**±6,809 SF to ±13,836 SF
AVAILABLE FOR LEASE**

TASMAN INDUSTRIAL CENTER

1147 - 1155 TASMAN DRIVE // SUNNYVALE



TASMAN INDUSTRIAL CENTER

AVAILABLE NOW:

1147 Tasman: ±6,809 SF

1153 Tasman: ±6,918 SF*

1155 Tasman: ±6,918 SF* - Available Sept 2024

**1153 & 1155 can be combined for ±13,836 SF*

BUILDING HIGHLIGHTS



**CENTRAL LOCATION AT
LAWRENCE EXPWY. & TASMAN DR.**



COMCAST AVAILABLE



**GRADE LEVEL DOOR IN
EACH SPACE**



±2.76/1,000 PARKING



**EASY ACCESS TO MAJOR
HIGHWAYS 237, 101 AND 880**



LIGHT RAIL ACCESSIBLE



**WALKING DISTANCE
TO RESTAURANTS**

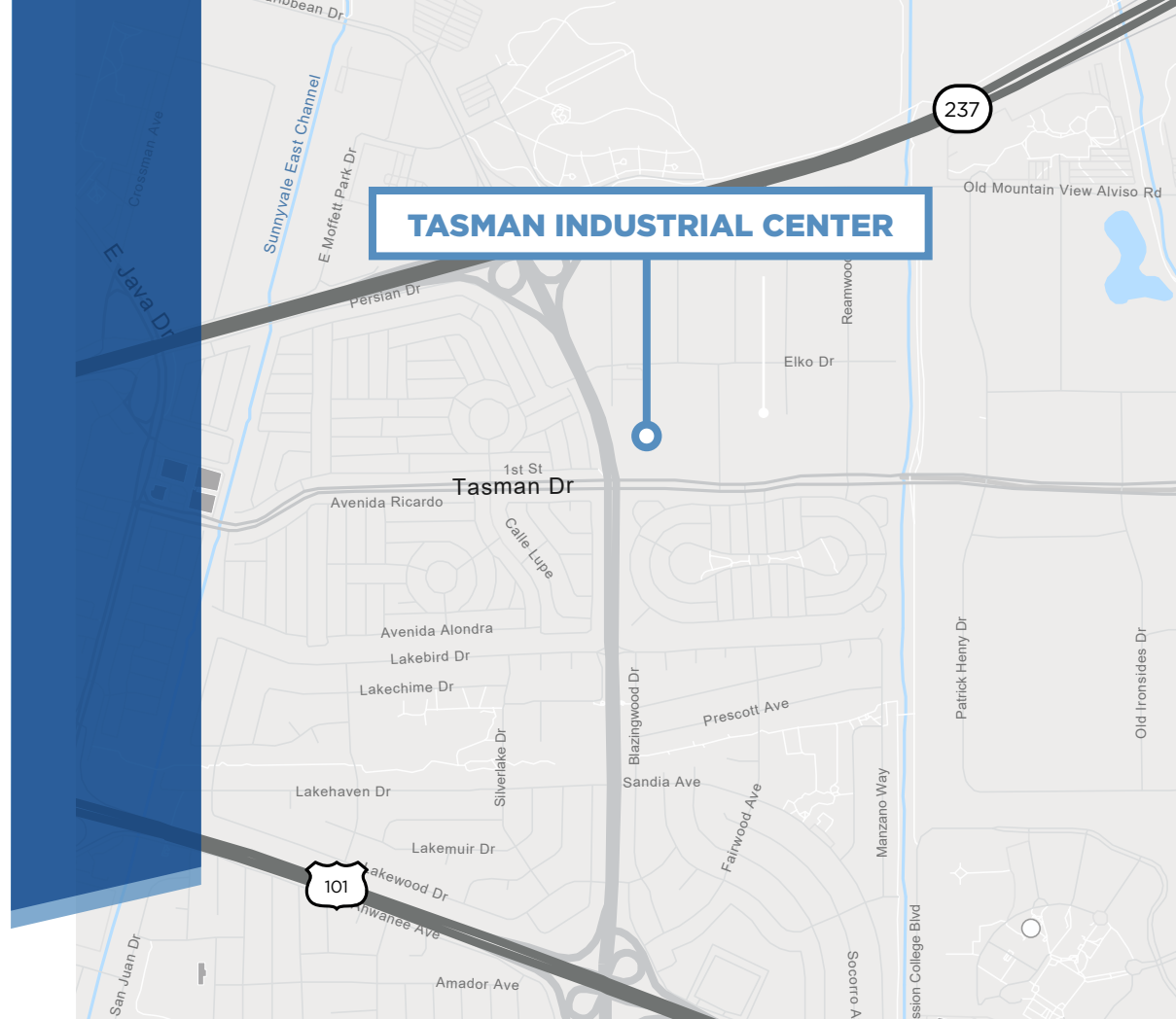

TASMAN INDUSTRIAL CENTER

TASMAN INDUSTRIAL CENTER

1147 TASMAN: ±6,809 SF - AVAILABLE NOW

- 300 AMPS AT 120/208V
- 2 OFFICES
- 1 CONFERENCE ROOM
- BREAK ROOM
- LAB/MANUFACTURING AREA (100% HVAC)
- SHIPPING/RECEIVING
- 1 GRADE LEVEL DOOR

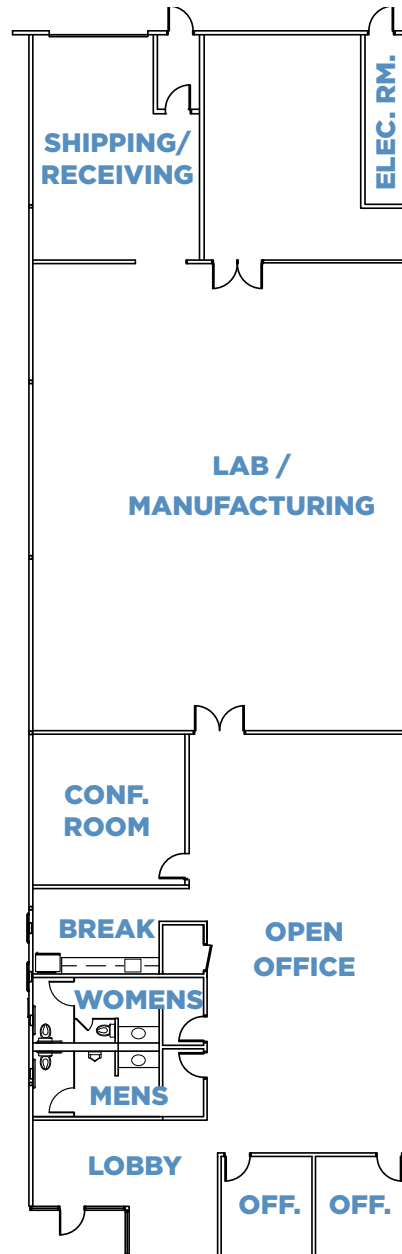

TASMAN INDUSTRIAL CENTER

TASMAN INDUSTRIAL CENTER

1153 & 1155 TASMAN: ±6,918 - ±13,836 SF

1153 TASMAN

±6,918 SF

Available Now

- 400 AMPS AT 120/208V
- 2 OFFICES
- 1 CONFERENCE ROOM
- BREAK ROOM
- WAREHOUSE AREA (100% HVAC)

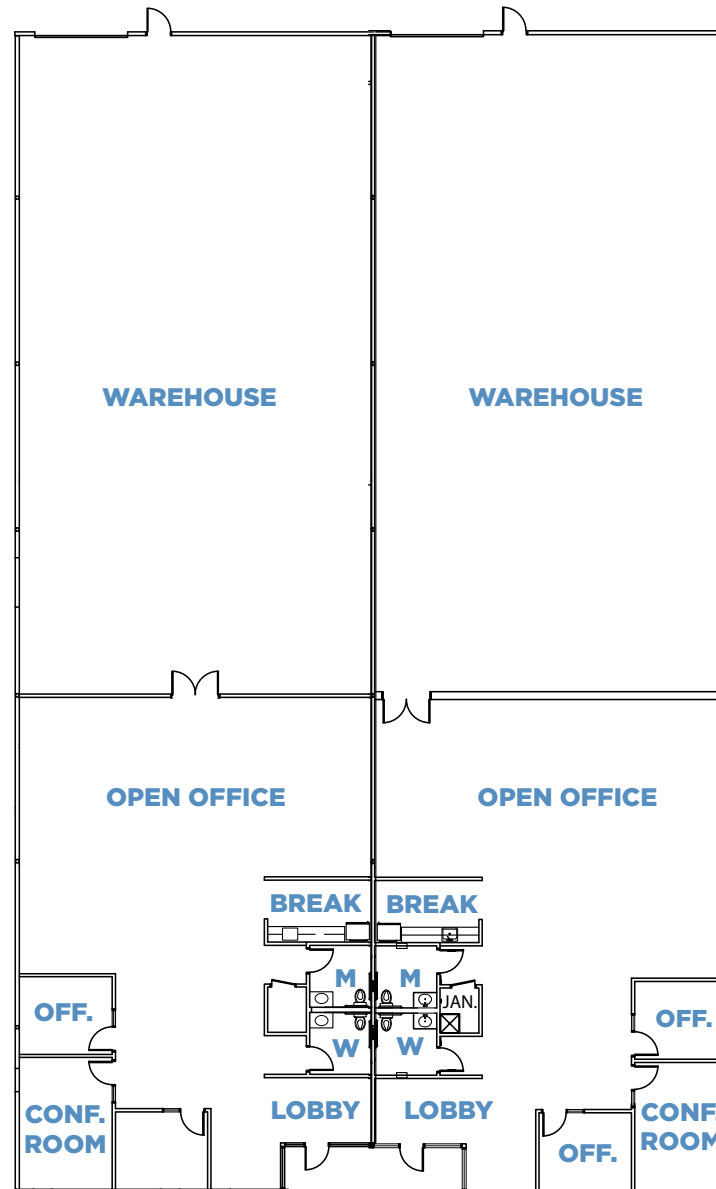

1155 TASMAN

±6,918 SF

Available Sept. 2024

- 300 AMPS AT 120/208V (EXPANDABLE TO 400 AMPS)
- 2 OFFICES
- 1 CONFERENCE ROOM
- BREAK ROOM
- WAREHOUSE AREA

TASMAN INDUSTRIAL CENTER

AMENITIES & TRANSPORTATION



TASMAN INDUSTRIAL CENTER

1147 - 1155 TASMAN DRIVE // SUNNYVALE

±6,809 to ±13,836 SF

AVAILABLE FOR LEASE

Nick Lazzarini

408.615.3410
nick.lazzarini@cushwake.com
LIC #01788935

Clark Steele

408.436.3653
clark.steele@cushwake.com
LIC #01995379

Jacob Bider

408.572.4138
jacob.bider@cushwake.com
LIC #02110355

SOUTH BAY
DEVELOPMENT CO.

