

4,000 SF FOR SUBLEASE WITH FENCED YARD

9270 CLAIREMONT MESA BLVD
SAN DIEGO, CA 92123



RYAN DOWNING, SIOR

direct: 858.546.5416

mobile: 760.840.1164

ryan.downing@cushwake.com

CA Lic. 01955032



12830 El Camino Real, Suite 100 | San Diego, CA 92130
858.452.6500 | 858.630.6320 | cushmanwakefield.com



PROPERTY HIGHLIGHTS:

- Fenced Yard
- 100% HVAC
- New Roof
- Zoning: CC-3-9
- Asking Rate: \$10,500/month NNN
- Sublease Expiration: 11/30/2026
- Available Now



4,000 SQ FT

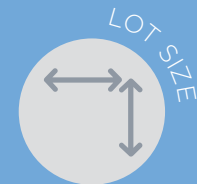

21,222 SF



TWO (2) GRADE

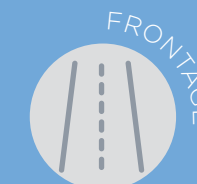

CLAIREMONT MESA BLVD



KEARNY MESA

**9270 CLAIREMONT MESA BLVD
SAN DIEGO, CA 92123**

FEATURES

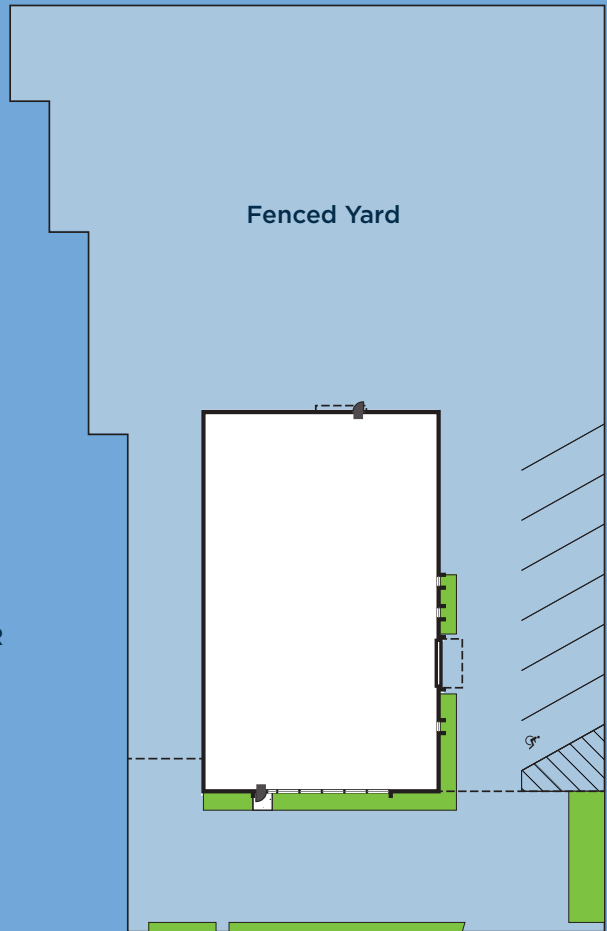
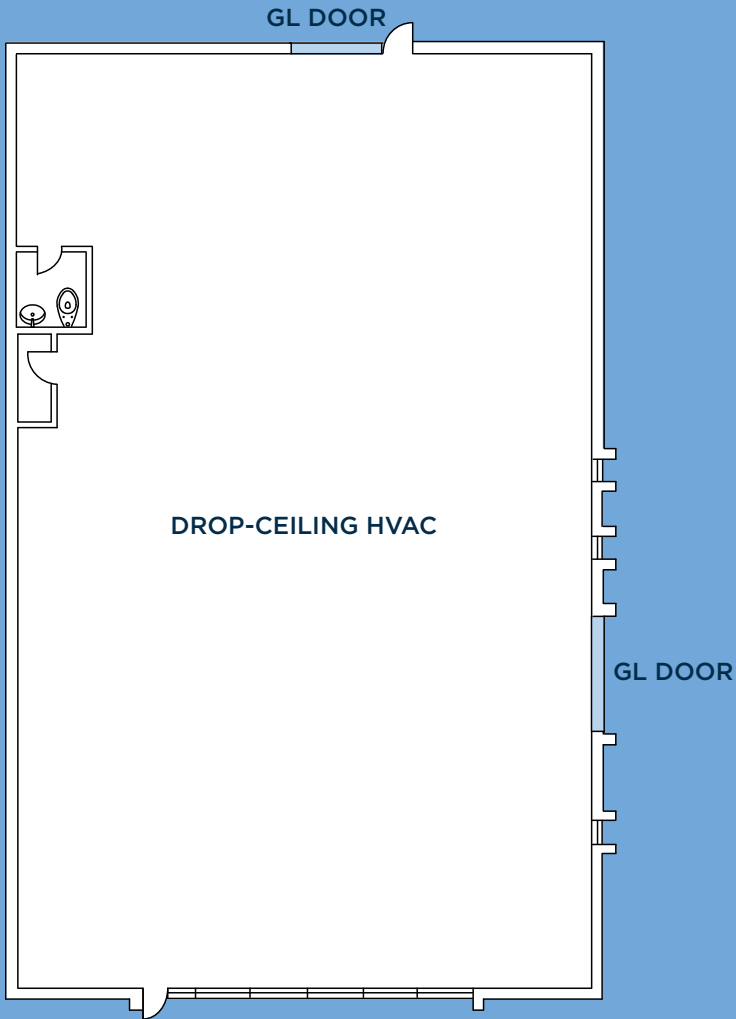

RENTABLE AREA
4,000 SQ FT

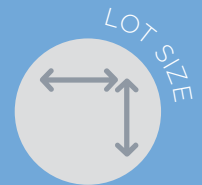

LOT SIZE
21,222 SF



LOADING
TWO (2) GRADE

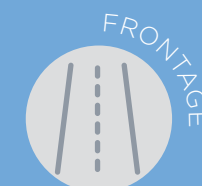

FRONTAGE
CLAIREMONT MESA BLVD



SUBMARKET
KEARNY MESA

9270 CLAIREMONT MESA BLVD
SAN DIEGO, CA 92123

AVAILABILITY



9270 CLAIREMONT MESA BLVD
SAN DIEGO, CA 92123

LOCATION



RYAN DOWNING, SIOR

direct: 858.546.5416

mobile: 760.840.1164

ryan.downing@cushwake.com

CA Lic. 01955032



12830 El Camino Real, Suite 100 | San Diego, CA 92130
858.452.6500 | 858.630.6320 | cushmanwakefield.com

©Cushman & Wakefield. All rights reserved. This information has been obtained from sources believed to be reliable but has not been verified. NO WARRANTY OR REPRESENTATION, EXPRESS OR IMPLIED, IS MADE AS TO THE CONDITION OF THE PROPERTY (OR PROPERTIES) REFERENCED HEREIN OR AS TO THE ACCURACY OR COMPLETENESS OF THE INFORMATION CONTAINED HEREIN, AND SAME IS SUBMITTED SUBJECT TO ERRORS, OMISSIONS, CHANGE OF PRICE, RENTAL OR OTHER CONDITIONS, WITHDRAWAL WITHOUT NOTICE, AND TO ANY SPECIAL LISTING CONDITIONS IMPOSED BY THE PROPERTY OWNER(S).