



± 60,000 SF
AVAILABLE FOR SALE OR FOR LEASE

3100-3150 COMMERCIAL AVE

Northbrook, IL



PROPERTY OVERVIEW

3100-3150
COMMERCIAL AVE

PROPERTY FEATURES

Available Space:	± 60,000 SF	Interior Docks:	5
Land Area:	2.65 Acres	Drive-in Door:	1
Office Space:	± 30,000 SF	Power (2 Services):	800A @ 277/480v
Clear Height:	18'	Heating:	Gas Fired Units
Construction:	Reinforced Concrete	Sprinklers:	Wet
Year Built:	1977	Parking:	± 115 Cars
Zoning:	I-1	RE Taxes (2021 Paid in 2022):	\$2.88 PSF (\$172,653)

Sale Price: **STO**

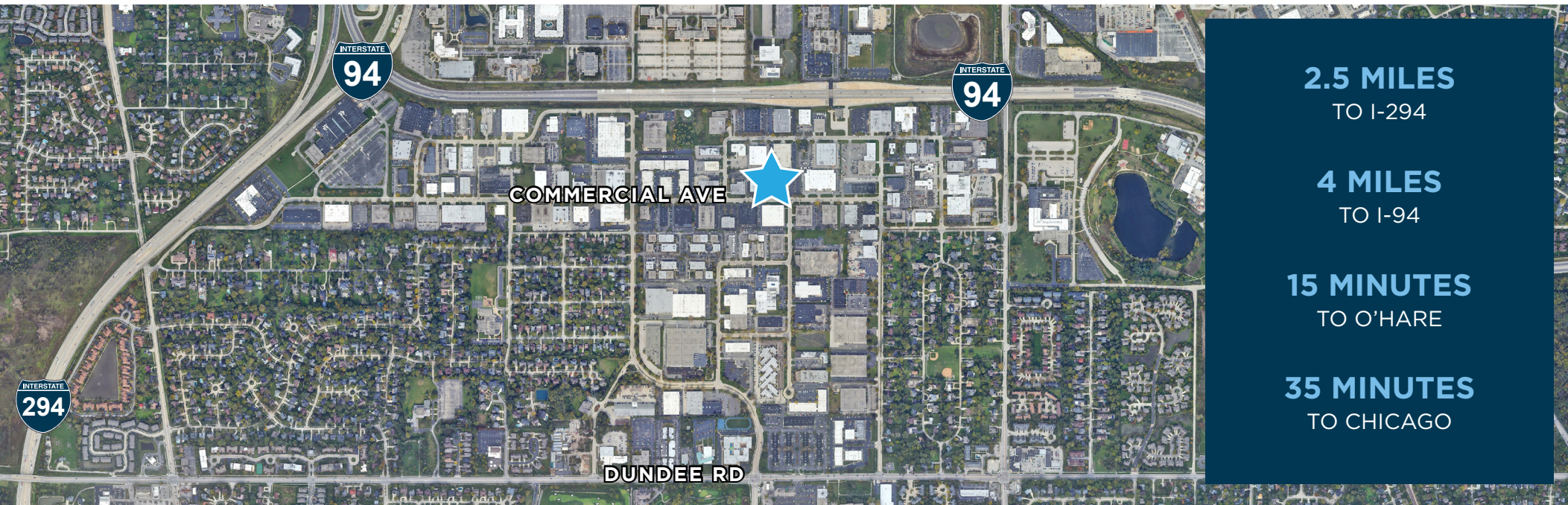

2.5 MILES
TO I-294

4 MILES
TO I-94

15 MINUTES
TO O'HARE

35 MINUTES
TO CHICAGO

FLOOR PLAN

± 60,000 SF AVAILABLE

± 20,000 SF OFFICE

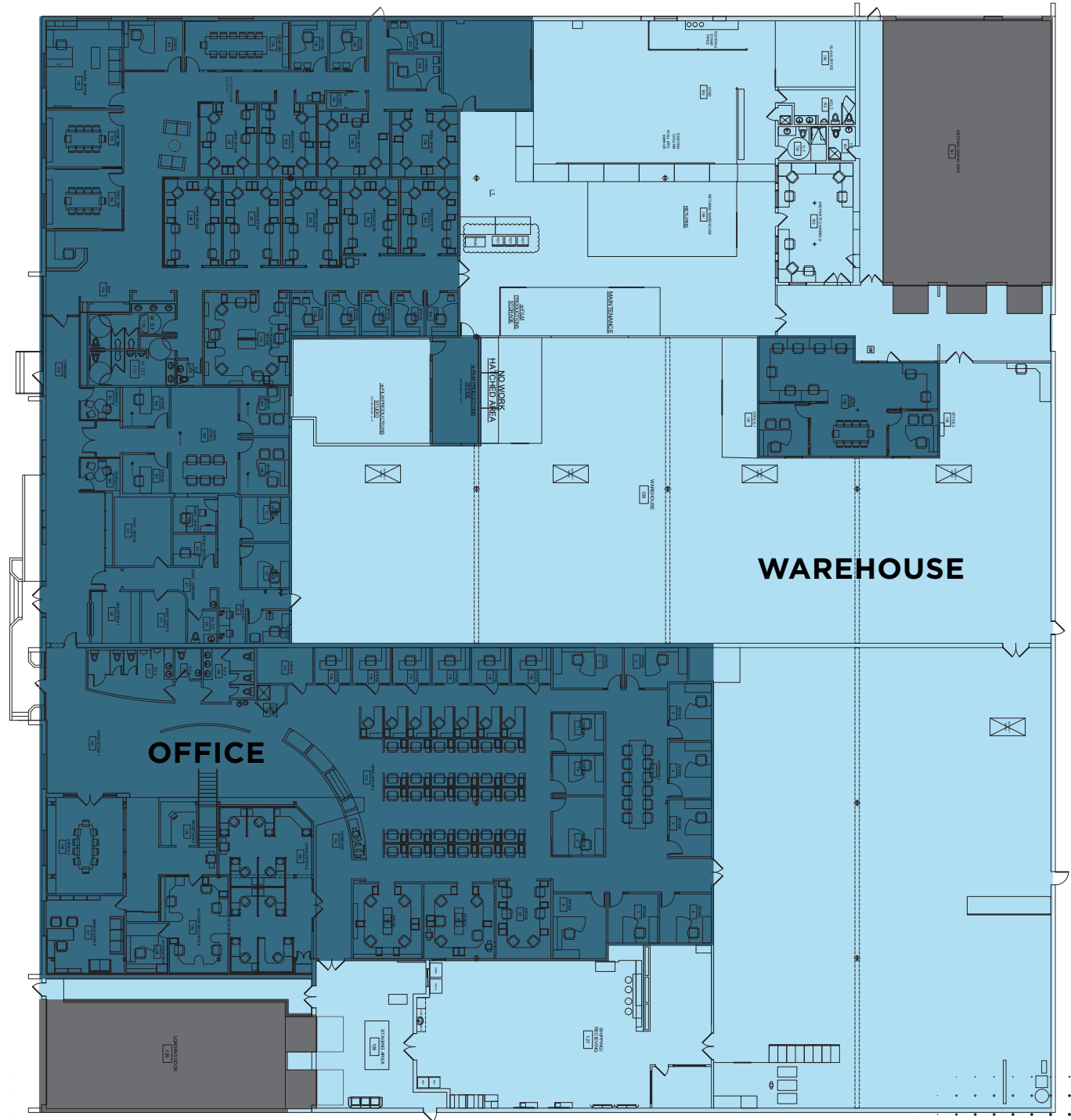



STEVE STONE
Managing Director
+ 1 847 720 1364
steve.stone@cushwake.com

DAVID FRIEDLAND
Executive Director
+1 847 720 1370
david.friedland@cushwake.com



©2023 CUSHMAN & WAKEFIELD. ALL RIGHTS RESERVED. THE INFORMATION CONTAINED IN THIS COMMUNICATION IS STRICTLY CONFIDENTIAL. THIS INFORMATION HAS BEEN OBTAINED FROM SOURCES BELIEVED TO BE RELIABLE BUT HAS NOT BEEN VERIFIED. NO WARRANTY OR REPRESENTATION, EXPRESS OR IMPLIED, IS MADE AS TO THE CONDITION OF THE PROPERTY (OR PROPERTIES) REFERENCED HEREIN OR AS TO THE ACCURACY OR COMPLETENESS OF THE INFORMATION CONTAINED HEREIN, AND SAME IS SUBMITTED SUBJECT TO ERRORS, OMISSIONS, CHANGE OF PRICE, RENTAL OR OTHER CONDITIONS, WITHDRAWAL WITHOUT NOTICE, AND TO ANY SPECIAL LISTING CONDITIONS IMPOSED BY THE PROPERTY OWNER(S). ANY PROJECTIONS, OPINIONS OR ESTIMATES ARE SUBJECT TO UNCERTAINTY AND DO NOT SIGNIFY CURRENT OR FUTURE PROPERTY PERFORMANCE.