

# GULF COAST INDUSTRIAL

16120-16190 LEE RD.  
FORT MYERS, FL 33912

FOR LEASE





# Property Summary

For Lease

## Property Overview

|                   |  |
|-------------------|--|
| ADDRESS           | 16120-16190 Lee Rd<br>Fort Myers, FL 33912 |
| LEASE RATE        | \$17.50-19.00 NNN                          |
| CAM               | \$5.66                                     |
| SUBMARKET         | S Fort Myers / San Carlos                  |
| NNN LEASABLE AREA | 294,011 SF                                 |
| AVAILABLE UNITS   | 6  |
| YEAR BUILT        | 2018/2020                                  |
| Buildings         | 8  |
| ZONING            | IPD  |
| PROPERTY TYPE     | Industrial                                 |

## Property Highlights

- Newly constructed in 2020
- Metal frame with concrete construction
- Units come with fenced in yards
- 16'x16' overhead doors rated to withstand 160 mph winds
- 3-phase power
- 24' clear heights
- Property benefits from heavy industrial zoning
- All units sprinkled
- Above average parking ratio



# AVAILABLE UNITS



**ROLL-UP  
DOORS**  
16'x16'



**POWER**  
3-phase



**SPRINKLER**  
Yes

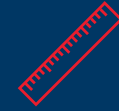

**CLEAR HEIGHT**  
18-20'

## Building 16120

### Leasing Rate

| Building      | Unit Size | Rate / SF | CAM    | Monthly Total* |
|---------------|-----------|-----------|--------|----------------|
| 16120-180/190 | 8,960 SF  | \$18.50   | \$5.66 | \$18,039.47    |
| 16120-180     | 4,480 SF  | \$19.00   | \$5.66 | \$9,206.40     |
| 16120-190     | 4,480 SF  | \$19.00   | \$5.66 | \$9,206.40     |

\*Less taxes

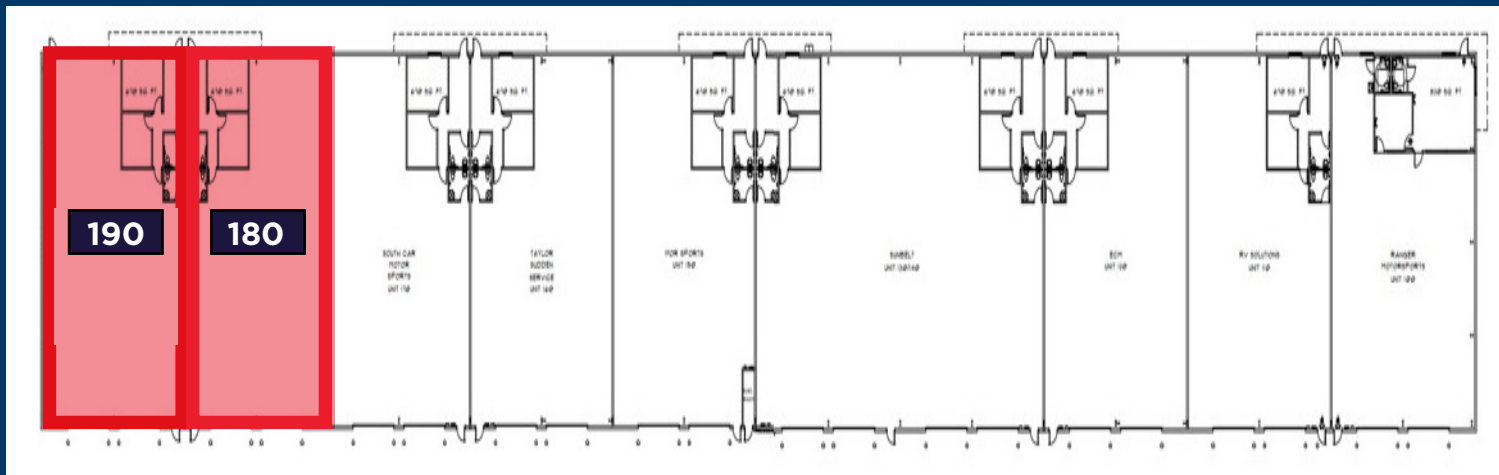

# AVAILABLE UNITS



**ROLL-UP  
DOORS**  
16'x16'



**POWER**  
3-phase



**SPRINKLER**  
Yes

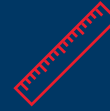

**CLEAR HEIGHT**  
18-20'

“ WE DIDN'T  
COME THIS FAR,  
JUST TO COME  
THIS FAR. ”

## Building 16130

### Leasing Rate

| Building  | Unit Size | Rate / SF | CAM    | Monthly Total* |
|-----------|-----------|-----------|--------|----------------|
| 16130-125 | 6,665 SF  | \$18.50   | \$5.66 | \$13,418.87    |
| 16130-130 | 4,480 SF  | \$19.00   | \$5.66 | \$9,206.40     |

\*Less taxes

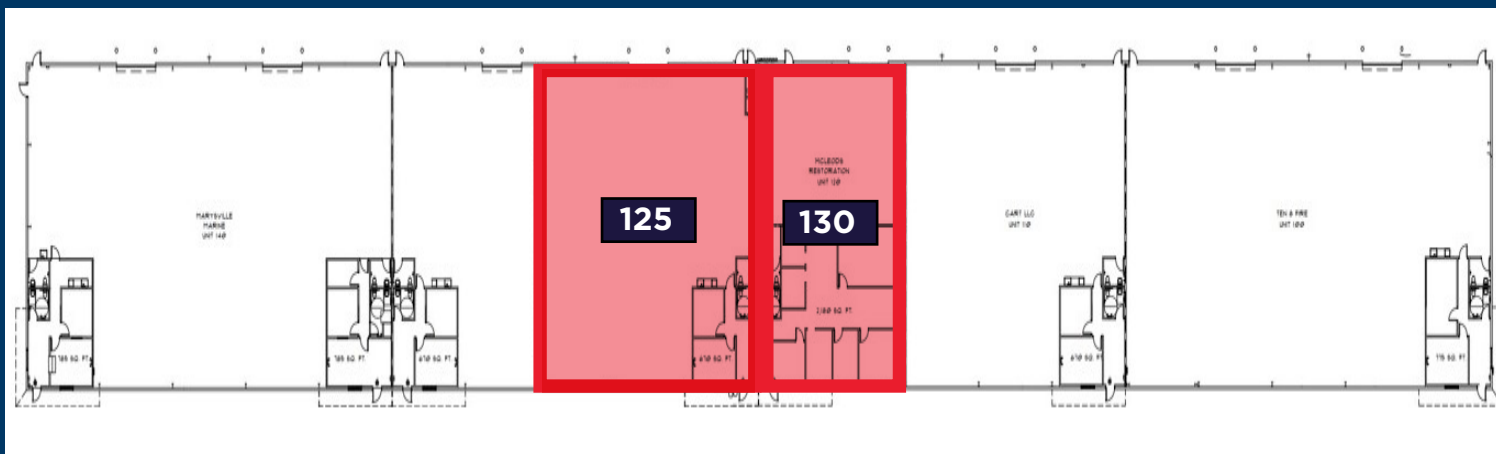

# AVAILABLE UNITS



**ROLL-UP  
DOORS**  
16'x16'



**POWER**  
3-phase



**SPRINKLER**  
Yes

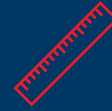

**CLEAR HEIGHT**  
18-20'

“ WE DIDN'T  
COME THIS FAR,  
JUST TO COME  
THIS FAR. ”

## Building 16140

### Leasing Rate

| Building  | Unit Size | Rate / SF | CAM    | Monthly Total* |
|-----------|-----------|-----------|--------|----------------|
| 16140-100 | 13,440 SF | \$17.50   | \$5.66 | \$25,939.20    |

\*Less taxes

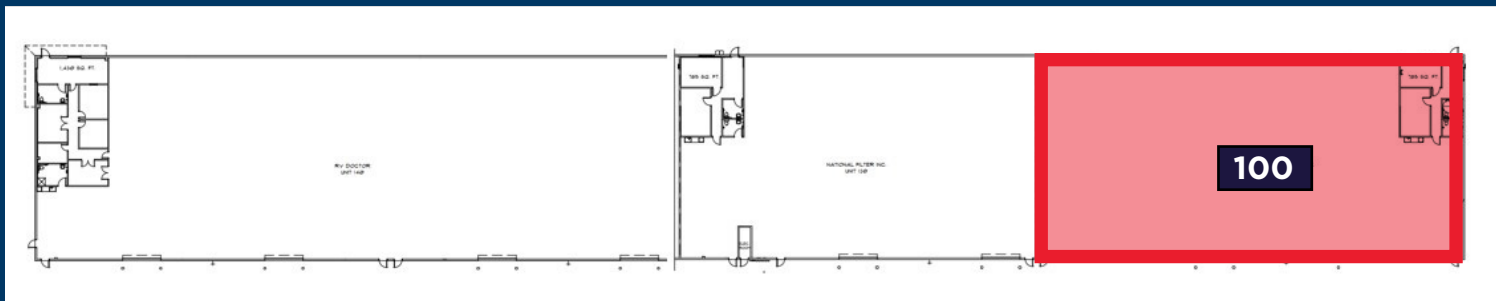

# AVAILABLE UNITS



**ROLL-UP  
DOORS**  
16'x16'



**POWER**  
3-phase



**SPRINKLER**  
Yes

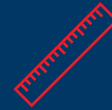

**CLEAR HEIGHT**  
18-20'

“ WE DIDN'T  
COME THIS FAR,  
JUST TO COME  
THIS FAR. ”

## Building 16190

### Leasing Rate

| Building  | Unit Size | Rate / SF | CAM    | Monthly Total* |
|-----------|-----------|-----------|--------|----------------|
| 16190-110 | 6,665 SF  | \$18.50   | \$5.66 | \$13,418.87    |

\*Less taxes

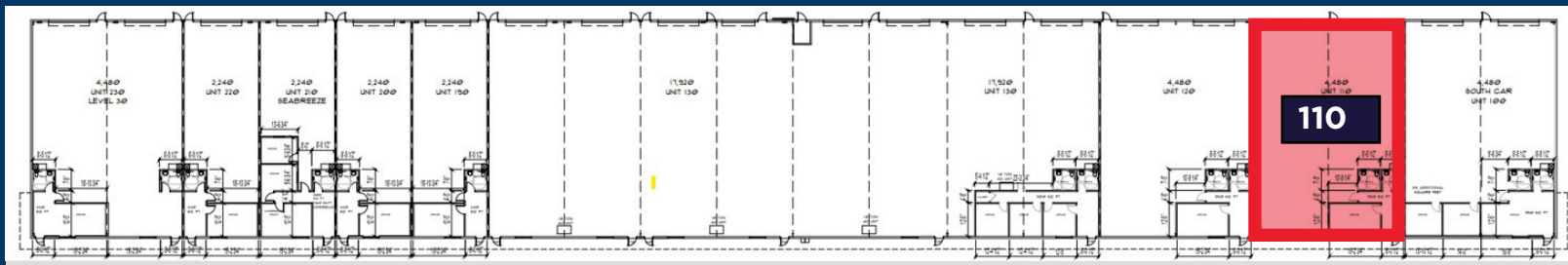



Cushman & Wakefield | Commercial property Southwest Florida Copyright January 16, 2025 2:37 PM. No warranty or representation, express or implied, is made to the accuracy or completeness of the information contained herein, and same is submitted subject to errors, omissions, change of price, rental or other conditions, withdrawal without notice, and to any special listing conditions imposed by the property owner(s). As applicable, we make no representation as to the condition of the property (or properties) in question.



# CONTACT

**GARY TASMAN**  
CEO, Principal Broker  
+1 239 489 3600  
gtasman@cpswfl.com

**SHAWN STONEBURNER**  
Senior Director  
+1 239 489 3600  
sstoneburner@cpswfl.com