



DOWNTOWN BOISE RETAIL & OFFICE SPACES



**CUSHMAN &
WAKEFIELD**

THE SONNA BUILDING

906-910 Main Street
Boise, Idaho 83702

241 TO 3,803 RSF

PROPERTY HIGHLIGHTS

Available	241 to 3,803 RSF
Lease Rate	See Pricing Details
Lease Type	FS - Office, NNN - Retail
Proposed Use	Retail and Office
Building Size	75,031 SF Total
T.I. Allowance	Negotiable
Parking	Surrounded by Metered Street Parking & Garages
Lock Box	No, Contact Agents



BREE WELLS
Director
Office | Capital Markets
+1 208 287 9492
bree.wells@cushwake.com

JENNIFER MCENTEE
Senior Director
Office | Capital Markets
+1 208 287 9495
jennifer.mcentee@cushwake.com

BRAYDON TORRES
Associate
Office | Capital Markets
+1 208 207 9485
braydon.torres@cushwake.com

999 W MAN ST. SUITE 1300, BOISE, IDAHO 83702
CUSHMANWAKEFIELD.COM

©2024 Cushman & Wakefield. All rights reserved. The information contained in this communication is strictly confidential. This information has been obtained from sources believed to be reliable but has not been verified. No warranty or representation, express or implied, is made as to the condition of the property (or properties) referenced herein or as to the accuracy or completeness of the information contained herein, and same is submitted subject to errors, omissions, change of price, rental or other conditions, withdrawal without notice, and to any special listing conditions imposed by the property owner(s). Any projections, opinions or estimates are subject to uncertainty and do not signify current or future property performance.



THE SONNA BUILDING

906-910 Main Street, Boise, Idaho 83702

241 TO 3,803 RSF FOR LEASE



AVAILABILITIES

SUITE NUMBER	SQUARE FOOTAGE	LEASE RATE
First Floor	2,500 - 3,803 RSF	\$18.00 NNN
Suite 206	241 RSF	\$399/Month - Full Service
Suite 210	479 RSF	\$19.00 Full Service
Suite 214	848 RSF	\$18.00 Full Service
Suite 222	876 RSF	\$18.00 Full Service
Suite 252	597 RSF	\$18.00 Full Service
Suite 258	1,563 RSF	\$18.00 Full Service
Suite 300	690 RSF	\$18.00 Full Service
Suite 306	425 RSF	\$18.00 Full Service
Suite 310	1,010 RSF	\$19.00 Full Service
Suite 314	682 RSF	\$19.00 Full Service
Suite 316	782 RSF	\$18.00 Full Service
Suite 322	266 RSF	\$399/Month - Full Service
Suite 340	869 RSF	\$19.00 Full Service
Suite 350	1,294 RSF	\$19.00 Full Service

THE SONNA BUILDING

906-910 Main Street, Boise, Idaho 83702

241 TO 3,803 RSF FOR LEASE



FIRST FLOOR LAYOUT & LISTING DETAILS

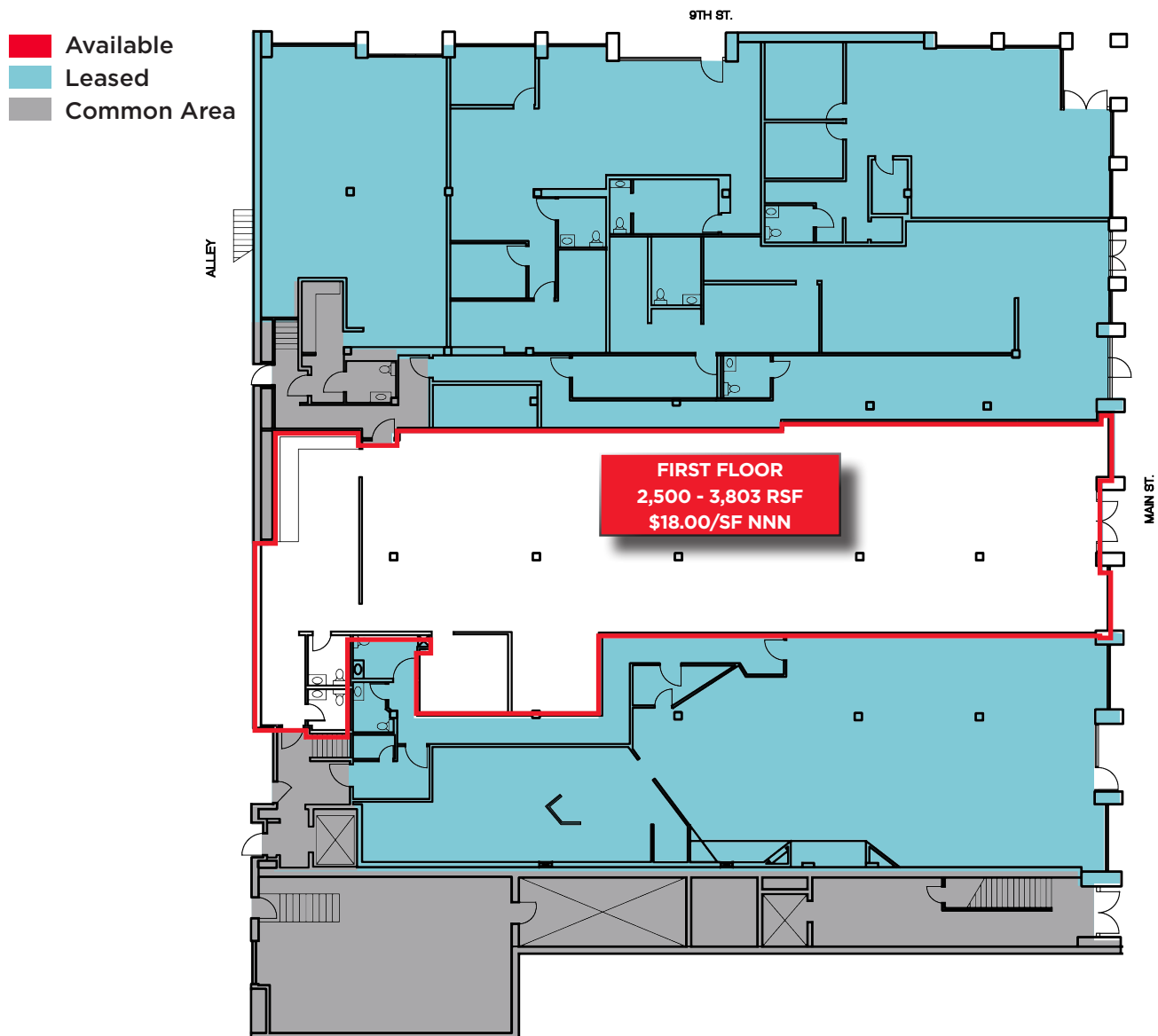

Listing Features

- Large first floor retail/office space with Main Street frontage consists of open sales floor area & restrooms
- Second & third floor office spaces consist of private offices and open work areas, lease type full service including janitorial
- Amenities include complimentary coffee and access to shared conference rooms, break rooms & rest rooms
- Elevator access provided for upper floors
- Large windows provide natural light throughout building
- Well known property surrounded by public parking
- Other tenants include Charles Schwab, ACLU, Matrix Engineering, Crandall Law & other professional services

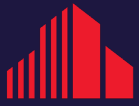

**CUSHMAN &
WAKEFIELD**

THE SONNA BUILDING

906-910 Main Street, Boise, Idaho 83702

241 TO 3,803 RSF FOR LEASE



SECOND FLOOR LAYOUT

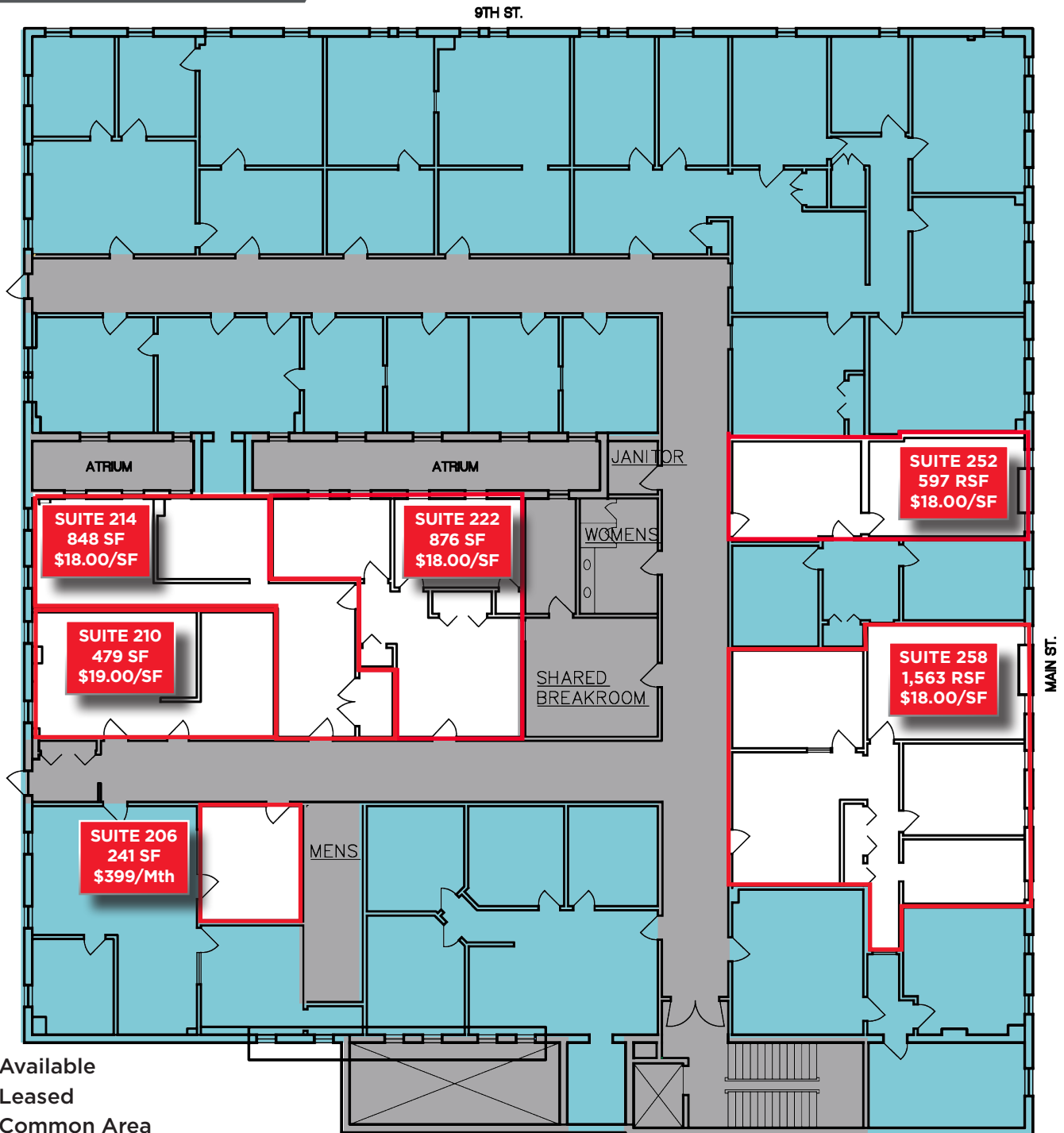

- Available
- Leased
- Common Area

©2024 Cushman & Wakefield. All rights reserved. The information contained in this communication is strictly confidential. This information has been obtained from sources believed to be reliable but has not been verified. No warranty or representation, express or implied, is made as to the condition of the property (or properties) referenced herein or as to the accuracy or completeness of the information contained herein, and same is submitted subject to errors, omissions, change of price, rental or other conditions, withdrawal without notice, and to any special listing conditions imposed by the property owner(s). Any projections, opinions or estimates are subject to uncertainty and do not signify current or future property performance.



**CUSHMAN &
WAKEFIELD**

THE SONNA BUILDING

906-910 Main Street, Boise, Idaho 83702

241 TO 3,803 RSF FOR LEASE



THIRD FLOOR LAYOUT

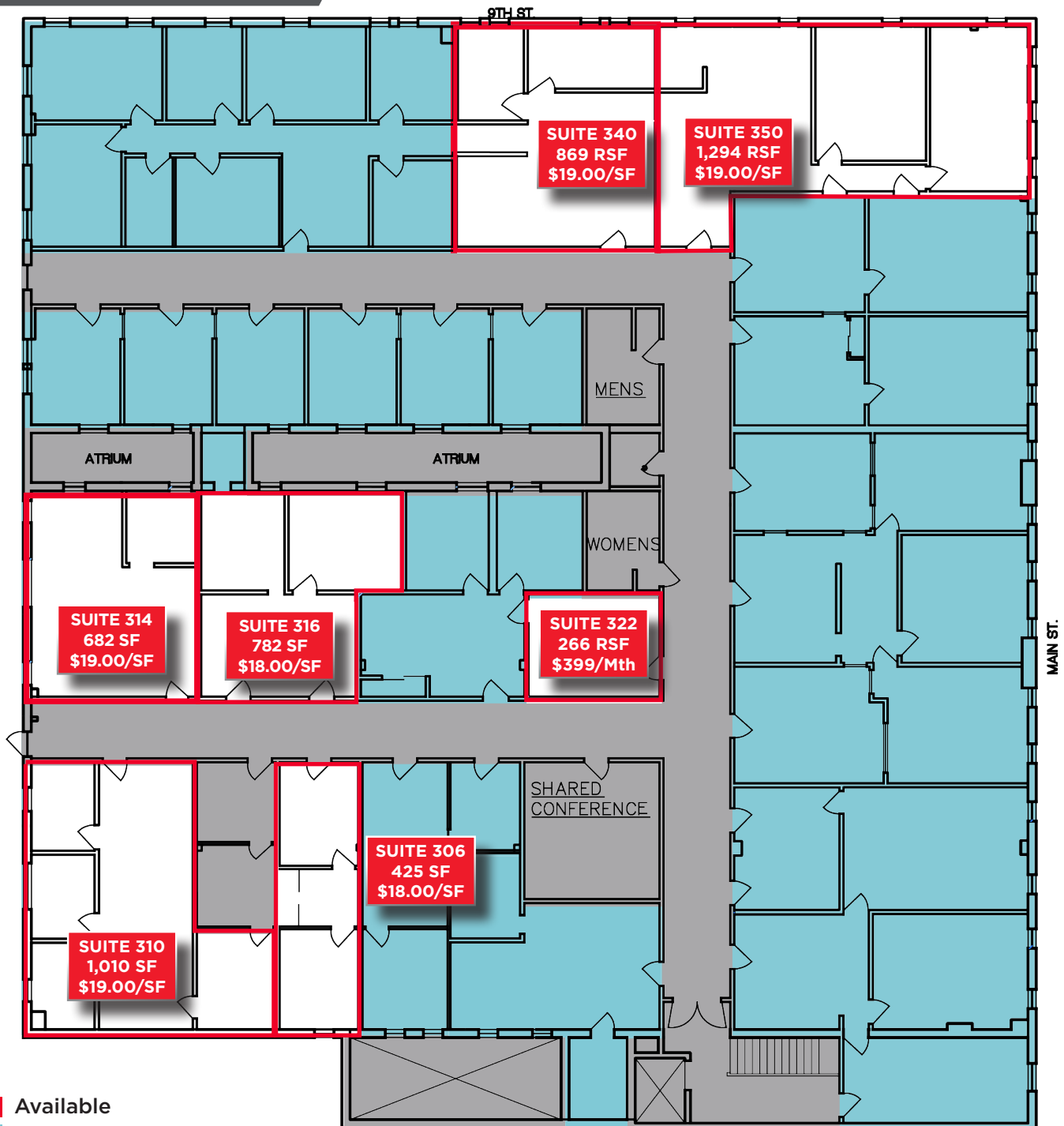

- Available
- Leased
- Common Area

THE SONNA BUILDING

906-910 Main Street, Boise, Idaho 83702

241 TO 3,803 RSF FOR LEASE

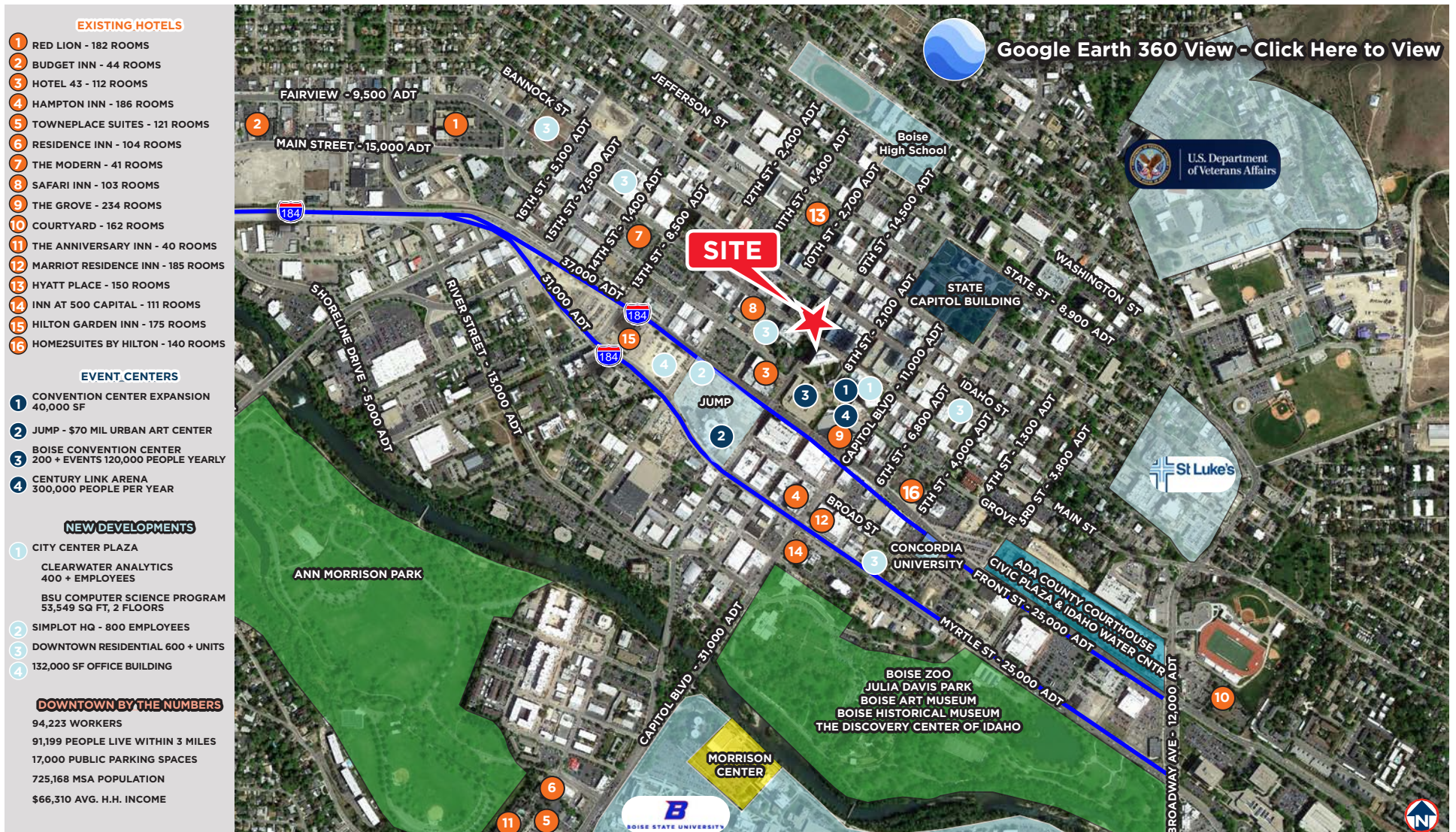

THE SONNA BUILDING

906-910 Main Street, Boise, Idaho 83702

241 TO 3,803 RSF FOR LEASE



National Accolades

It's no news to us - the Boise Metro is a great place to be. We chuckle in agreement when we're recognized for livability and recreation, and welcome visitors to come see what the hype is all about. Most of the time, we just appreciate not being confused with Iowa. Take a look our latest recognition. Click the tiles below to view - View All Accolades Here: <https://bvep.org/lifestyle/national-accolades>

**#10 Best City for
Young Professionals**

SmartAsset
June 2021

**Safest Cities in
America**

SmartAsset
April 2021

#5 Best State

US News & World
Report
March 2021

**Best-Performing
Cities**

Milken Institute
February 2021

**#4 Best Place to
Find a Job**

WalletHub
February 2021

**Top 5 Metros for First
Time Homebuyers**

Move.org
January 2021

**Cities With the Best
Work-Life Balance**

SmartAsset
January 2021

**#4 Best City for
Early Retirees**

SmartAsset
December 2020

**#4 Best City for First
Time Homebuyers**

SmartAsset
October 2020

**#1 City Whose Jobs
Are Recovering**

WalletHub
October 2020

**Most Moved-To
Cities**

Business Insider
September 2020

**Best Cities for Women
Entrepreneurs**

Fundera
September 2020

**Cities Whose
Unemployment Rates
Are Bouncing
Back Most**

WalletHub
September 2020

**Best Cities to
Drive In**

WalletHub
September 2020

**Most Bike Friendly
Cities in America**

SmartAsset
September 2020

**#1 Real Estate
Market**

WalletHub
August 2020

**Best Places to
Retire**

Forbes
August 2020

**Best Cities for
Manufacturing Jobs**

Kempler
July 2020

**#2 Best City for First-
Time Home Buyers**

WalletHub
July 2020

**Best Cities to Buy an
Affordable Family
Home**

SmartAsset
July 2020

**#1 & #3 Best Run
Cities**

WalletHub
July 2020 & 2019

**#1 Best City for a
Coronavirus
Recovery**

Forbes
May 2020

**#6 With The Most
Employment
Opportunities**

The Travel
May 2020

**#9 Most Underrated
City to Travel To**

World Atlas
April 2020