



Property Highlights

- **9,715 Total Building SF**
700 North Elm - 5,040 SF
708 North Elm - 4,675 SF
- **0.92 Total Acres**
- **Built in 1975**
- **Zoned Office**
- **Ample parking**
- **Within minutes of Eastchester and Hwy 311**
- **High Point Regional Hospital located across the street**
- **Monument signage available**
- **Travel time from Greensboro and Winston-Salem - 17 min.**
- **Asking Price: \$1,200,000**

Ryan Gioffre

Director
+1 336 821 3822
ryan.gioffre@cushwake.com

Bobby Finch

Executive Director
+1 336 812 3303
bobby.finch@cushwake.com

628 Green Valley Road, Suite 202
Greensboro, NC 27408 | USA
Main +1 336 668 9999
Fax +1 336 668 0888
cushmanwakefield.com



700 N. ELM ST. FLOOR PLAN

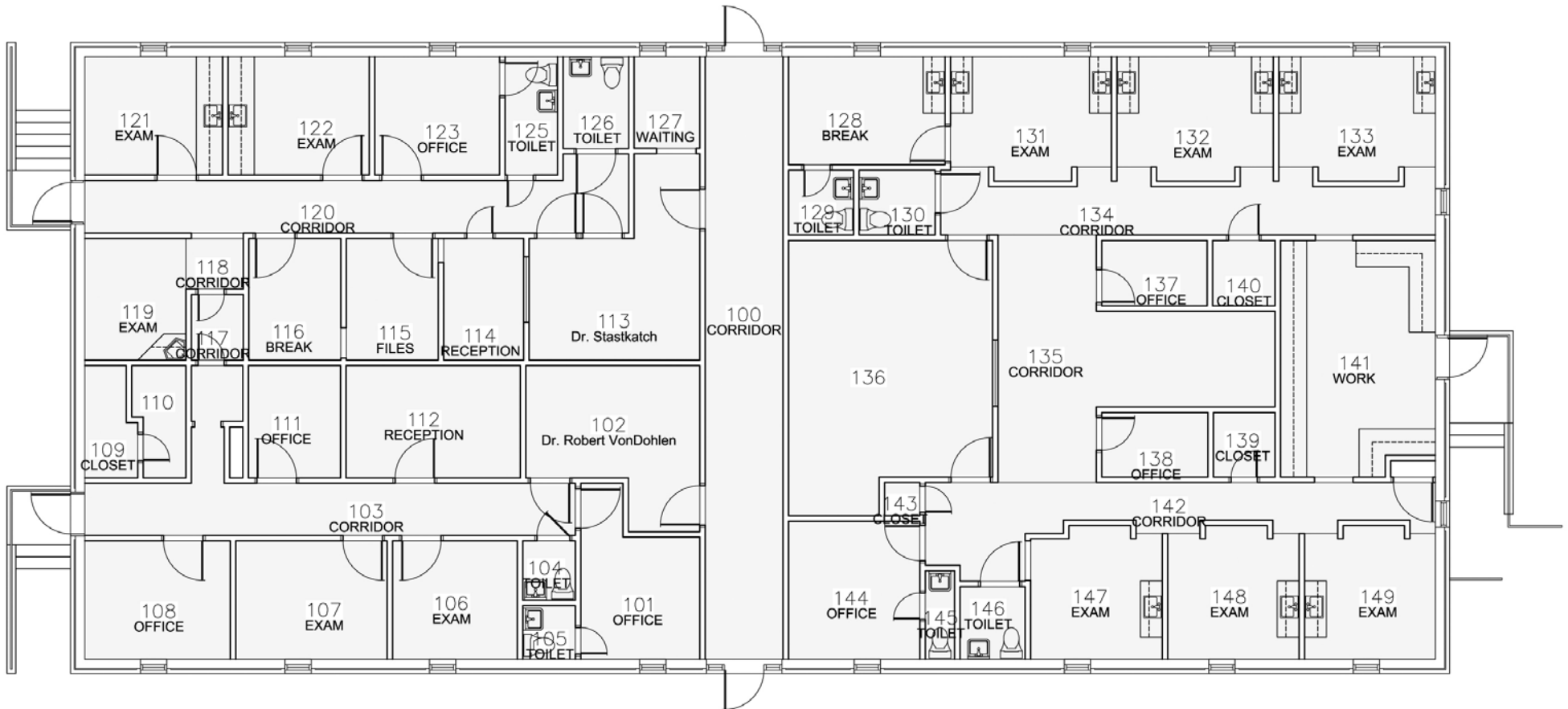

708 N. ELM ST. FLOOR PLAN

