



AIR-CONDITIONED WAREHOUSE



**CUSHMAN &
WAKEFIELD**

Commercial Kentucky

4608 SHEPHERDSVILLE RD

Louisville, KY 40218

**12,250 SF AVAILABLE
FOR LEASE**

PROPERTY HIGHLIGHTS

- 12,250 SF air-conditioned warehouse space
- 1,000 SF of newly constructed office space
- New LED lighting
- Two (2) dock-high loading doors
- Five (5) miles to I-264 and I-65

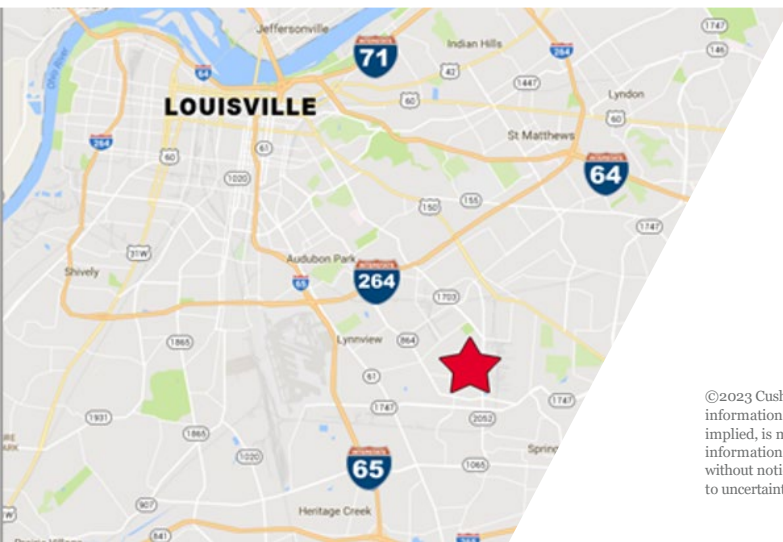

GREG CHARMOLI

Senior Director

+1 502 589 5150 ext. 238

gcharmoli@commercialkentucky.com

333 E. Main Street, Suite 510 | Louisville, KY 40202

+1 502 589 5150

www.CommercialKentucky.com

©2023 Cushman & Wakefield. All rights reserved. The information contained in this communication is strictly confidential. This information has been obtained from sources believed to be reliable but has not been verified. No warranty or representation, express or implied, is made as to the condition of the property (or properties) referenced herein or as to the accuracy or completeness of the information contained herein, and same is submitted subject to errors, omissions, change of price, rental or other conditions, withdrawal without notice, and to any special listing conditions imposed by the property owner(s). Any projections, opinions or estimates are subject to uncertainty and do not signify current or future property performance.

4608 SHEPHERDSVILLE RD

Louisville, KY 40218

12,250 SF FOR LEASE



FLOOR PLAN

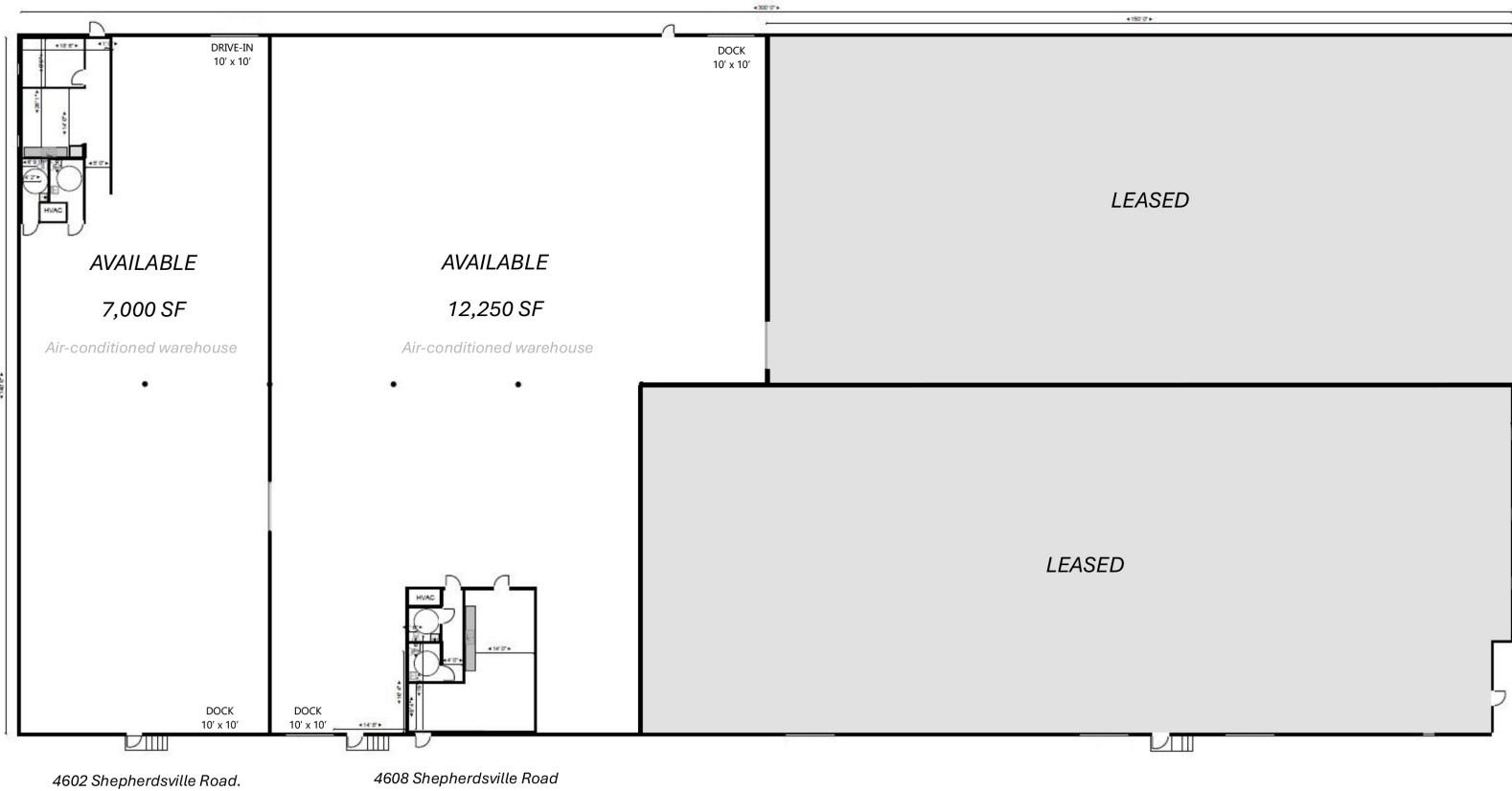

GREG CHARMOLI
Senior Director
+1 502 589 5150 ext. 238
gcharmoli@commercialkentucky.com

333 E. Main Street, Suite 510
Louisville, KY 40202
phone: +1 502 589 5150
www.CommercialKentucky.com

4608 SHEPHERDSVILLE RD

Louisville, KY 40218

12,250 SF FOR LEASE



MAP

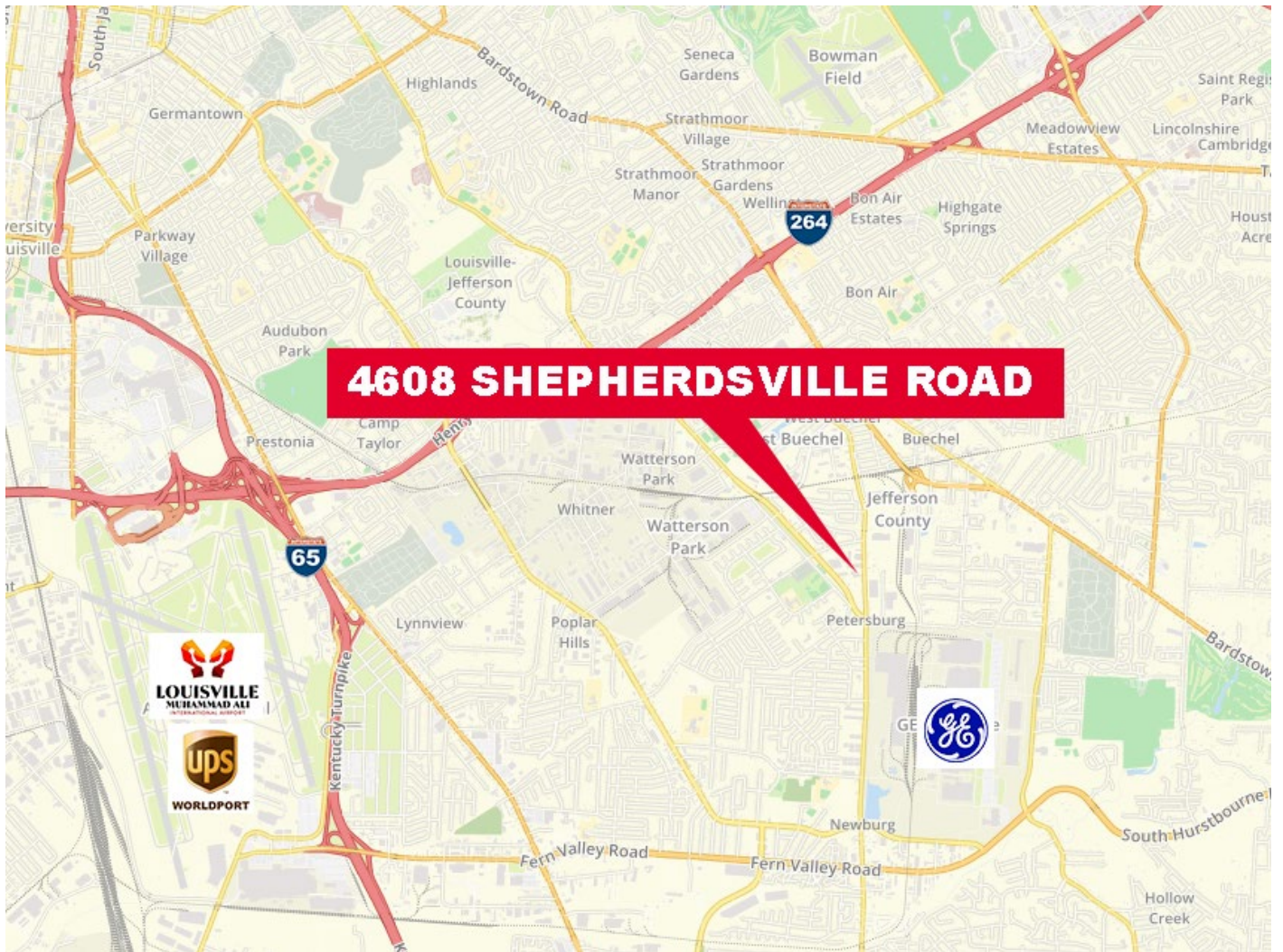

GREG CHARMOLI

Senior Director
+1 502 589 5150 ext. 238
gcharmoli@commercialkentucky.com

333 E. Main Street, Suite 510
Louisville, KY 40202
phone: +1 502 589 5150
www.CommercialKentucky.com