

FOR LEASE

3,191 SF OFFICE/WAREHOUSE



BAY 18

21 HIGHFIELD CIRCLE SE

CALGARY, AB



Lead Agents:

BRAD PILLING

brad.pilling@cushwake.com

SAM HURL

sam.hurl@cushwake.com

PROPERTY DETAILS

District:	Highfield
Available Area:	± 3,191 sf
Office Area:	±925 sf
Warehouse Area:	±1,400 sf
Mezzanine Area:	±866 sf
Loading:	1 (10' x 12') drive-in door
Ceiling Height:	22' clear
Power:	100A, 3 phase (TBV)
Heating:	Forced air units in warehouse; RTUs in office
Zoning:	I-G (Industrial General)
Lease Rate:	\$15.00 psf
Op. Costs (2024 est.):	\$7.25 psf
Available:	Immediately

Highlights

- Central location
- Fully sprinklered
- 4 reserved parking stalls
- Telus fibre optic available
- Pre-cast construction
- Good access onto Blackfoot and Macleod Trail
- Close proximity to 39th Avenue LRT station



FLOOR PLAN

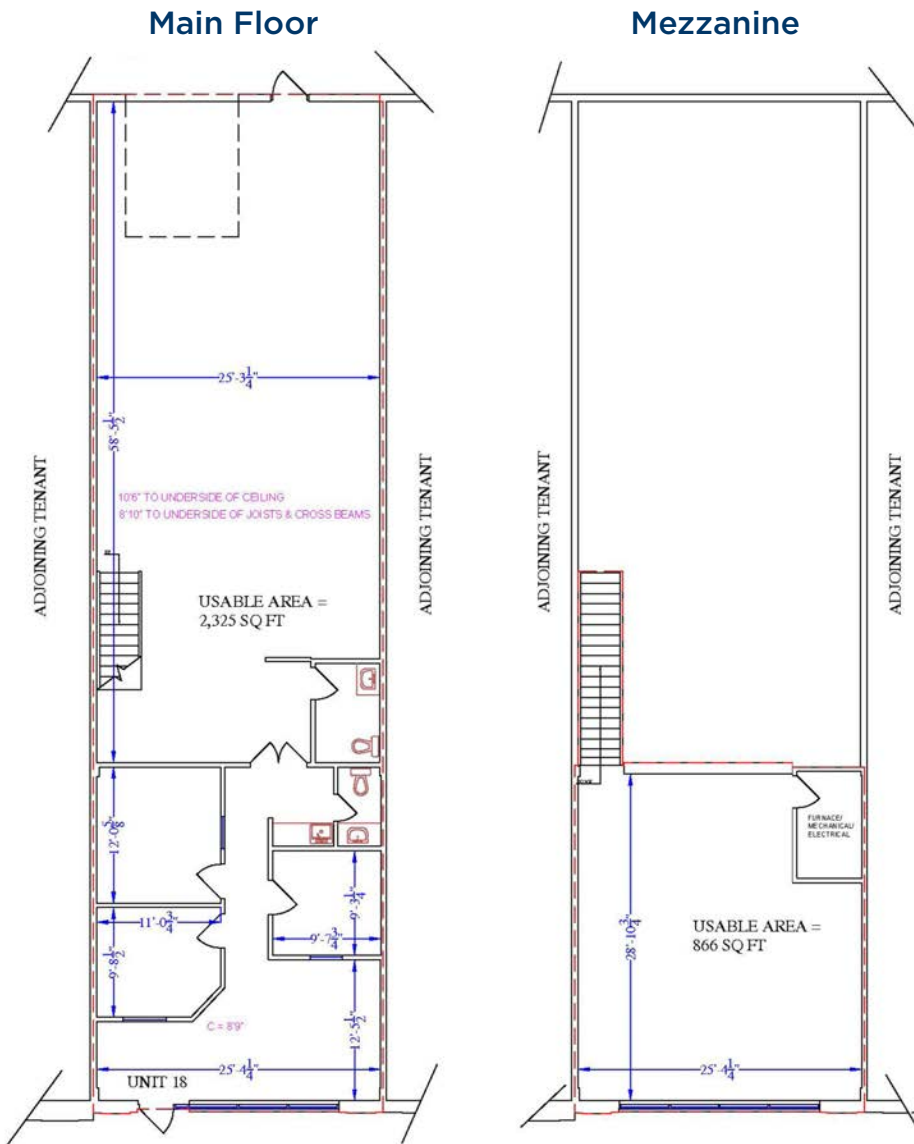

*Not to scale, not exactly as shown.



Warehouse

LOCATION MAP

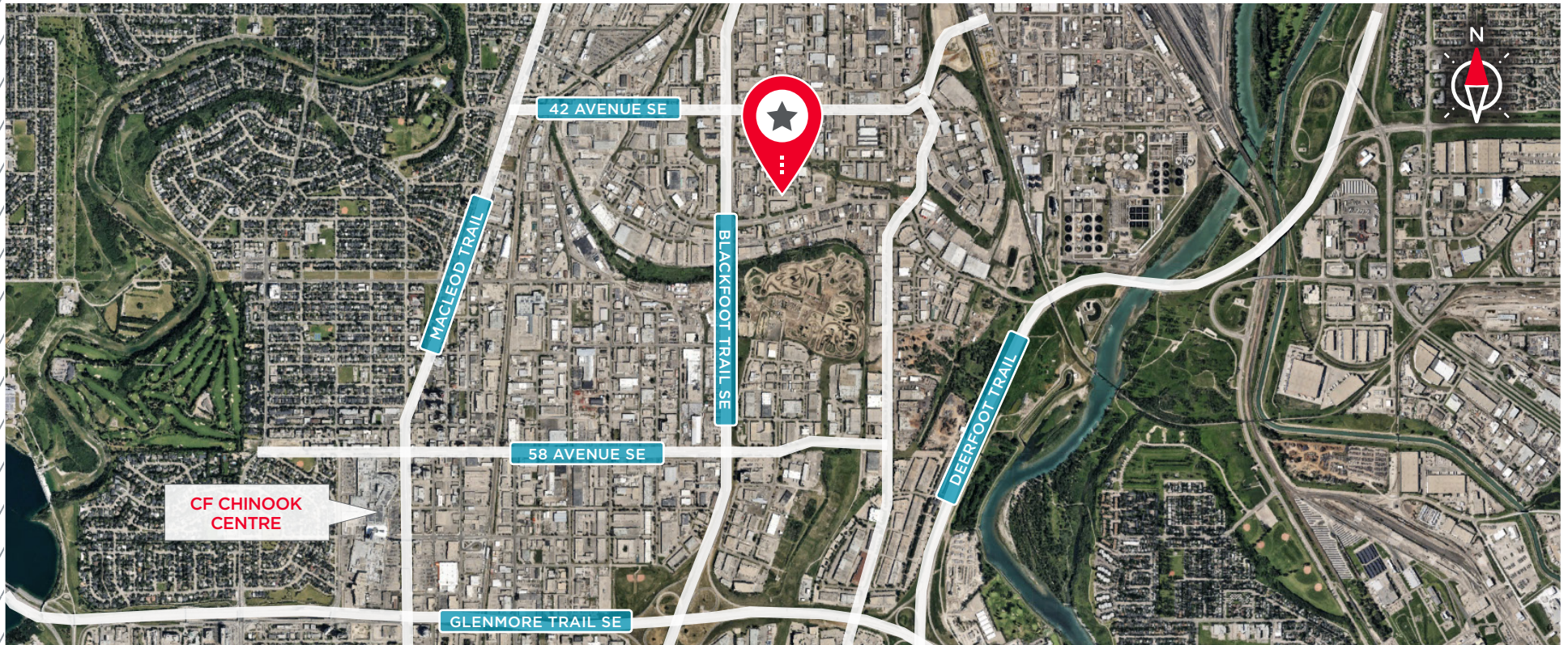

BRAD PILLING
Vice President
Industrial Sales & Leasing
D: 403 261 1121
C: 403 880 1419
brad.pilling@cushwake.com

SAM HURL
Associate
Industrial Sales & Leasing
D: 403 261 1115
C: 403 630 7215
sam.hurl@cushwake.com

BRENT JOHANNESSEN
Vice President
Industrial Sales & Leasing
D: 403 261 1116
C: 403 589 8600
brent.johannesen@cushwake.com

ZACK DARRAGH
Vice President
Industrial Sales & Leasing
D: 403 261 1120
C: 587 437 2595
zack.darragh@cushwake.com

JORDAN LEBLANC
Associate Vice President
Industrial Sales & Leasing
D: 403 261 1166
C: 403 660 5141
jordan.leblanc@cushwake.com



CUSHMAN & WAKEFIELD ULC
250 - 6 Ave SW, Suite 2400
Calgary, AB T2P 3H7
cushmanwakefield.com