

FOR SUBLEASE:

6900

KOLL CENTER PKWY
PLEASANTON CALIFORNIA



PROPERTY HIGHLIGHTS

- Approximately 7,471 RSF
- Suite 406
- Lease term through 6/30/26
- Located within the pristine Bernal Corporate Park
- Full Commercial Kitchen in place
- Walk in refrigerators and fridges
- Grade level roll up doors
- Convenient access to I-680
- Walking distance to numerous retail amenities.
- A short drive from historic downtown Pleasanton

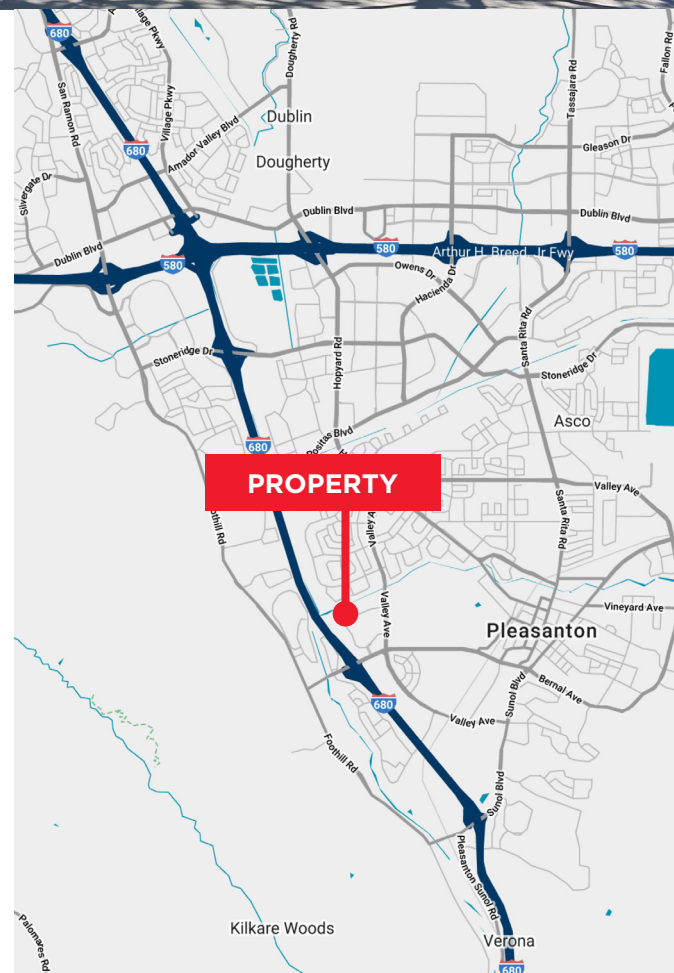

MICHAEL COPELAND

Managing Director // +1 925 621 3855 // michael.copeland@cushwake.com // LIC #00898210

CUSHMAN & WAKEFIELD

FOR SUBLEASE:

6900 KOLL CENTER PKWY
PLEASANTON CALIFORNIA

FLOOR PLAN

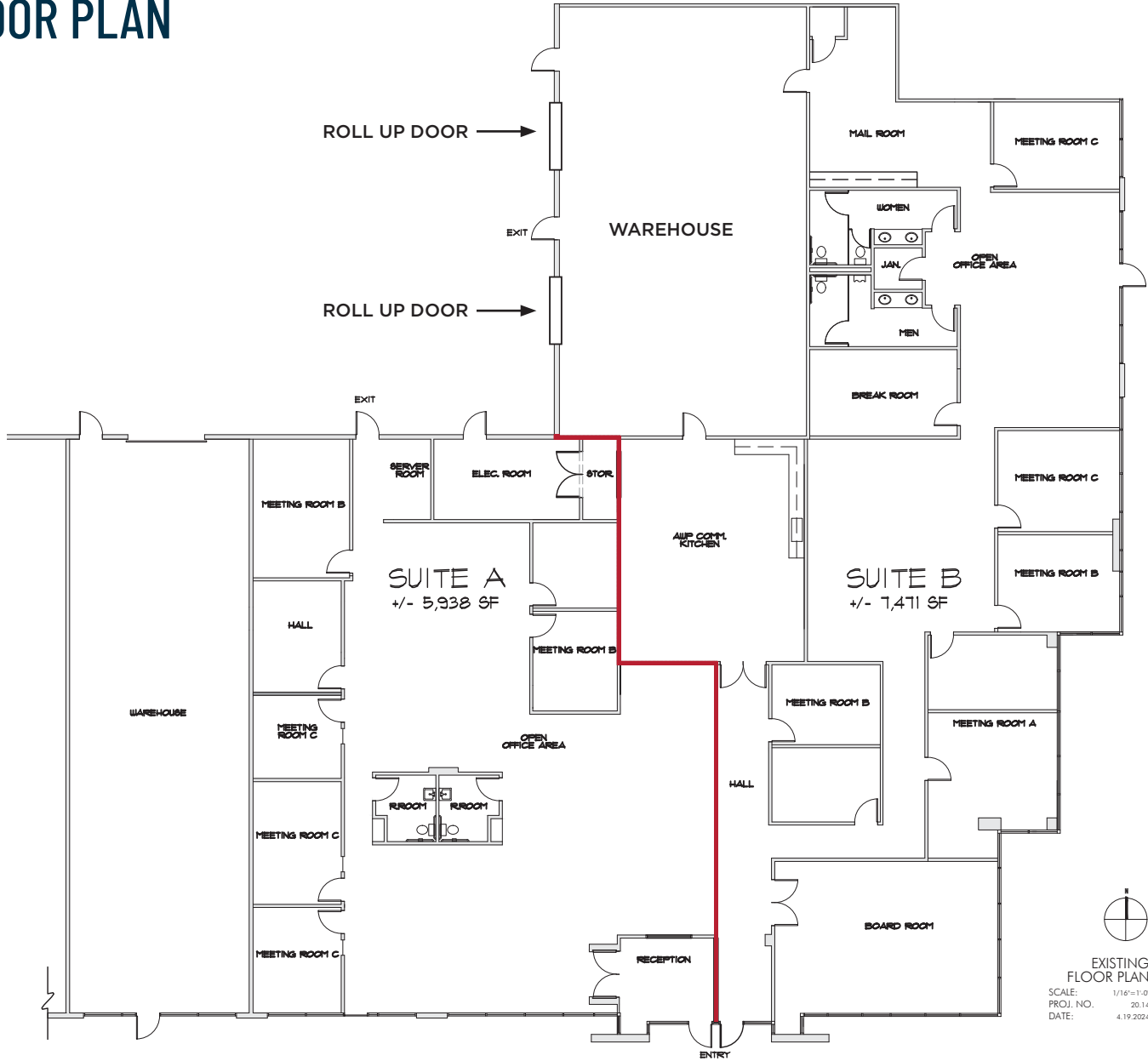

EXISTING FLOOR PLAN
SCALE: 1/16"=1'-0"
PROJ. NO. 20-14
DATE: 4.19.2024

©2024 Cushman & Wakefield. All rights reserved. The information contained in this communication is strictly confidential. This information has been obtained from sources believed to be reliable but has not been verified. NO WARRANTY OR REPRESENTATION, EXPRESS OR IMPLIED, IS MADE AS TO THE CONDITION OF THE PROPERTY (OR PROPERTIES) REFERENCED HEREIN OR AS TO THE ACCURACY OR COMPLETENESS OF THE INFORMATION CONTAINED HEREIN, AND SAME IS SUBMITTED SUBJECT TO ERRORS, OMISSIONS, CHANGE OF PRICE, RENTAL OR OTHER CONDITIONS, WITHDRAWAL WITHOUT NOTICE, AND TO ANY SPECIAL LISTING CONDITIONS IMPOSED BY THE PROPERTY OWNER(S). ANY PROJECTIONS, OPINIONS OR ESTIMATES ARE SUBJECT TO UNCERTAINTY AND DO NOT SIGNIFY CURRENT OR FUTURE PROPERTY PERFORMANCE.

MICHAEL COPELAND

Managing Director // +1 925 621 3855 // michael.copeland@cushwake.com // LIC #00898210

