

**LAB, LIFE SCIENCE/R&D SPACE FOR LEASE  
HEAVY POWER!**

**4464**  
**WILLOW RD.**  
PLEASANTON | CALIFORNIA

**FOR LEASE: SUITE 103**

- » Lease rate of \$2.35/SF/NNN
- » Estimated OpEx \$0.40/SF
- » A Welcome to the Park Luncheon for new tenants
- » Five (5) year minimum term
- » Strong local ownership and property management



**2,000 AMPS/480 VOLT  
HEAVY POWER**

**MICHAEL COPELAND**

+1 925 621 3855 | [michael.copeland@cushwake.com](mailto:michael.copeland@cushwake.com) | Lic. 00898210

**JUSTIN GRILLI**

+1 925 997 1353 | [justin.grilli@nmrk.com](mailto:justin.grilli@nmrk.com) | Lic. 01410373





## PROPERTY HIGHLIGHTS

Available: Preeminent Office Flex / Warehouse Space

- ±25,849 SF, ±50% Warehouse, Dock-High and Grade Level Doors, ±20' clear.
- Rent: \$2.35NNN
- Corner Unit with Direct Access Off Parking Lot
- Building and Monument Signage
- Ample Parking 4/1000
- Breakroom and Training/Presentation Area
- Outdoor Enclosed Staging/Storage Area
- Heavy Power: 2,000 Amps/480 Volt
- Low Operating Expenses
- Attractive Window Line
- Professionally Managed

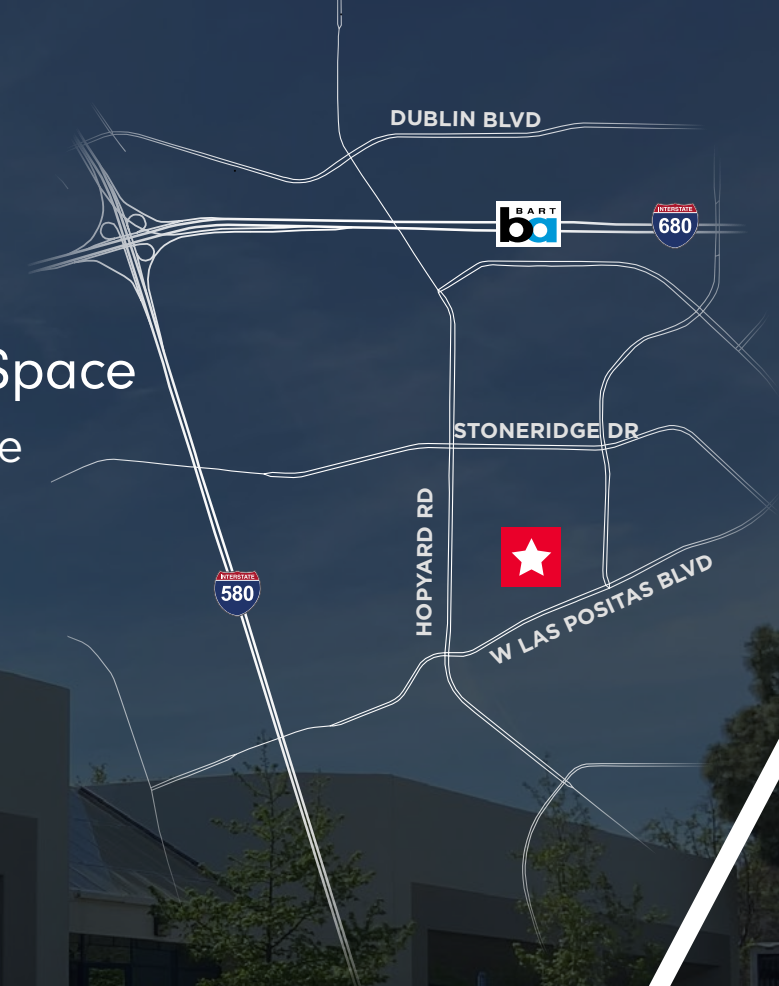

**4464**  
WILLOW RD.  
PLEASANTON | CALIFORNIA

## FLOOR PLAN

±25,849 SF

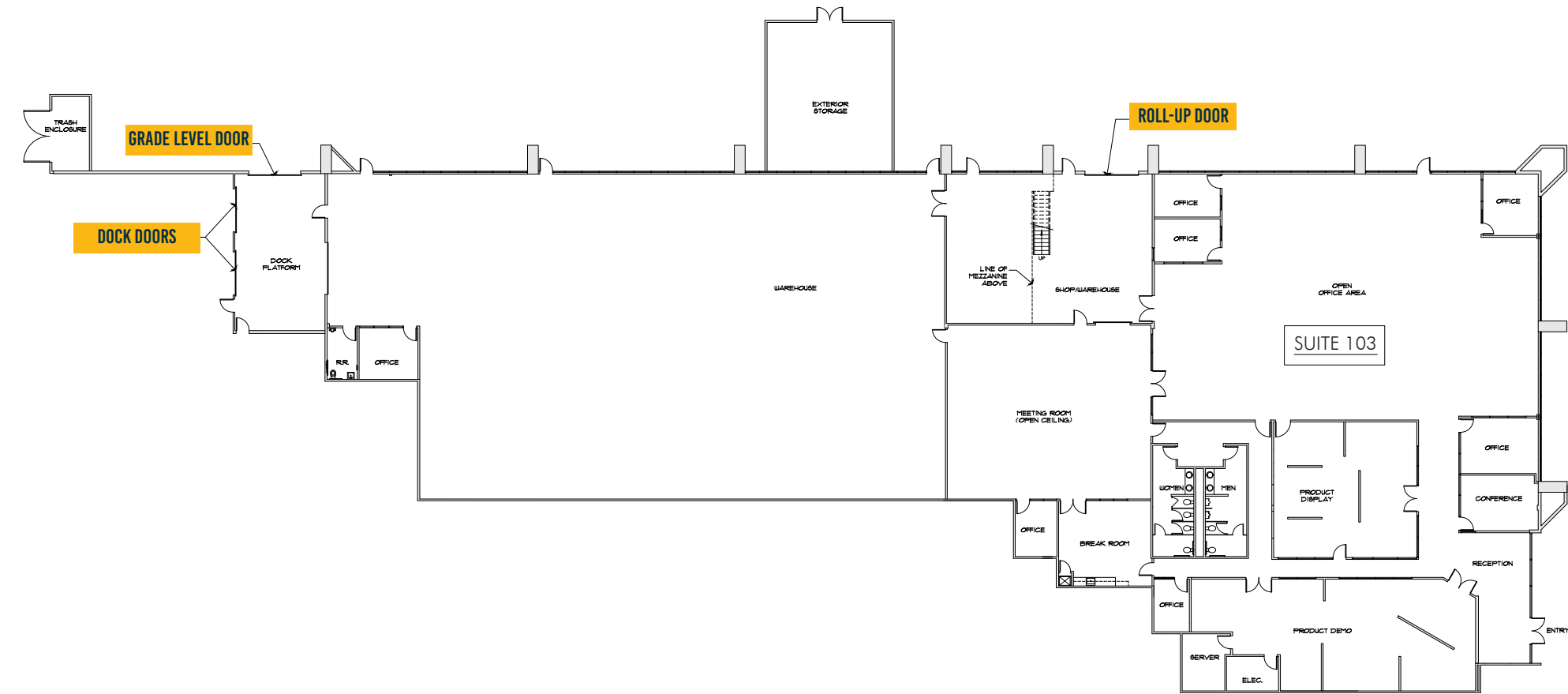

**4464**  
WILLOW RD.  
PLEASANTON | CALIFORNIA



# CONNECTIVITY



AVERAGE MORNING  
COMMUTE TIME  
FROM  
SOUTH SAN JOSE  
**45 MINUTES**

AVERAGE MORNING  
COMMUTE TIME  
TO  
SOUTH SAN JOSE  
**45 MINUTES**

**4464**  
WILLOW RD.  
PLEASANTON | CALIFORNIA

# AMENITIES NEARBY

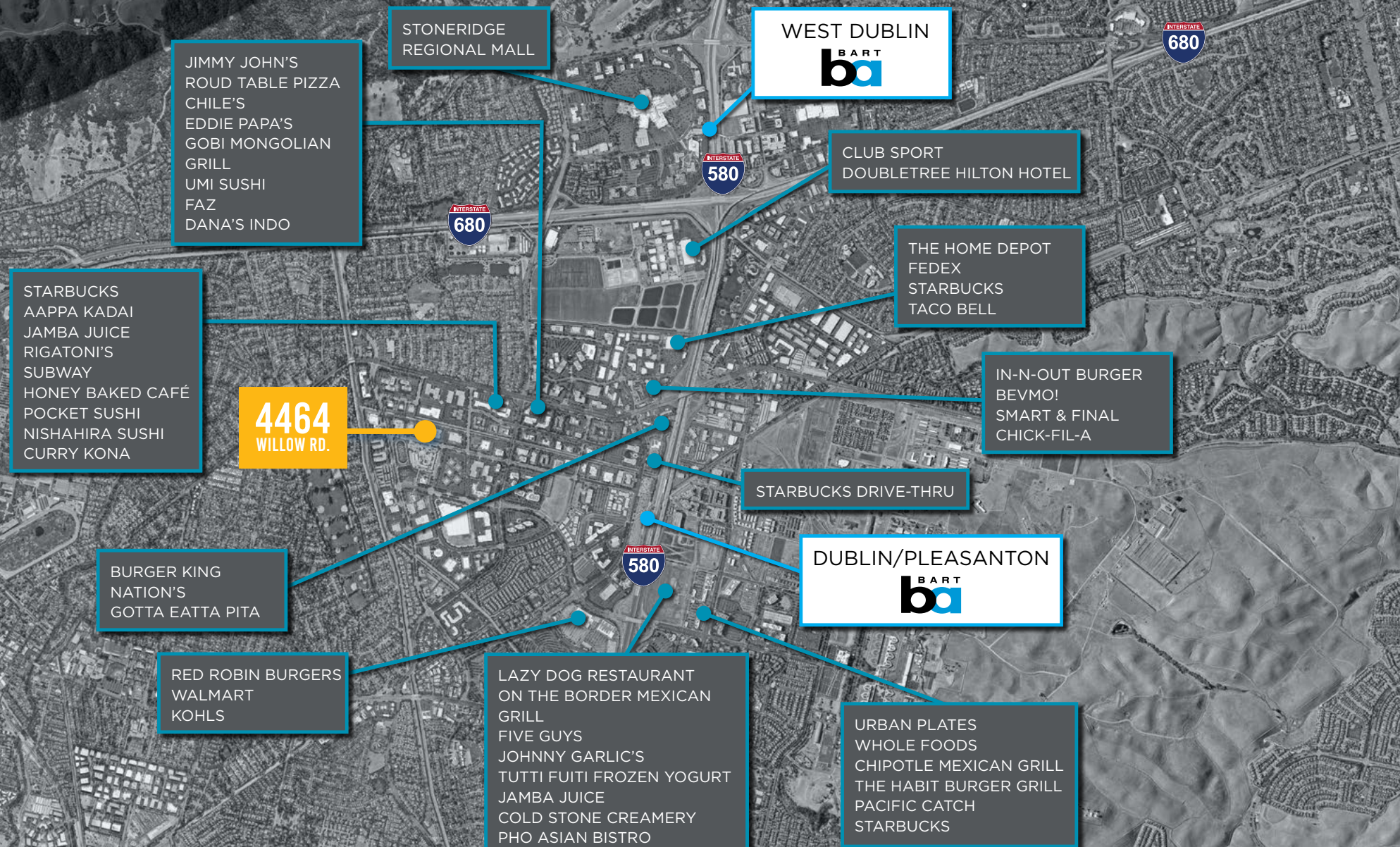



# 4464 WILLOW RD.

PLEASANTON | CALIFORNIA

TERRENCE J. ROSE, INC.  
REAL ESTATE  
INVESTMENT & DEVELOPMENT

©2024 Cushman & Wakefield. All rights reserved. The information contained in this communication is strictly confidential. This information has been obtained from sources believed to be reliable but has not been verified. NO WARRANTY OR REPRESENTATION, EXPRESS OR IMPLIED, IS MADE AS TO THE CONDITION OF THE PROPERTY (OR PROPERTIES) REFERENCED HEREIN OR AS TO THE ACCURACY OR COMPLETENESS OF THE INFORMATION CONTAINED HEREIN, AND SAME IS SUBMITTED SUBJECT TO ERRORS, OMISSIONS, CHANGE OF PRICE, RENTAL OR OTHER CONDITIONS, WITHDRAWAL WITHOUT NOTICE, AND TO ANY SPECIAL LISTING CONDITIONS IMPOSED BY THE PROPERTY OWNER(S). ANY PROJECTIONS, OPINIONS OR ESTIMATES ARE SUBJECT TO UNCERTAINTY AND DO NOT SIGNIFY CURRENT OR FUTURE PROPERTY PERFORMANCE.

## MICHAEL COPELAND

Managing Director  
+1 925 621 3855  
[michael.copeland@cushwake.com](mailto:michael.copeland@cushwake.com)  
Lic. 00898210

## JUSTIN GRILLI

Senior Managing Director  
+1 925 997 1353  
[justin.grilli@nmrk.com](mailto:justin.grilli@nmrk.com)  
Lic. 01410373

1333 N California Blvd, Suite 500  
Walnut Creek, CA  
Main +1 925 935 0770  
[cushmanwakefield.com](http://cushmanwakefield.com)

