

# 1390

WILLOW PASS RD.  
SUITE 470 | CONCORD, CA



FOR SUBLEASE: ±7,145 RSF

**John Fennell**

Managing Director

925-274-2802 // [john.fennell@cushwake.com](mailto:john.fennell@cushwake.com) // LIC # 00902673





# FOR SUBLEASE:

## 1390 WILLOW PASS ROAD SUITE 470 | CONCORD, CA

Square Footage:	7,145 RSF
Lease Expires:	12/31/2028
Furniture:	Nicely furnished space
Layout:	Reception area; 10 private offices; couple conference rooms with flat screen TVs; lunch room; storage room; work room, IT room; open areas with workstations.
Rental Rate:	\$1.85/SF/month, full-service gross starting rent

### PROPERTY HIGHLIGHTS



**John Fennell**  
Managing Director  
925-274-2802 // [john.fennell@cushwake.com](mailto:john.fennell@cushwake.com) // LIC # 00902673



# FOR SUBLEASE:

## 1390 WILLOW PASS ROAD

### SUITE 470 | CONCORD, CA

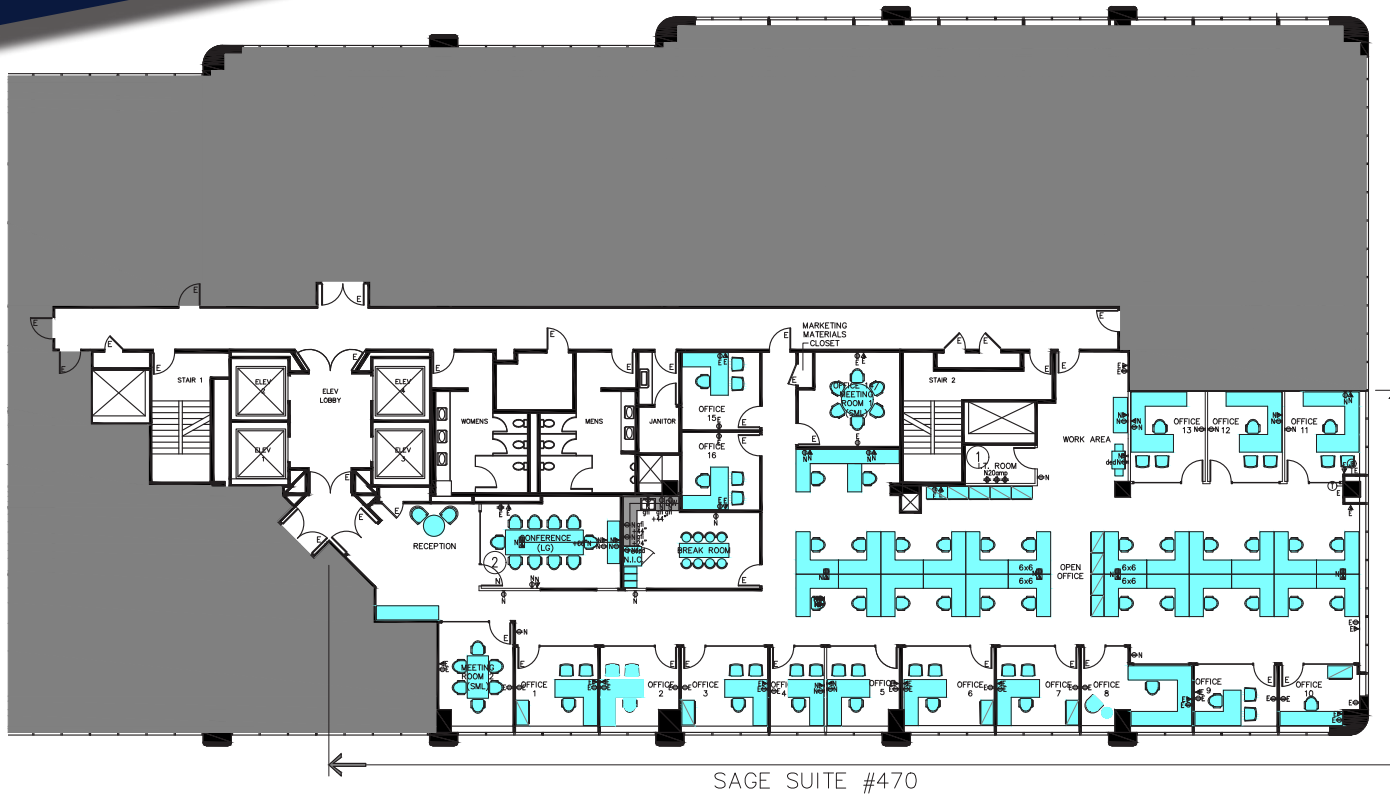

#### LEGEND:

- ⊕ WALL MOUNTED DUPLEX OUTLET
- ⊕ WALL MOUNTED QUADRUPLUX OUTLET
- ▲ WALL MOUNTED TELEPHONE OUTLET
- BLANK OUTLET
- Ⓜ J-BOX & TELEPHONE FOR WORKSTATIONS
- Ⓜ DOGHOUSE QUAD / DATA FOR WORKSTATIONS OR CONFERENCE TABLE (LOCATION TO BE CONFIRMED BY TENANT)
- +42" SPECIAL MOUNTING HEIGHT
- E EXISTING OUTLET
- N NEW OUTLET
- ded DEDICATED OUTLET
- gfi GROUND FAULT INTERRUPTER

#### KEY NOTES:

- ① PROVIDE (3) 20amp RECEPTACLES IN I.T. ROOM.
- ② PROVIDE 3/4" CONDUIT UNDER FLOOR FROM FLOOR MONUMENT TO TV WALL.

## FLOOR PLAN

**FOR SUBLEASE:**  
1390 WILLOW PASS ROAD  
SUITE 470 | CONCORD, CA



PHOTO GALLERY



**John Fennell**  
Managing Director  
925-274-2802 // [john.fennell@cushwake.com](mailto:john.fennell@cushwake.com) // LIC # 00902673





# FOR SUBLEASE: 1390 WILLOW PASS ROAD SUITE 470 | CONCORD, CA



**TARGET**

**THE VERANDA**

**willows**  
Eat. Shop. Explore.

**SUNVALLEY**

**TRADER JOE'S**

**THE HOME DEPOT**

**99 RANCH MARKET**

**1390**  
WILLOW PASS RD.  
SUITE 470 | CONCORD, CA

**BART**

## AMENITIES MAP

**John Fennell**  
Managing Director  
925-274-2802 // [john.fennell@cushwake.com](mailto:john.fennell@cushwake.com) // LIC # 00902673

©2023 Cushman & Wakefield. All rights reserved. The information contained in this communication is strictly confidential. This information has been obtained from sources believed to be reliable but has not been verified. NO WARRANTY OR REPRESENTATION, EXPRESS OR IMPLIED, IS MADE AS TO THE CONDITION OF THE PROPERTY (OR PROPERTIES) REFERENCED HEREIN OR AS TO THE ACCURACY OR COMPLETENESS OF THE INFORMATION CONTAINED HEREIN, AND SAME IS SUBMITTED SUBJECT TO ERRORS, OMISSIONS, CHANGE OF PRICE, RENTAL OR OTHER CONDITIONS, WITHDRAWAL WITHOUT NOTICE, AND TO ANY SPECIAL LISTING CONDITIONS IMPOSED BY THE PROPERTY OWNER(S). ANY PROJECTIONS, OPINIONS OR ESTIMATES ARE SUBJECT TO UNCERTAINTY AND DO NOT SIGNIFY CURRENT OR FUTURE PROPERTY PERFORMANCE.

