

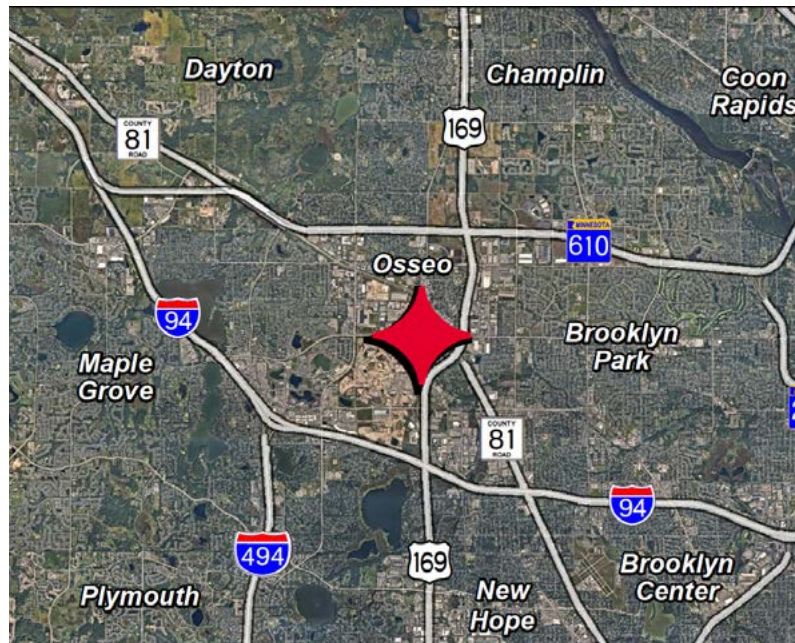

**AVAILABLE JAN 2025**

## Property Highlights

- Excellent visibility
- Direct access to Hwy 169
- Dock loading
- Heavy power
- Close proximity to amenities



### Brent Masica

Executive Managing Director  
+1 952 893 8231  
brent.masica@cushwake.com

### Jason Meyer

Executive Director  
+1 952 820 8735  
jason.j.meyer@cushwake.com

### Hudson Brothen

Executive Director  
+1 952 893 8261  
hudson.brothen@cushwake.com

3500 American Blvd W Suite 200  
Minneapolis, MN 55431  
Main +1 952 831 1000  
[cushmanwakefield.com](http://cushmanwakefield.com)

## Building Features

Building Size	46,875 sf
Site	3.43 acres
Clear Height	14'
Power	Heavy
Taxes & CAM	\$3.69 psf
Lease Rates	\$9.00 psf



## Space Available

Suite	Total SF	Office SF	Warehouse SF	Loading	Available
9600	4,979 SF	70 SF	4,909 SF	1 dock	January 1, 2025

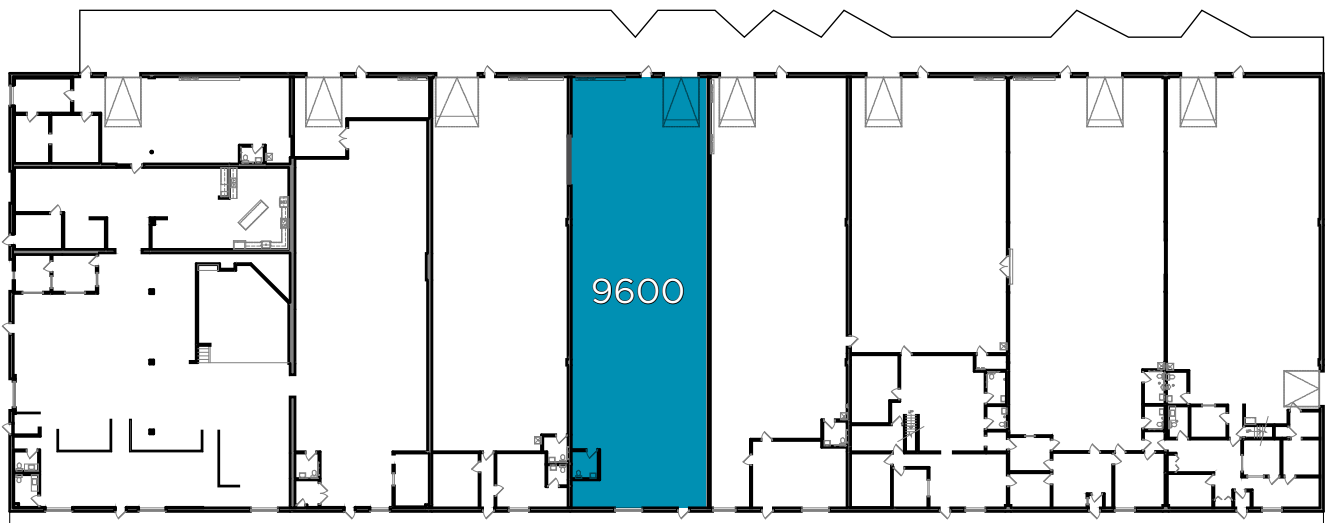

**Suite 9600**

