

1150

INDUSTRIAL AVE

PETALUMA, CA 94952



Suite #D for Lease

±4,800 SF

TREVOR BUCK

Executive Managing Director
+1 415 451 2436
trevor.buck@cushwake.com
Lic #: 01255462

DREW SOLTIS

Associate
+1 415 451 2415
drew.soltis@cushwake.com
Lic #: 02163430



**CUSHMAN &
WAKEFIELD**

// PROPERTY OVERVIEW

Ideal for new small businesses or established companies looking to expand. This versatile space offers an 18-foot clear height, large roll-up door, concrete floors, and full insulation, ensuring a comfortable and efficient work environment.

With easy highway and truck access, a well-sized front-end office, an in-suite bathroom, and a full sprinkler system, this property meets all your warehouse needs. Perfectly suited for growing your business in a prime location.



// **1150 INDUSTRIAL AVE**
Petaluma, CA 94939



// SPECS

AVAILABLE SUITE

D

CLEAR HEIGHT

±18'

FLOORING

CONCRETE

AVAILABLE SPACE

±4,800 SF

ROLL UP DOORS

1

FULLY SPRINKLERED

YES

ASKING RENT

\$1.20 INDUSTRIAL GROSS

IN SUITE BATHROOMS

1

FULLY INSULATED

YES

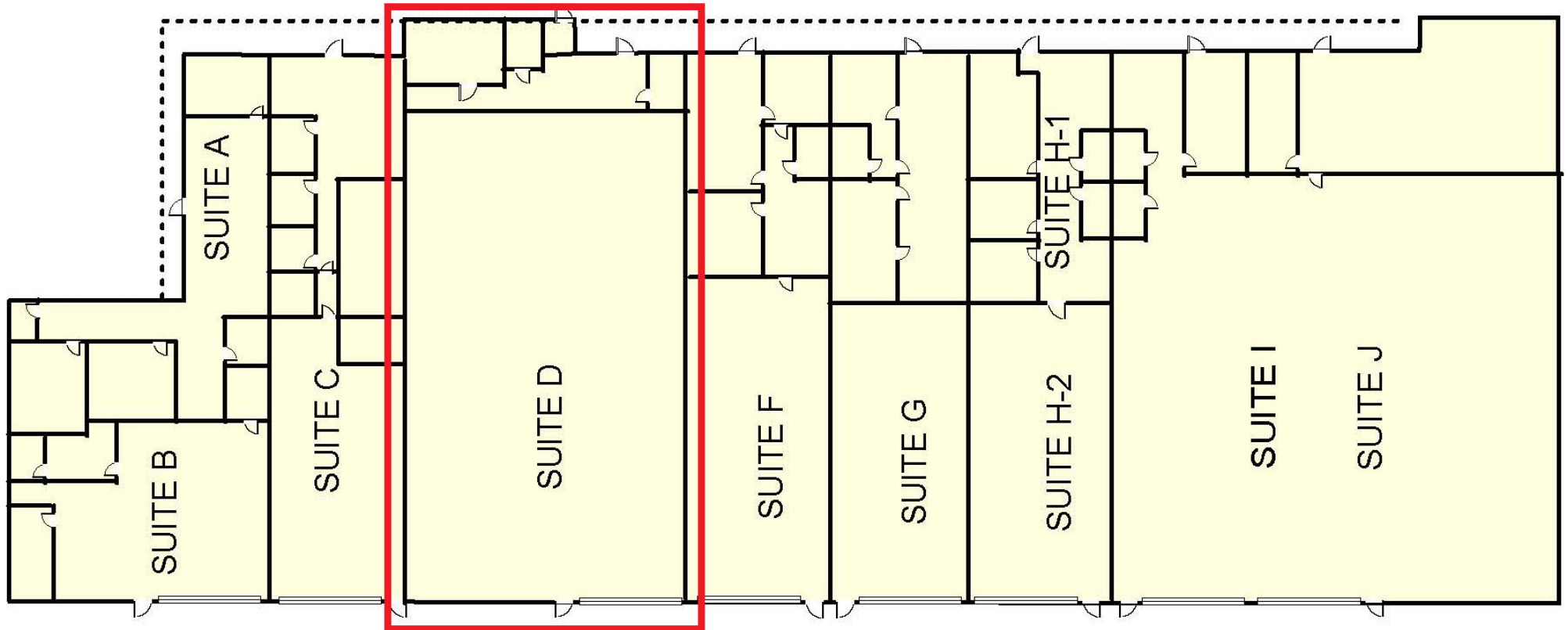

// GALLERY



1150
INDUSTRIAL AVE



CONTACT

TREVOR BUCK

Executive Managing Director

+1 415 451 2436

trevor.buck@cushwake.com

Lic #: 01255462

DREW SOLTIS

Associate

+1 415 451 2415

drew.soltis@cushwake.com

Lic #: 02163430

