



1600 W 135th St
Gardena, CA 90249

**TEAM
CONDON**
alexia • brittany • connor • erica
jacob • kevin • kylie • mckenna
mike • pete • scott



**CUSHMAN &
WAKEFIELD**

BUILDING SIZE:	190,860 SF
LOT SIZE:	8.46 AC
ZONING:	M2
CLEAR HEIGHT:	36'
OFFICE SF:	10,000 SF (Expandable)
AUTO PARKING:	85 (trailer stalls can be converted to auto parking stalls)
DOCK DOORS:	22
GRADE LEVEL:	2
TRAILER PARKING:	47
POWER:	1,200 AMPS; Expandable to 4,000 AMPS
SPRINKLERS:	ESFR
DIMENSIONS:	350' x 512'
COLUMN SPACING:	52' x 60'
EV CHARGING STATIONS	On Site



ESG
Conscious Project



36'
Clear
Height



PARKING
185' Yard
Provides for 47
Trailer Stalls



LOCATION
9.5 miles to Port of
LA & Long Beach
5 miles to LAX

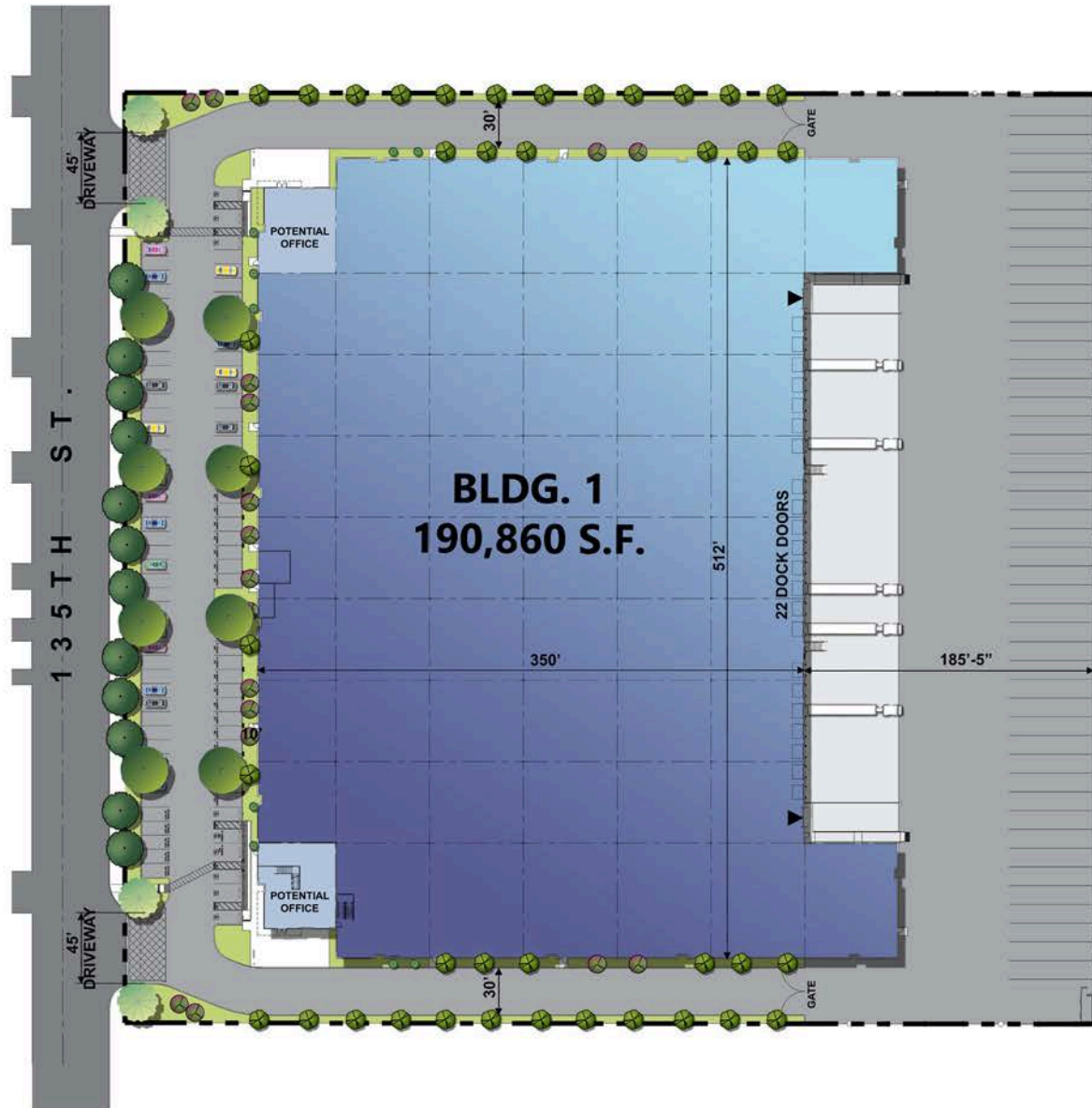

CONTACT INFORMATION:

BRITTANY WINN
Senior Director
 +1 213 629 6514
 brittany.winn@cushwake.com
 Lic. 01978909

MCKENNA GASKILL
Associate
 +1 213 629 6529
 mckenna.gaskill@cushwake.com
 Lic. 02049956

MIKE CONDON JR.
Vice Chairman
 +1 213 629 7379
 mike.condon@cushwake.com
 Lic. 01884476

OMP
 TEAM
CONDON

alexia • brittany • connor • erica
 jacob • kevin • kylie • mckenna
 mike • pete • scott

© 2022 Cushman & Wakefield. All rights reserved. The information contained in this communication is confidential, may be privileged and is intended for the exclusive use of the above named addressee(s). If you are not the intended recipient(s), you are expressly prohibited from copying, distributing, disseminating, or in any other way using any information contained within this communication. This information has been obtained from sources believed to be reliable but has not been verified. NO WARRANTY OR REPRESENTATION, EXPRESS OR IMPLIED, IS MADE AS TO THE CONDITION OF THE PROPERTY (OR PROPERTIES) REFERENCED HEREIN OR AS TO THE ACCURACY OR COMPLETENESS OF THE INFORMATION CONTAINED HEREIN, AND SAME IS SUBMITTED SUBJECT TO ERRORS, OMISSIONS, CHANGE OF PRICE, RENTAL OR OTHER CONDITIONS, WITHDRAWAL WITHOUT NOTICE, AND TO ANY SPECIAL LISTING CONDITIONS IMPOSED BY THE PROPERTY OWNER(S). ANY PROJECTIONS, OPINIONS OR ESTIMATES ARE SUBJECT TO UNCERTAINTY AND DO NOT SIGNIFY CURRENT OR FUTURE PROPERTY PERFORMANCE. This e-mail may be considered advertising under federal law.