

**CUSHMAN &  
WAKEFIELD**

FOR SUBLEASE

## **San Felipe Plaza**

**5847 SAN FELIPE, 46TH FLOOR, 2,432 RSF**



FOR SUBLEASE

# San Felipe Plaza

5847 SAN FELIPE, 46TH FLOOR, 2,432 RSF



- Fitness Center with Lockers
- Recently Renovated Building Lobby
- Tenant Conference Center
- On-Site Café & Starbucks Coffee
- 24/7 On-Site Security
- Shoe Shine



## Property Highlights

**Address:** 5847 San Felipe, Suite 4675

**Space:** 2,432 RSF

**Floor:** 46 (top floor of building)

**Availability:** July 1, 2020

**Term:** Through April 30, 2023

**Rate:** Negotiable

**2020 OPEX:** \$16.57

**TI:** As-is

**Furniture:** Negotiable

**Parking:** 7 UNR and 2 RES (\$40/\$75)

**Summary:** Fully-built out space with 2 private offices, 4 cubicles, break room conference room, and direct Lobby exposure

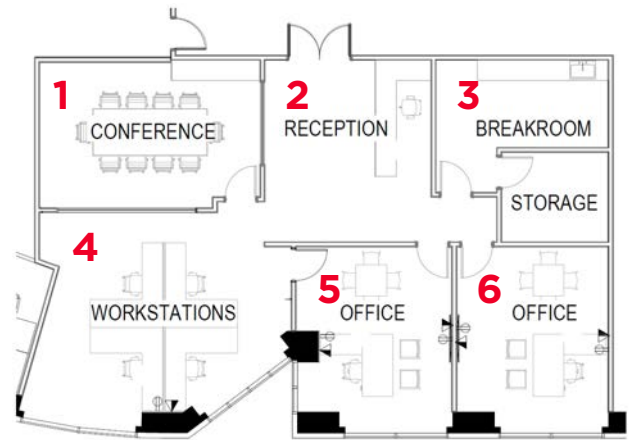



FOR SUBLEASE

# San Felipe Plaza

5847 SAN FELIPE, 46TH FLOOR, 2,432 RSF



**Brad Beasley**  
Managing Director  
+1 713 260 0210  
brad.beasley@cushwake.com

**Connor Saxe**  
Managing Director  
+1 713 260 0292  
connor.saxe@cushwake.com

5847 San Felipe Suite 600 Houston, TX 77057

+1 713 877 1550

[cushmanwakefield.com](http://cushmanwakefield.com)