

3000

WESTON PARKWAY



FULL BUILDING, SINGLE TENANT OPPORTUNITY



[HOME](#)

[HIGHLIGHTS](#)

[FLOORPLAN](#)

[AMENITIES](#)

[LOCATION](#)

3000 WESTON PARKWAY



HOME

HIGHLIGHTS

FLOORPLAN

AMENITIES

LOCATION



» Full building second generation lab available in move-in ready condition

» 30,369 SF

» Convenient to I-40 in Cary

» Single story structure

» 3.2/1,000 parking ratio

» Dock-high loading with a leveler

» Dedicated chemical storage area

» Natural gas

» Water purification system

» Electrical -

» Duke Energy

» 1,600-amps, 277/480-volt, three-phase, four-wire

» Two diesel-powered, 250-kW, back-up emergency generators

3000 WESTON PARKWAY



HOME

HIGHLIGHTS

FLOORPLAN

AMENITIES

LOCATION



OPEN OFFICE SPACE



DOCK-HIGH LOADING



BREAK ROOM

3000 WESTON PARKWAY



HOME

HIGHLIGHTS

FLOORPLAN

AMENITIES

LOCATION

30,369 Square Feet

Lab



Utility



Loading Area



Office

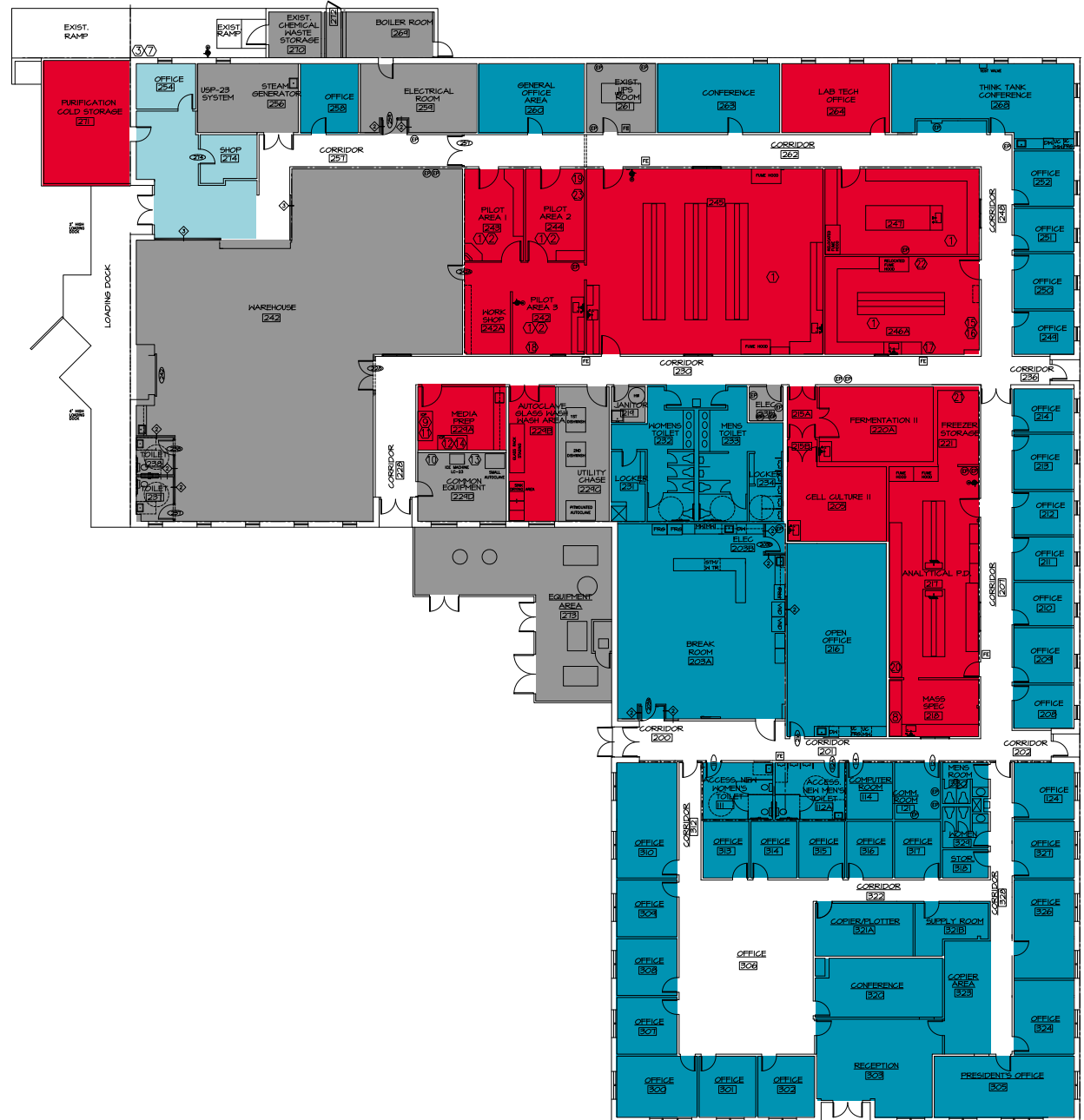

3000 WESTON PARKWAY

HOME

HIGHLIGHTS

FLOORPLAN

AMENITIES

LOCATION

Local Amenities

Amenities within 2 miles



- | | |
|-----------------------------|-----------------------------|
| 1. Staples | 16. Wendy's |
| 2. Discount Tire | 17. Arby's |
| 3. Pet Supermarket | 18. Starbucks |
| 4. Sunglass Hut | 19. Starbucks |
| 5. Bass Pro Shops | 20. Chick-fil-A |
| 6. Lidl | 21. Burger King |
| 7. Dogtopia | 22. Moe's Southwest Grill |
| 8. Harris Teeter | 23. Taco Bell |
| 9. Ruth's Chris Steak House | 24. Tropical Smoothie Café |
| 10. Bonefish Grill | 25. Firehouse Subs |
| 11. BurgerFi | 26. Zaxby's |
| 12. Cold Stone Creamery | 27. Extended Stay America |
| 13. Papa John's | 28. Embassy Suites Hotels |
| 14. Subway | 29. The Umstead Hotel & Spa |
| 15. McDonald's | 30. Hilton Garden Inn |

KEY

- Restaurants
- Hotels
- Retail

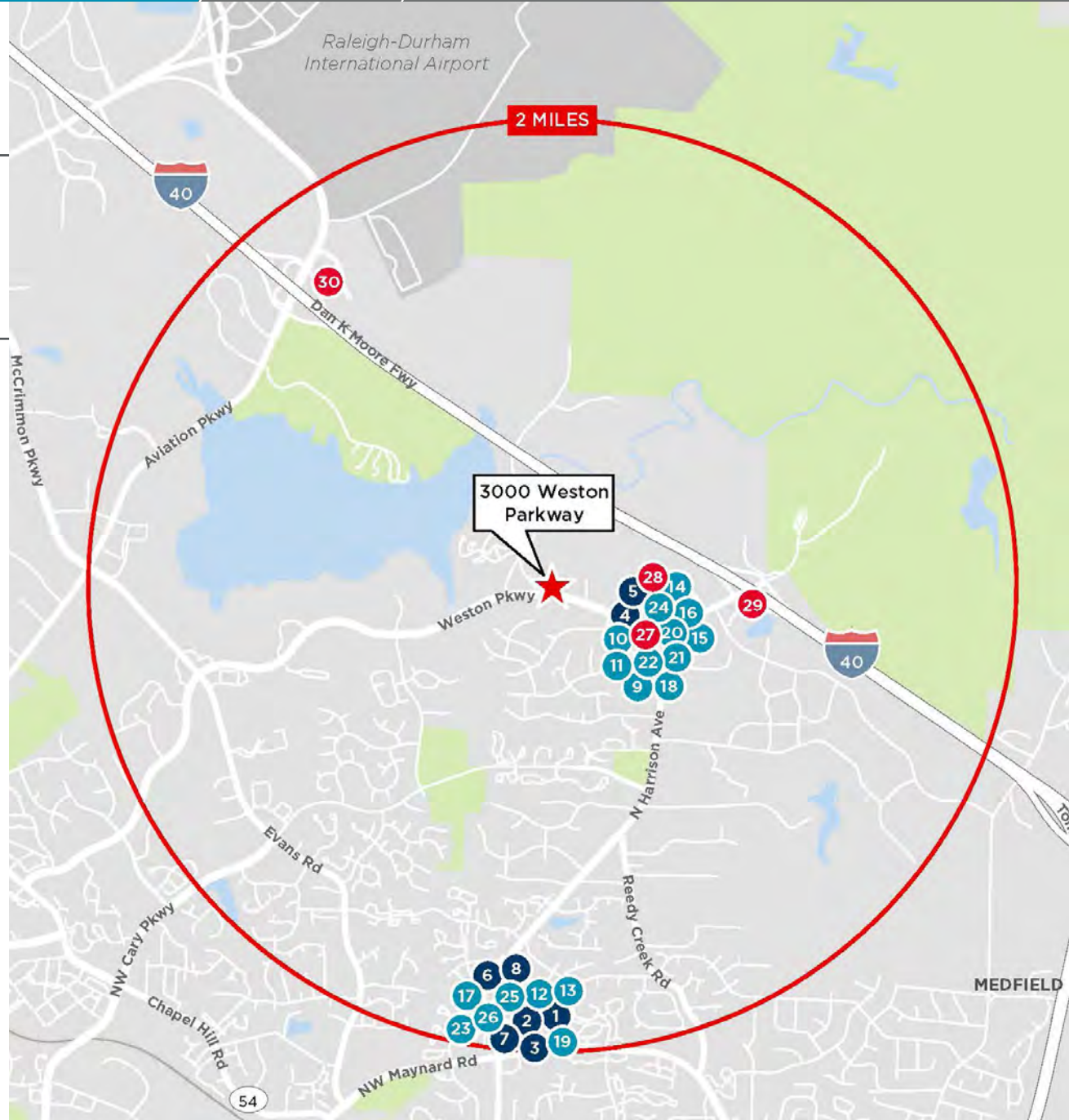

3000 WESTON PARKWAY

HOME

HIGHLIGHTS

FLOORPLAN

AMENITIES

LOCATION

WHY CARY?



RANKED #1 SAFEST PLACE IN US

CARY ECONOMIC DEVELOPMENT



RANKED #1 'MOST RESILIENT' ECONOMY IN THE NATION

CARY ECONOMIC DEVELOPMENT



HOME TO THE NEWEST MIXED USE DEVELOPMENT, FENTON

CARY LIVING



RANKED A TOP CITY TO ATTRACT CORPORATE HEADQUARTERS

CARY ECONOMIC DEVELOPMENT



RANKED #2 FASTEST-GROWING METRO IN THE US

CARY ECONOMIC DEVELOPMENT



Owned By:



Leased By:



For more information, please contact:

DOUG COOK
Managing Director
+1 919 439 5158
doug.cook@cushwake.com

Operated By:

WEXFORD
SCIENCE+TECHNOLOGY

SUZANNA NICHOLS
Senior Associate
+1 919 306 2275
suzanna.nichols@cushwake.com

©2023 Cushman & Wakefield. All rights reserved. The information contained in this communication is strictly confidential. This information has been obtained from sources believed to be reliable but has not been verified. No warranty or representation, express or implied, is made as to the condition of the property (or properties) referenced herein or as to the accuracy or completeness of the information contained herein, and same is submitted subject to errors, omissions, change of price, rental or other conditions, withdrawal without notice, and to any special listing conditions imposed by the property owner(s). Any projections, opinions or estimates are subject to uncertainty and do not signify current or future property performance.