

1,864 RSF & 2,713 RSF AVAILABLE

BOARDWALK OFFICE PARK

748 WHALERS WAY, SUITE 1A & SUITE 1B
FORT COLLINS, CO 80525



BOARDWALK OFFICE PARK

748 Whalers Way, Suite 1A & Suite 1B
Fort Collins, CO 80525

PROPERTY HIGHLIGHTS

- Patio
- Lake View
- Fireplace
- Clean, Modern Office Space
- Common Conference Room Gym Amenities
- Top Tier Common Area with Kitchen
- Private Restrooms
- Available Fully Furnished

BUILDING HIGHLIGHTS

Building Size	13,100 SF	Parking	4 : 1,000 SF (Non-dedicated)
Renovated	2006	Site Size	0.19 Acre

LEASE RATE: \$16.00/SF NNN
NNN: \$12.13/SF (2024)

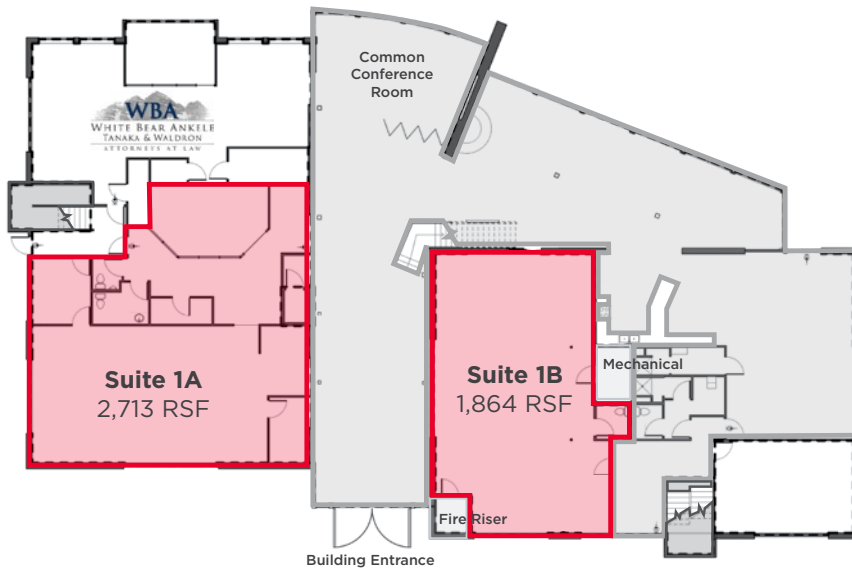

BOARDWALK OFFICE PARK

748 Whalers Way, Suite 1A & Suite 1B
Fort Collins, CO 80525



DEMOGRAPHICS	1 Mile	3 Miles	5 Miles
2023 Population	10,047	94,886	168,321
2028 Population Projection	10,217	96,642	172,118
2023 Households	5,108	39,243	68,034
2028 Households Projection	5,223	40,022	69,673
Avg. Household Income	\$97,994	\$103,525	\$94,226
Daytime Population	12,124	52,061	96,626

Source: CoStar, 2023



FOR MORE INFORMATION, CONTACT:

COLE HERK, CCIM

Director

+1 970 267 7726

cole.herk@cushwake.com

JAMES ARNOLD

Senior Associate

+1 720 354 2059

james.arnold@cushwake.com

772 Whalers Way, Suite 200

Fort Collins, Colorado 80525

T +1 970 776 3900

F +1 970 267 7419

cushmanwakefield.com



©2024 Cushman & Wakefield. All rights reserved. The information contained in this communication is strictly confidential. This information has been obtained from sources believed to be reliable but has not been verified. NO WARRANTY OR REPRESENTATION, EXPRESS OR IMPLIED, IS MADE AS TO THE CONDITION OF THE PROPERTY (OR PROPERTIES) REFERENCED HEREIN OR AS TO THE ACCURACY OR COMPLETENESS OF THE INFORMATION CONTAINED HEREIN, AND SAME IS SUBMITTED SUBJECT TO ERRORS, OMISSIONS, CHANGE OF PRICE, RENTAL OR OTHER CONDITIONS, WITHDRAWAL WITHOUT NOTICE, AND TO ANY SPECIAL LISTING CONDITIONS IMPOSED BY THE PROPERTY OWNER(S). ANY PROJECTIONS, OPINIONS OR ESTIMATES ARE SUBJECT TO UNCERTAINTY AND DO NOT SIGNIFY CURRENT OR FUTURE PROPERTY PERFORMANCE.