

**FINANCE  
BUILDING**  
APARTMENTS 621-6390

**CUSHMAN &  
WAKEFIELD**

**CRESCO**  
Real Estate

RISE UP.  
TAKE CHARGE.

2 FLAVORS

SPALDING

Bank of America

811

**POINTE AT GATEWAY**  
750-820 Prospect Ave, Cleveland, Ohio 44115



# POINTE AT GATEWAY

- One of Cleveland's most recognizable buildings
- Located in the heart of the Gateway District
- Walking distance to downtown Cleveland amenities
- Possible rooftop/entertainment patio opportunity
- Premier visibility and signage
- Beam/brick creative prime space

## AVAILABLE SPACE

Building	Floor	Size	Rent
800 - 820 Prospect	Second Floor	9,200 SF	\$15.95/SF NNN
750 Prospect	Lower Level	2,987 SF	\$12.00/SF NNN

## NEIGHBORING TENANTS

- Winking Lizard
- Barrio
- Red the Steakhouse
- House of Blues
- Heinen's
- East 4th Street
- Rocket Mortgage Fieldhouse
- Progressive Field

# POINTE AT GATEWAY

## RENDERING POTENTIAL



Glamour Entryway

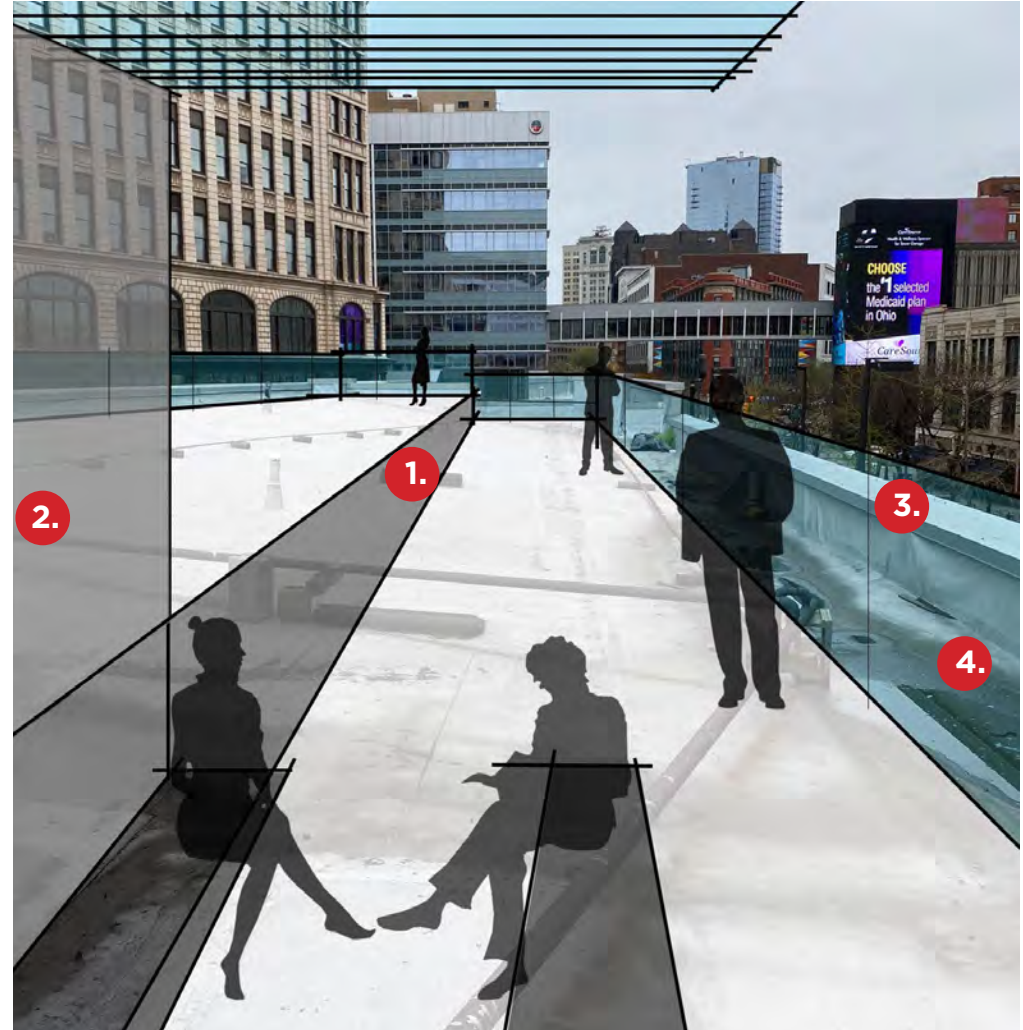

Rooftop Terrace Layout





# POINTE AT GATEWAY

CONCOURSE & GROUND LEVELS

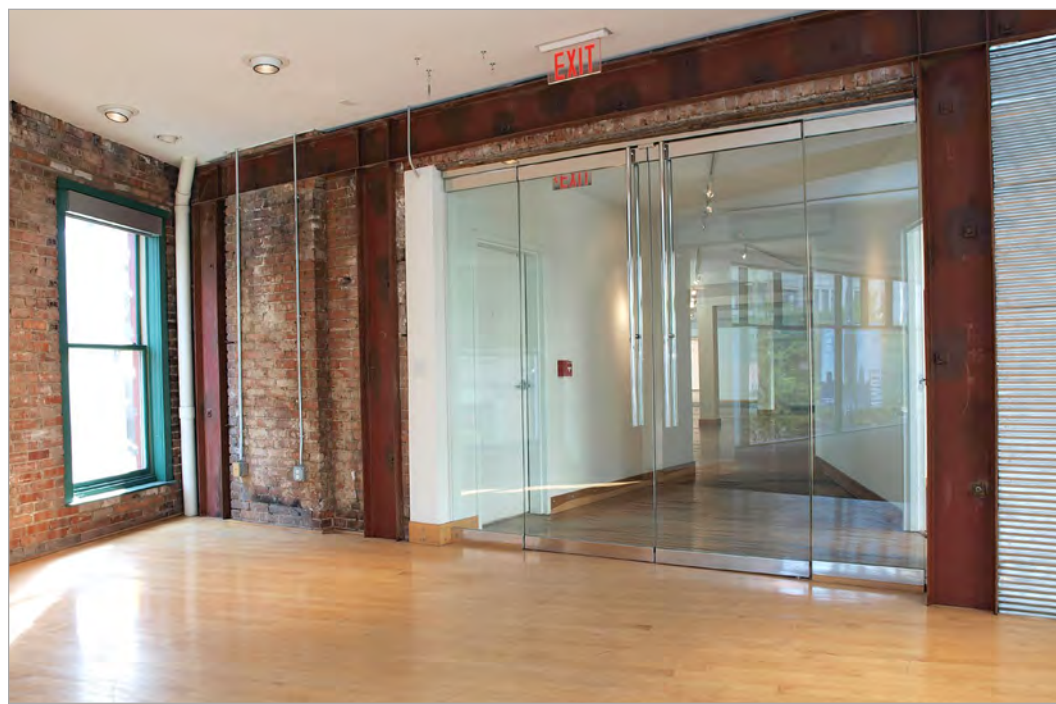

# POINTE AT GATEWAY

## GATEWAY DISTRICT



**EAST 4th**  
Go Fourth

**GOMA**

**Zocalo**

**MABEL'S BBQ**

**Butcher & Brewer**

**PHOENIX**

**Hampton**

**no bon pain**

**X-GUYS PIZZA Co.**

**DAVE'S CUSTARD SUE'S**

**SHAKE SHACK**

**MARBLE ROOM**

**CVS pharmacy**

**HEMENS**

**GEIGERS**

**HUNTINGTON**

**PNC**

**DG%**

**ideastream**

**CROWN PLAZA**

**Cowell & Hubbard**

**DYNAMITE DISTRICT**

**CIBREO**

**HOUSE**

**JUEL cafe**

**COMFORT INN**

750-820 Prospect Avenue



# POINTE AT GATEWAY

CBD



Logos for North Coast Harbor, Nuevo, RTA, AMTRAK, and Rock & Dock at North Coast Harbor.

Logos for Warehouse, Johnny's, Hallorcas, Mermaid, Dino Palmieri, Surroundings Home Décor, Cleveland Chop, and Drop Bar.

Logos for Aloft, Bold, Flats East Bank, Margaritaville, FWD, and Lindey's Lake House.

**SHERWIN WILLIAMS** New Global HQ 2024 occupancy

Logos for various community and business organizations including Shodor's, Music Box, and Nautica.

Logos for Tower City Center, Renaissance, Jack Cleveland, and Muehlen's.

Logos for East 4th, Goma, Zoclo, and other businesses in the East 4th area.

Logos for Galleria at Erieview and The Y.

Logos for IdeaStream, Crowne Plaza, Cibiéo, and various theaters including Allen Theatre and Hanna Theatre.

Logos for CVS, heinens, Alex Theater, Geiger's, and various food and retail businesses in the Gateway District.

2

2

77

90

Lutheran Hospital  
Cleveland Clinic Hospital



# POINTE AT GATEWAY

750-820 Prospect Ave, Cleveland, Ohio 44115



## RICO A. PIETRO, SIOR

Principal

[rpietro@crescorealestate.com](mailto:rpietro@crescorealestate.com)

+1 216 525 1473

## KIRSTEN PARATORE

Associate

[kparatore@crescorealestate.com](mailto:kparatore@crescorealestate.com)

+1 216 525 1491

6100 Rockside Woods Blvd, Suite 200

Cleveland, Ohio 44131

+1 216 520 1200

[crescorealestate.com](http://crescorealestate.com)



*Independently Owned and Operated / A Member of the Cushman & Wakefield Alliance*

Cushman & Wakefield Copyright 2023. No warranty or representation, express or implied, is made to the accuracy or completeness of the information contained herein, and same is submitted subject to errors, omissions, change of price, rental or other conditions, withdrawal without notice, and to any special listing conditions imposed by the property owner(s). As applicable, we make no representation as to the condition of the property (or properties) in question. A licensee at Cushman & Wakefield | CRESCO may have an interest in the client entity offering this property for sale.