

**FOR
LEASE**

1950 5TH STREET

NORCO, CALIFORNIA 92860

±13,514 SF Industrial Space



For more information, please contact:

Chris Pimentel
+1 909 942 4600
chris.pimentel@cushwake.com
Lic. No: 02207632

Tim Pimentel, SIOR
+1 909 942 4647
tim.pimentel@cushwake.com
Lic. No: 01421452



901 Via Piemonte, Suite 200
Ontario, California 91764
cushmanwakefield.com



Property Features



13,514 SF Industrial Building



1 Dock High Loading Door



Excellent I-15 Freeway access



3,500 SF Office Space



1 Grade Level Loading Door



20' Clear Height



400 Amp Building Service (480/277 Volt, 3-Phase)

©2024 Cushman & Wakefield. This information has been obtained from sources believed to be reliable but has not been verified. No warranty or representation, express or implied, is made as to the condition of the property (or properties) referenced herein or as to the accuracy or completeness of the information contained herein, and same is submitted subject to errors, omissions, change of price, rental or other conditions, withdrawal without notice, and to any special listing conditions imposed by the property owner(s).

1950 5TH STREET

NORCO , CALIFORNIA 92860

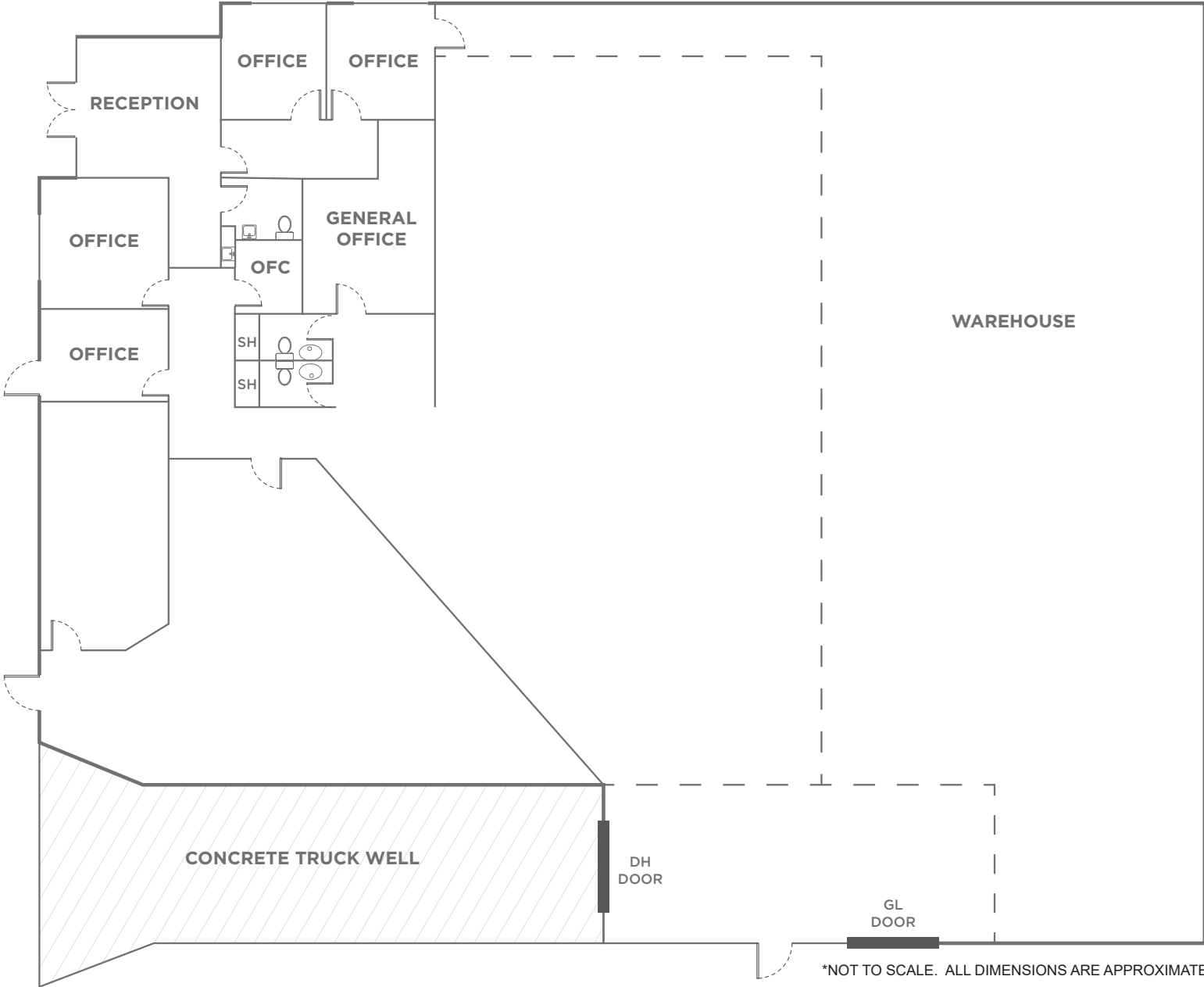

©2024 Cushman & Wakefield. This information has been obtained from sources believed to be reliable but has not been verified. No warranty or representation, express or implied, is made as to the condition of the property (or properties) referenced herein or as to the accuracy or completeness of the information contained herein, and same is submitted subject to errors, omissions, change of price, rental or other conditions, withdrawal without notice, and to any special listing conditions imposed by the property owner(s).

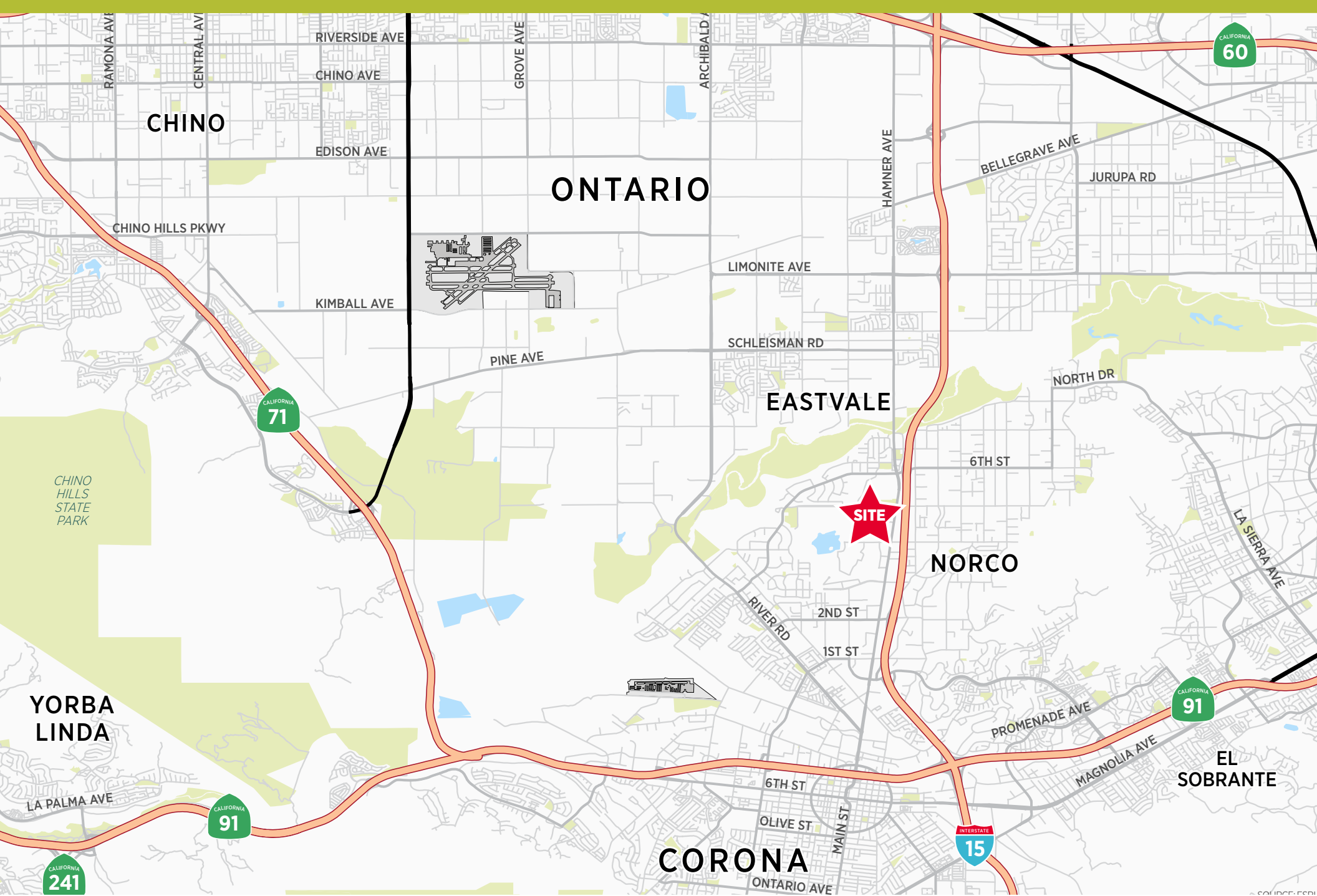

Chris Pimentel
 +1 909 942 4600
 chris.pimentel@cushwake.com
 Lic. No: 02207632

Tim Pimentel, SIOR
 +1 909 942 4647
 tim.pimentel@cushwake.com
 Lic. No: 01421452



901 Via Piemonte, Suite 200
 Ontario, California 91764
 cushmanwakefield.com