



# FOR LEASE

PRIME SANTA CRUZ OFFICE SUITE - FOR LEASE

## 110 Cooper Street #202

Santa Cruz, CA



### ±2,597 RSF Class A Office Space Available

#### Property Highlights

- Iconic Building
- Premier Location - Corner of Pacific Ave & Cooper St
- High Speed Data Communications Available
- Excellent Views - Convenient Access to Downtown Services

#### Available Suite

Suite 202                      ±2,597 RSF                      \$1.65 PSF, NNN

\*\*NNN's estimated at ±\$0.92 PSF - Includes Utilities



**Reuben Helick**  
Managing Director  
+1 831 647 2109  
reuben.helick@cushwake.com  
LIC #01171272

**Nick Greenup**  
Associate  
+1 831 647 2106  
nicholas.greenup@cushwake.com  
LIC #02143358

Doud Arcade Building, Suite #202  
South Ocean Avenue  
P.O. Box 999  
Carmel-by-the Sea, CA 93921  
main +1 831 375 8000  
**cushmanwakefield.com**



PRIME SANTA CRUZ OFFICE SUITE - FOR LEASE  
**110 Cooper Street #202**  
Santa Cruz, CA

## Exterior Pictures



**Reuben Helick**  
Managing Director  
+1 831 647 2109  
reuben.helick@cushwake.com  
LIC #01171272

**Nick Greenup**  
Associate  
+1 831 647 2106  
nicholas.greenup@cushwake.com  
LIC #02143358

Doud Arcade Building, Suite #202  
South Ocean Avenue  
P.O. Box 999  
Carmel-by-the Sea, CA 93921  
main +1 831 375 8000  
**cushmanwakefield.com**



PRIME SANTA CRUZ OFFICE SUITE - FOR LEASE  
**110 Cooper Street #202**  
Santa Cruz, CA

## Second Floor Interior Pictures



**Reuben Helick**  
Managing Director  
+1 831 647 2109  
reuben.helick@cushwake.com  
LIC #01171272

**Nick Greenup**  
Associate  
+1 831 647 2106  
nicholas.greenup@cushwake.com  
LIC #02143358

Doud Arcade Building, Suite #202  
South Ocean Avenue  
P.O. Box 999  
Carmel-by-the Sea, CA 93921  
main +1 831 375 8000  
**cushmanwakefield.com**

**Floor Plan**

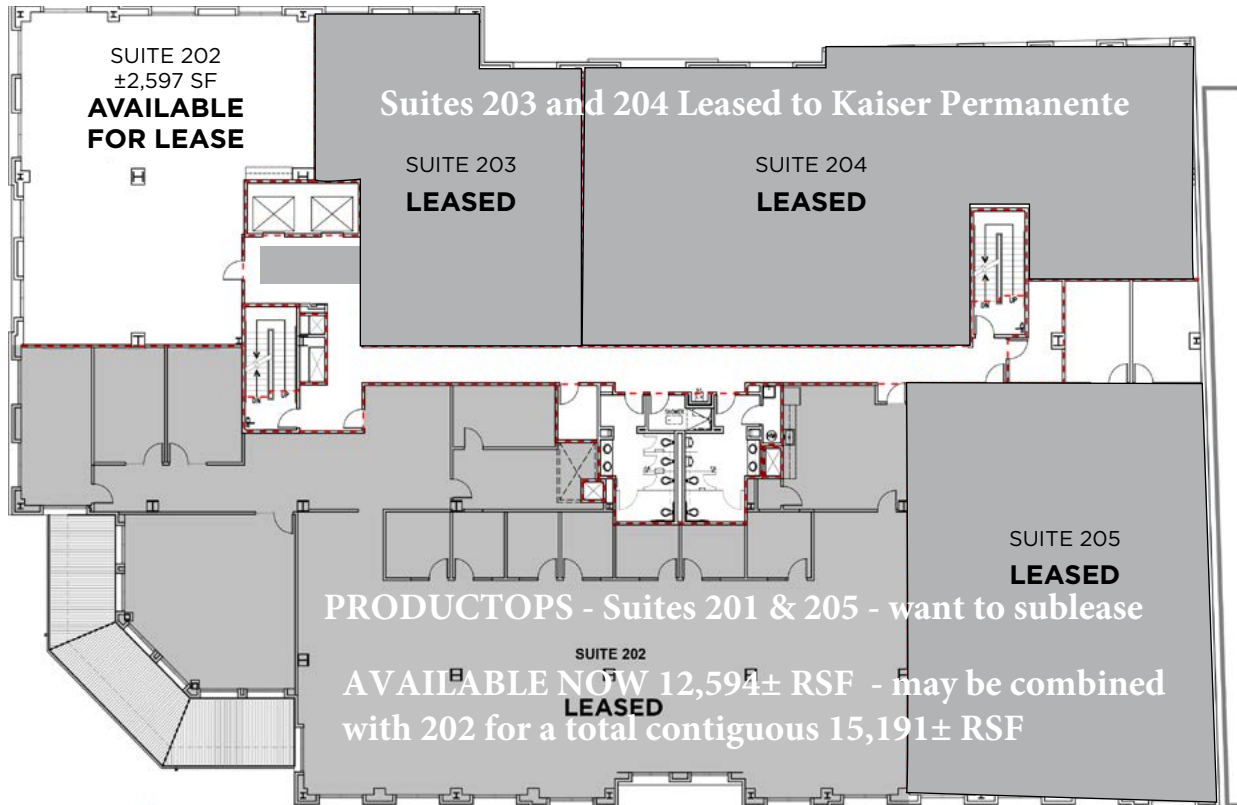

**Reuben Helick**  
Managing Director  
+1 831 647 2109  
reuben.helick@cushwake.com  
LIC #01171272

**Nick Greenup**  
Associate  
+1 831 647 2106  
nicholas.greenup@cushwake.com  
LIC #02143358

Doud Arcade Building, Suite #202  
South Ocean Avenue  
P.O. Box 999  
Carmel-by-the Sea, CA 93921  
main +1 831 375 8000  
**cushmanwakefield.com**