



ARES  
INDUSTRIAL  
MANAGEMENT

# WELLS ROAD DISTRIBUTION CENTER

600 WELLS ROAD, ORANGE PARK, FLORIDA 32073

283,301 LEASEABLE SQ FT | AVAILABLE Q1 2024



## BUILDING HIGHLIGHTS

<b>LEASABLE SPACE:</b>	283,301 SF	<b>SPRINKLERS:</b>	Wet
<b>OFFICE SF:</b>	30,600 SF	<b>YEAR BUILT:</b>	1974 / Renovated 1999
<b>LAND:</b>	35.58 Acres	<b>COLUMNS:</b>	45'w x 45'd
<b>CLEAR HEIGHT:</b>	30'	<b>AUTO PARKING:</b>	477
<b>DOCKS:</b>	32	<b>TRAILER PARKING:</b>	37
<b>DRIVE-INS:</b>	2	<b>ZONING:</b>	CI
<b>TRUCK COURT:</b>	143'	<b>POWER:</b>	2,500a/488v 3p 4w Heavy

TYLER NEWMAN

Executive Director  
+1 904 380 8336

[tyler.newman@cushwake.com](mailto:tyler.newman@cushwake.com)

JACOB HORSLEY

Executive Director  
+1 904 380 8335

[jacob.horsley@cushwake.com](mailto:jacob.horsley@cushwake.com)





ARES  
INDUSTRIAL  
MANAGEMENT

# WELLS ROAD DISTRIBUTION CENTER

600 WELLS ROAD, ORANGE PARK, FLORIDA 32073

283,301 LEASEABLE SQ FT | AVAILABLE Q1 2024

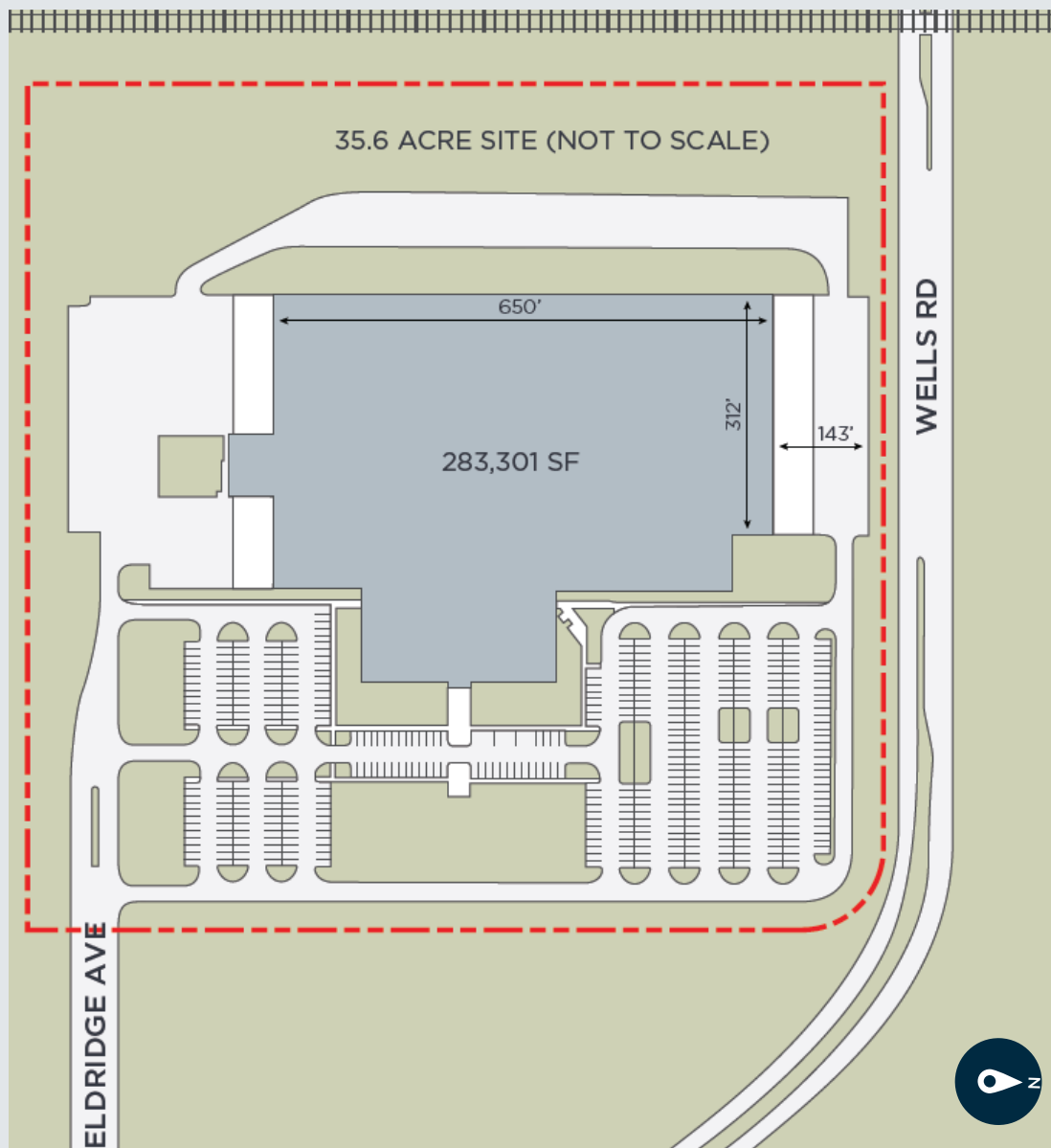

TYLER NEWMAN

Executive Director

+1 904 380 8336

tyler.newman@cushwake.com

JACOB HORSLEY

Executive Director

+1 904 380 8335

jacob.horsley@cushwake.com

