

FOR LEASE

300 Park Street

Birmingham, Michigan



One of Birmingham's most prestigious buildings located in the heart of downtown



Property Highlights

- Approximately 1,343 SF office space available
- Recent lobby and common area renovations
- High visibility on Woodward Avenue
- Covered parking available in addition to municipal parking
- **Asking Rate:** \$31.50/SF Gross plus electric

Available	Total SF
Suite 285	1,343

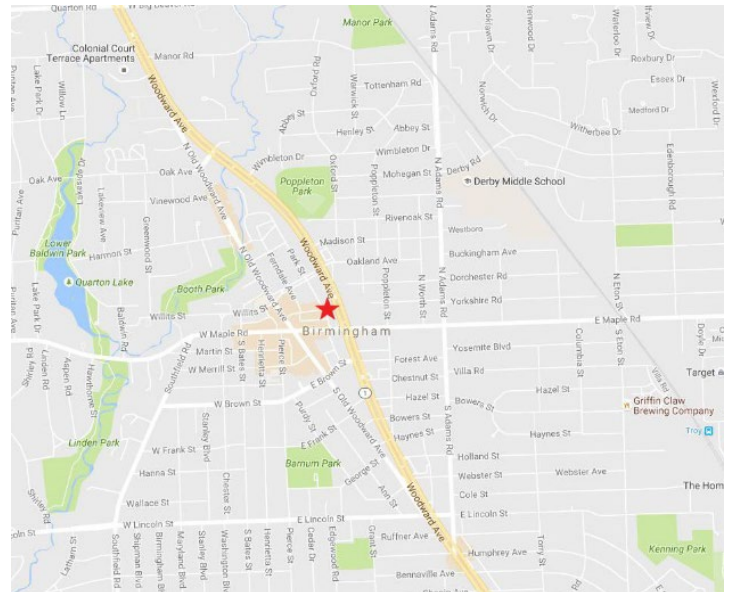

Garrett Keais
Executive Managing Director
+1 248 358 6112
garrett.keais@cushwake.com

John VanNoord
Senior Associate
+1 248 358 6106
john.vannoord@cushwake.com

27777 Franklin Road, Suite 1050
Southfield, MI 48034
+1 248 358 6100
cushmanwakefield.com

Cushman & Wakefield Copyright 2020. No warranty or representation, express or implied, is made to the accuracy or completeness of the information contained herein, and same is submitted subject to errors, omissions, change of price, rental or other conditions, withdrawal without notice, and to any special listing conditions imposed by the property owner(s). As applicable, we make no representation as to the condition of the property (or properties) in question.

FOR LEASE

300 Park Street

Birmingham, Michigan

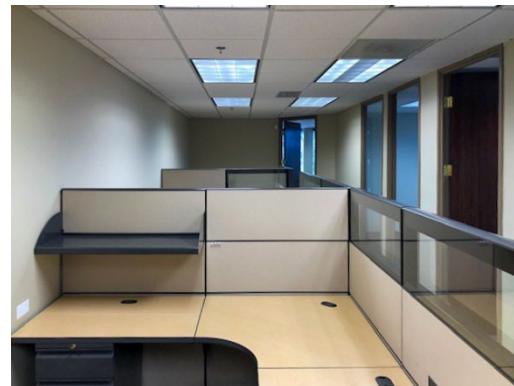

FOR LEASE

300 Park Street

Birmingham, Michigan



Second Floor
Up to 1,343 SF

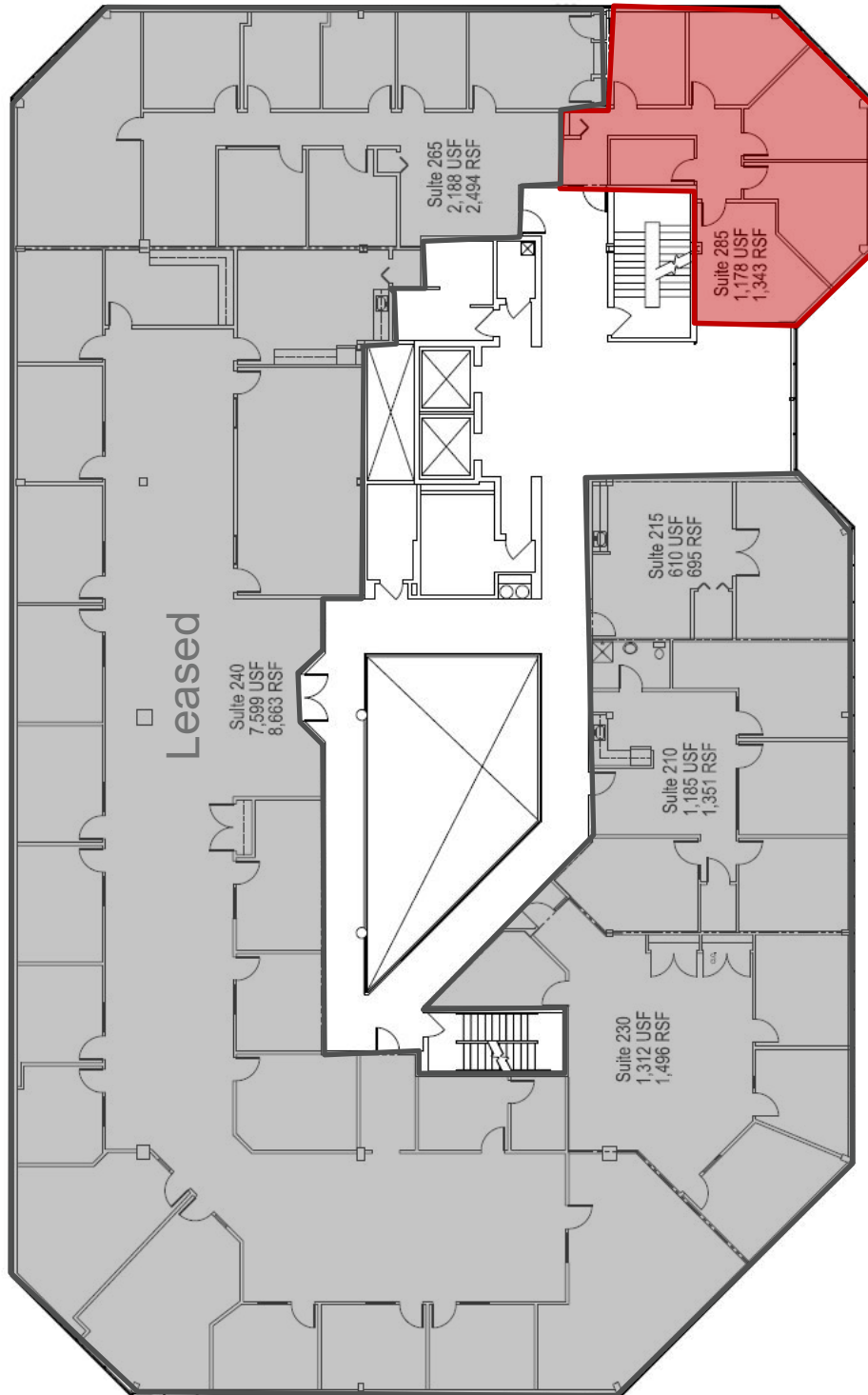

FOR LEASE

300 Park Street

Birmingham, Michigan



Suite 285
1,343 SF

