

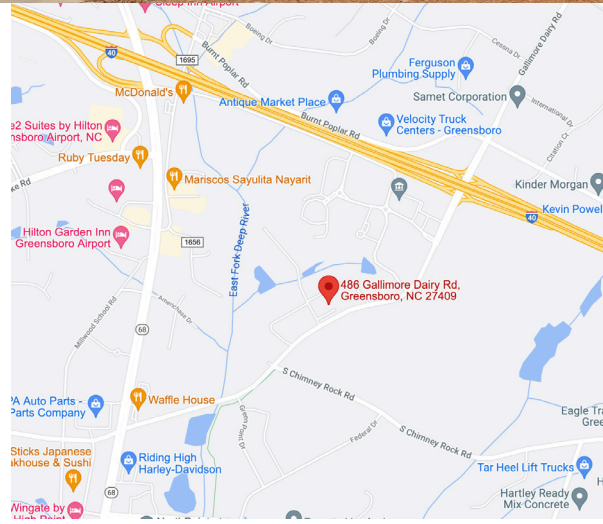

**AVAILABLE FOR SUBLEASE**

**Property Highlights**

- **30,000 SF Available for Sublease**
- \$5.65/SF NNN with 2.5% annual increases.
- Sublease expires 4/30/28.
- Highly specialized space with heavy power, and gowning/locker areas.
- Recently renovated office space.
- ESFR Sprinklers in majority of the warehouse.
- Two dock doors (8'w x 10'h), one with a pit leveler.
- One drive-in (12'w x 12'h).
- Zoned LI - Light Industrial.
- Fully conditioned.
- Centrally located in the Triad, with direct access to Highway 68 and I-40 via Gallimore Dairy Road. Piedmont Triad International Airport is within three miles.



**Ryan Conboy, SIOR**  
Senior Director  
+1 336 821 3832  
ryan.conboy@cushwake.com

**Raffi Simel, SIOR**  
Senior Associate  
+1 336 289 2541  
raffi.simel@cushwake.com

628 Green Valley Road, Suite 202  
Greensboro, NC 27408  
Main +1 336 668 9999  
Fax +1 336 668 0888  
**cushmanwakefield.com**



**FLOOR PLAN**

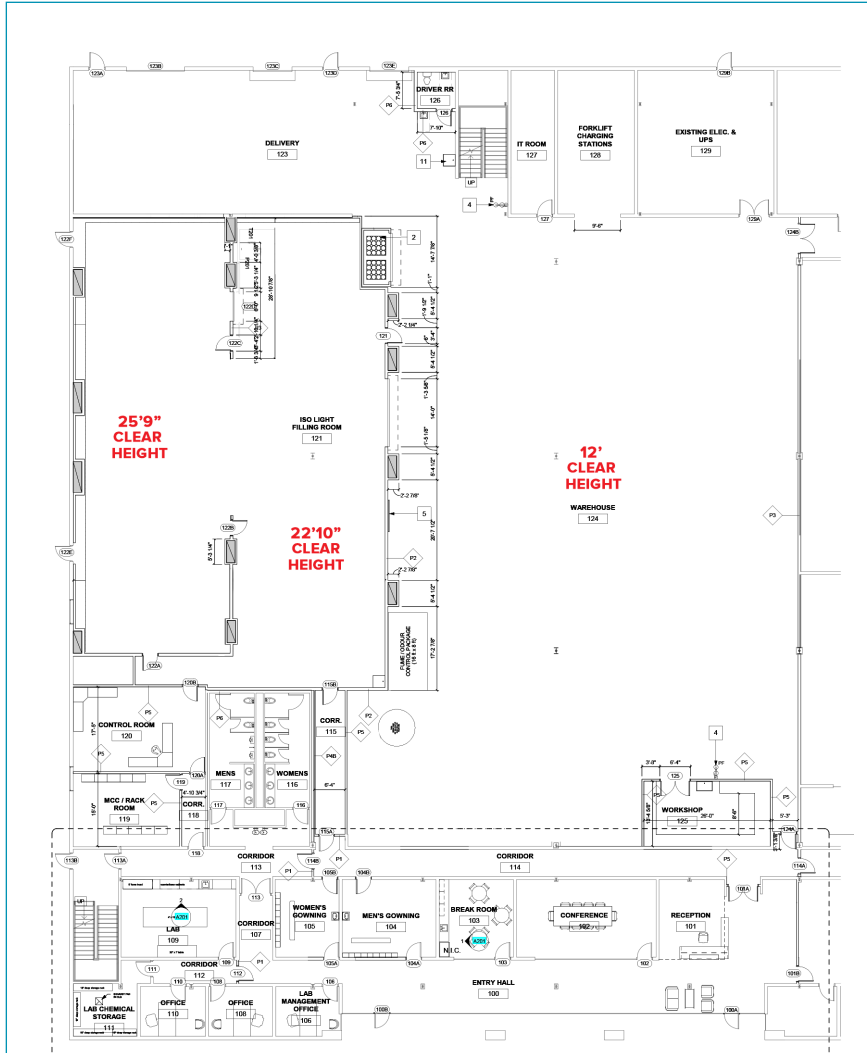

**BUILDING PHOTOS**

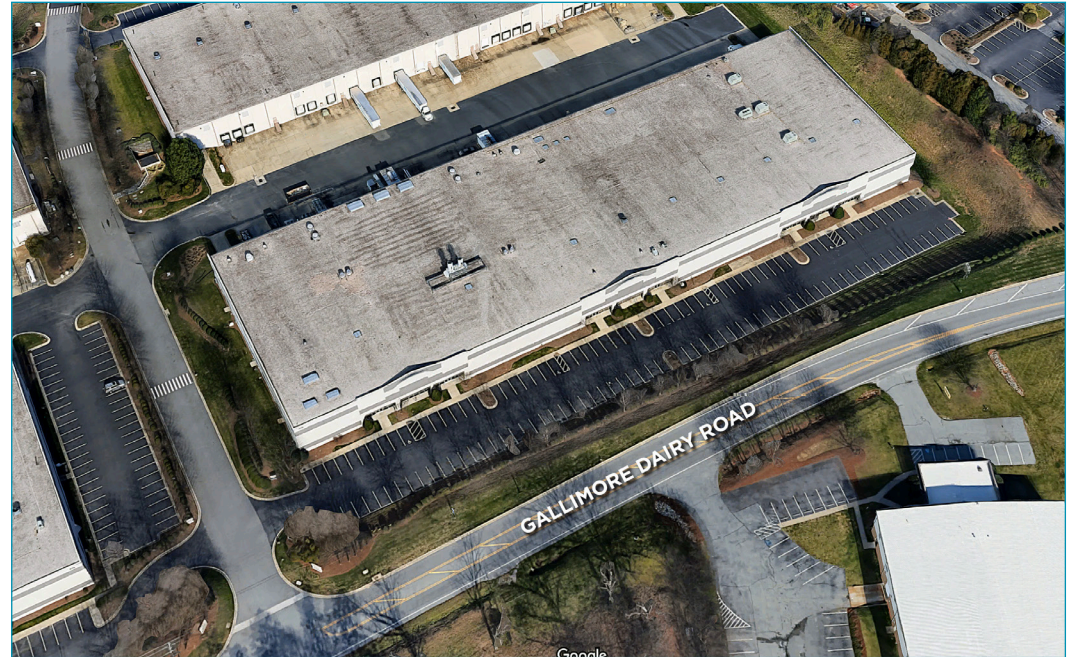

**Ryan Conboy, SIOR**  
Senior Director  
+1 336 821 3832  
ryan.conboy@cushwake.com

**Raffi Simel, SIOR**  
Senior Associate  
+1 336 289 2541  
raffi.simel@cushwake.com

628 Green Valley Road, Suite 202  
Greensboro, NC 27408 | USA  
Main +1 336 668 9999  
Fax +1 336 668 0888  
**cushmanwakefield.com**









**Ryan Conboy, SIOR**  
Senior Director  
+1 336 821 3832  
ryan.conboy@cushwake.com

**Raffi Simel, SIOR**  
Senior Associate  
+1 336 289 2541  
raffi.simel@cushwake.com

628 Green Valley Road, Suite 202  
Greensboro, NC 27408 | USA  
Main +1 336 668 9999  
Fax +1 336 668 0888  
**cushmanwakefield.com**