

FOR LEASE

Owned and Operated by



Airpark North

235 - 243 Burgess Road, Greensboro, NC 27409

± 30,400 SF



**LEASING INFO
& CONTACT**

Ryan Conboy, SIOR (336) 821-3832 / ryan.conboy@cushwake.com
Bobby Finch (336) 812-3303 / bobby.finch@cushwake.com



This is not an offer or acceptance of an offer to lease space. A lease will only be offered or made in a written agreement signed by landlord. No representation or warranty of any kind is made by landlord unless set forth in a written definitive lease executed by the landlord.

235 BURGESS ROAD

FLOOR PLAN

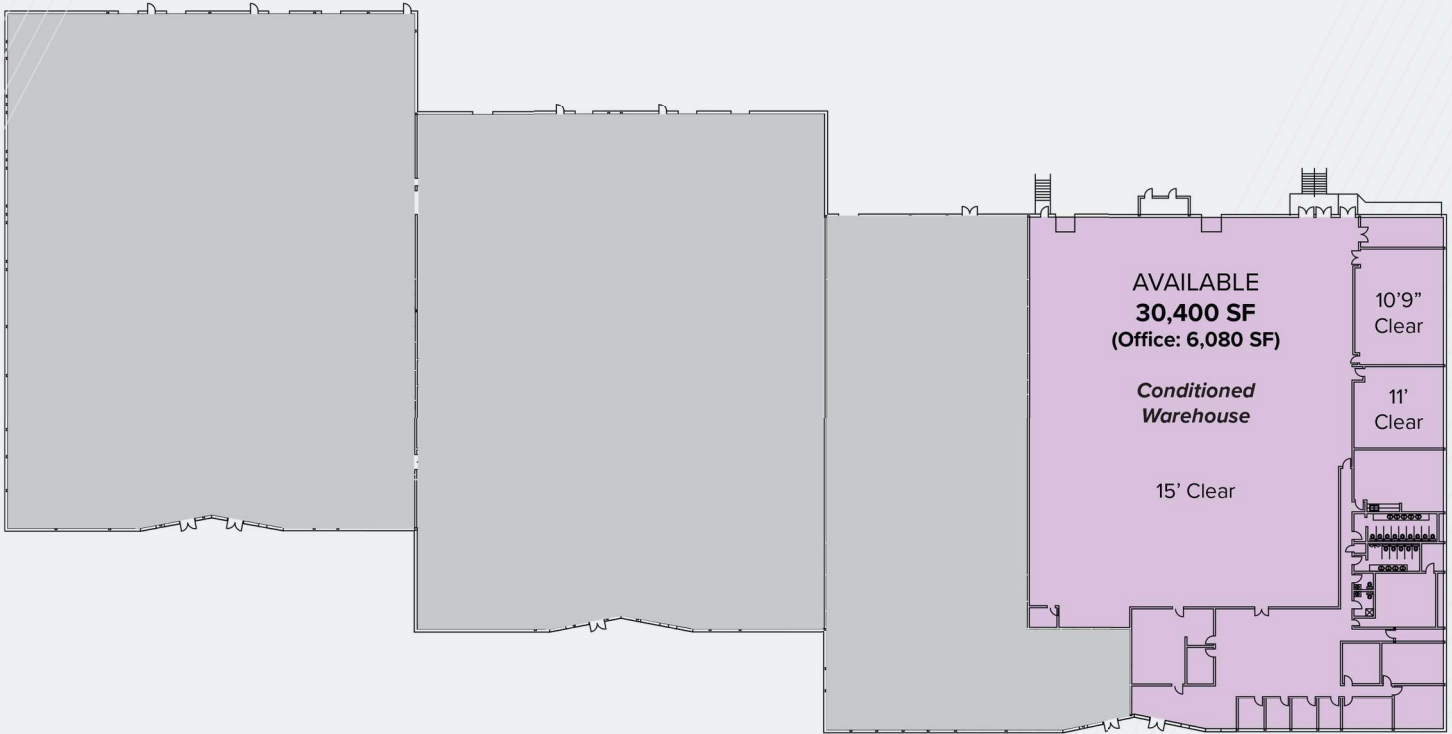

235 Burgess Road, Greensboro, NC 27409

Space: +/- 30,400 SF (+/- 6,080 SF Office)

Conditioned warehouse with drop ceiling

Clear height in the warehouse is +/- 15'

Column Spacing: 40' x 40'

Dock Doors: (2) 8' x 10' w/ Levelers

Lighting: T5 / LED

Sprinkler: Wet System

OVERVIEW

AIRPARK NORTH

CLASS A LIGHT INDUSTRIAL PARK

235, 237, 241 & 243 BURGESS ROAD
GREENSBORO, NC 27409





