

FOR SUBLEASE
5,320 SF



3455 THORNDYKE AVE W
SEATTLE, WA

3455 THORNDYKE AVE W | SEATTLE, WA

PROPERTY HIGHLIGHTS



CLICK HERE FOR
A VIRTUAL TOUR

Space Available:	5,320 SF
Site Area:	0.34 AC
Clear Height:	19'
Loading:	1 Grade Level
Parking:	Ample
Year Built:	2017
Floor:	First Floor
Sprinkler:	Yes
Additional Information:	Furniture Included
Term:	Sublease expires August 31, 2025
Lease Rate:	\$2.00/SF



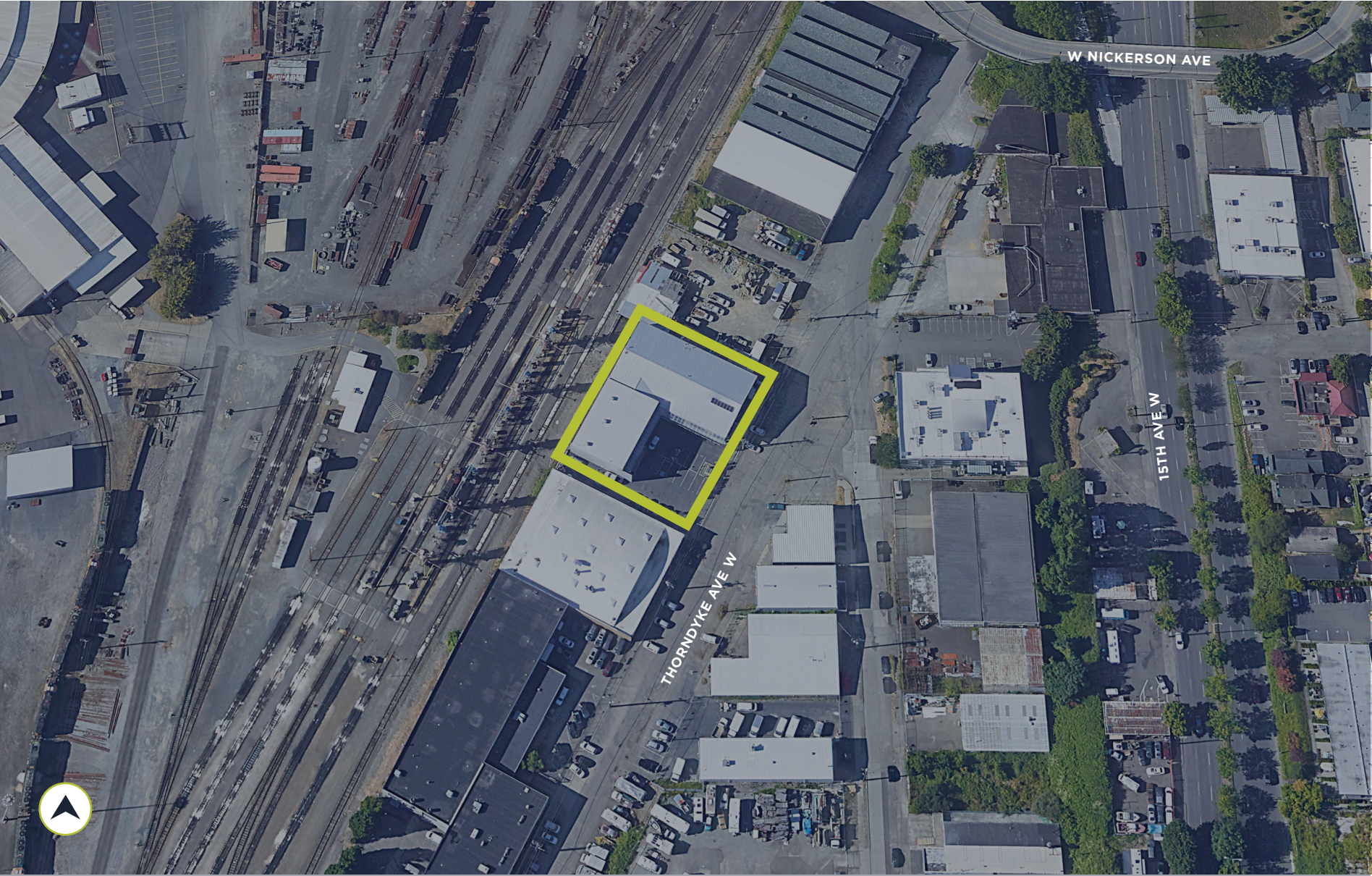

SITE PLAN
0.34 ACRES

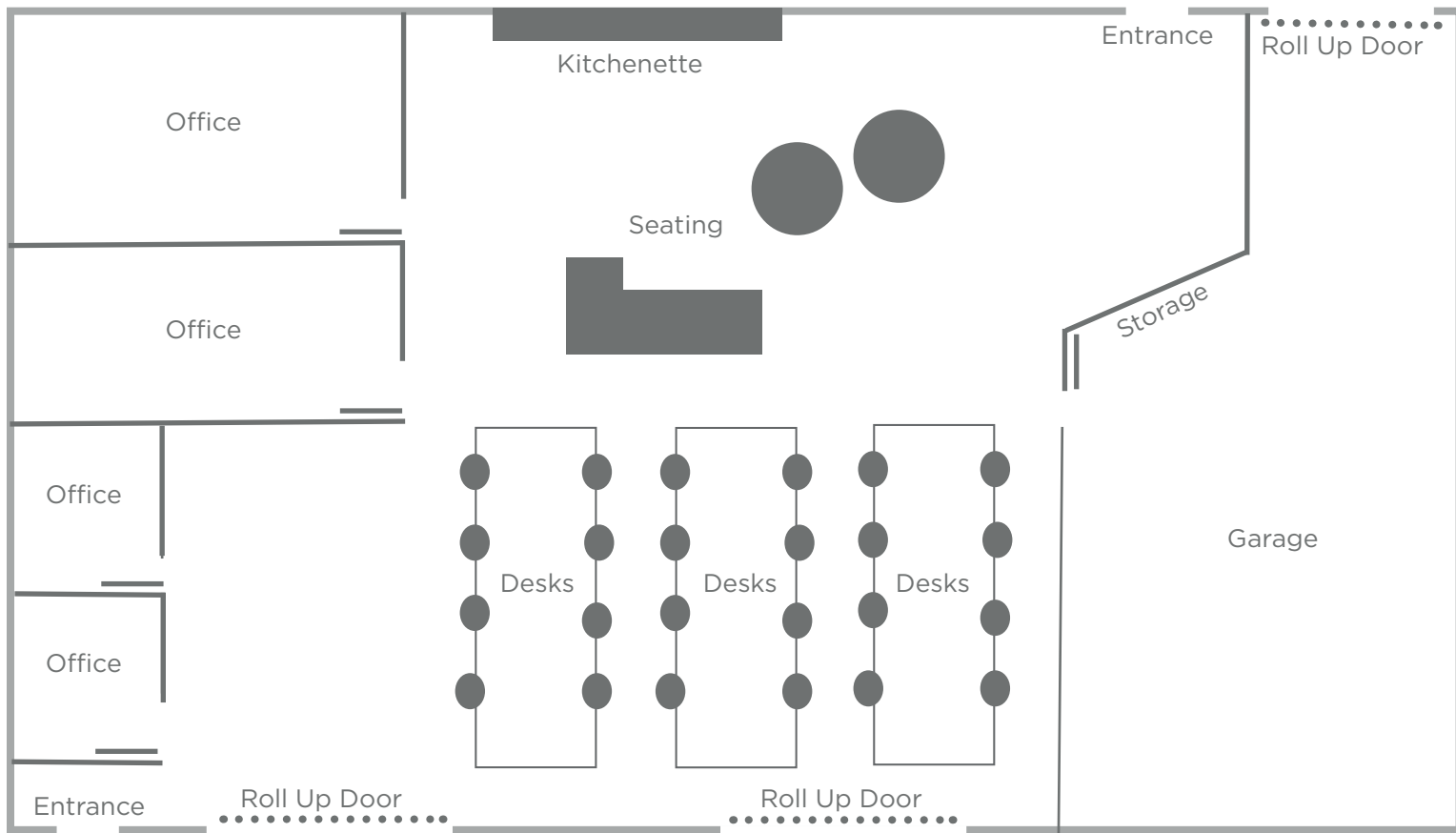

CONTACT INFORMATION

TAYLOR HUDSON

taylor.hudson@cushwake.com

+1 425 201 1205

