



711 Almondridge Drive
Rural Hall, NC 27045

21,276 SF PRIME INDUSTRIAL LOCATION | AVAILABLE FOR SUBLEASE



CONTACT INFORMATION:

WILLIAM WOLTZ

Vice Chairman

+1 336 821 3824

william.woltz@cushwake.com

SETH CONSTABLE

Senior Associate

+1 336 885 7815

seth.constable@cushwake.com

FLOORPLAN | 21,276 SF

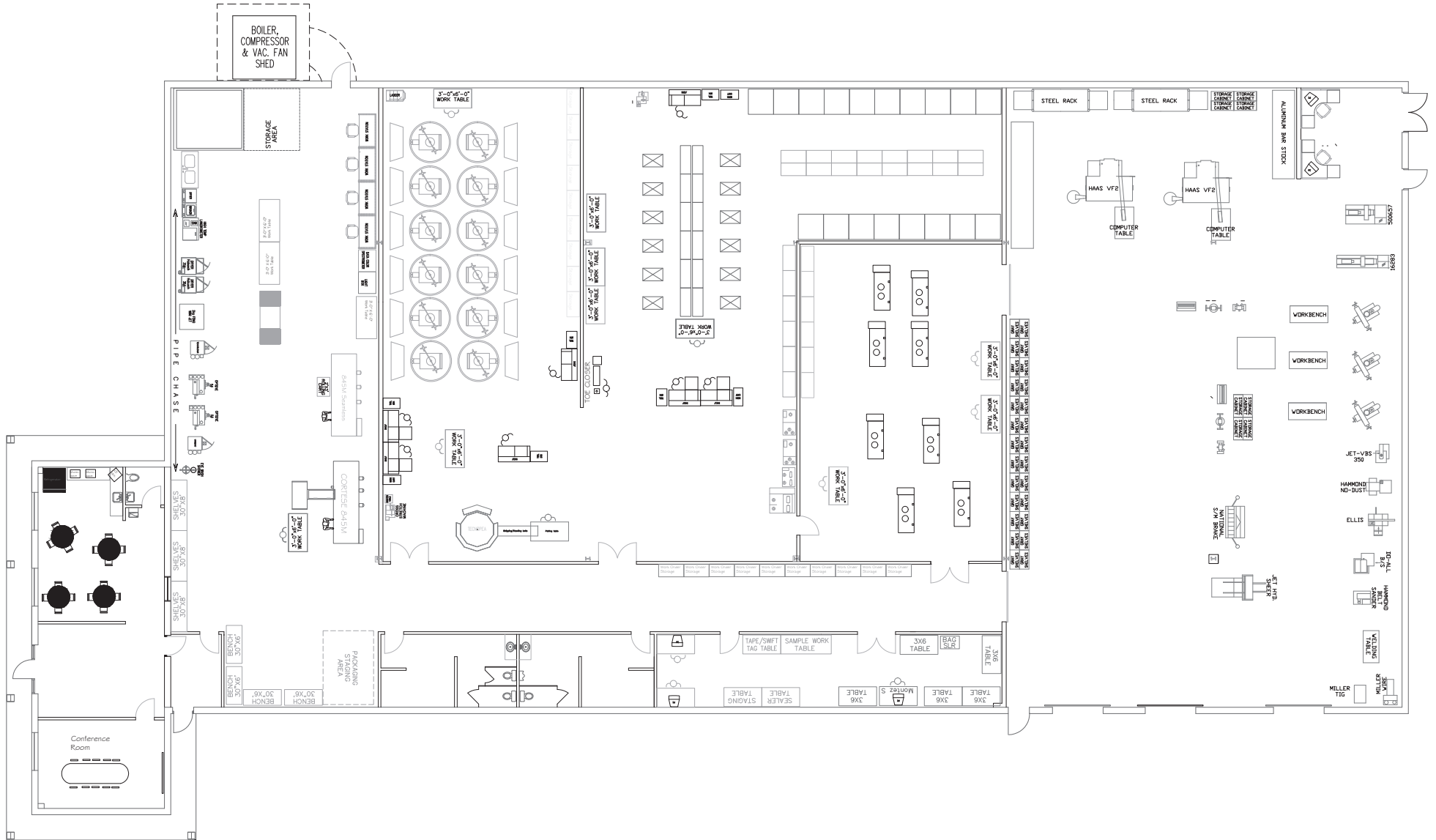

PROPERTY INFORMATION / HIGHLIGHTS

Building Size:	21,276 SF
Exterior:	12" CMU with Dryvit
Docks:	Three (3) Dock Doors
Ceiling Height:	16'
Column Spacing:	33' x 24'
Sprinkler:	Yes
Roof:	Pitched, EPDM
HVAC:	Fully Conditioned

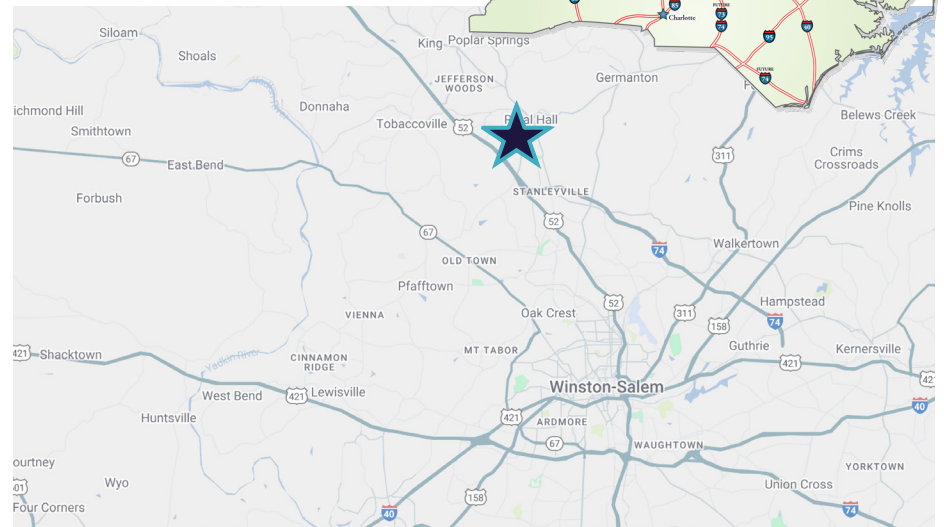

CONTACT INFORMATION:

WILLIAM WOLTZ

Vice Chairman
+1 336 821 3824
william.woltz@cushwake.com

SETH CONSTABLE

Senior Associate
+1 336 885 7815
seth.constable@cushwake.com

OFFICE ADDRESS

121-D Reynolda Village
Winston-Salem, NC 27106 | USA
cushmanwakefield.com