

SUBLEASE AVAILABLE



## Kennesaw75

3825 Kennesaw 75 Pkwy  
Bldg 200  
Kennesaw, GA 30144

71,542 SF Building

30,000 SF - 71,542 SF  
Available

1,600 SF Office

## SUBLEASE HIGHLIGHTS

- Available Now
- 16 Dock High / 2 Drive In
- Outdoor Storage Available
- Short-term lease options

### LISA PITTMAN, SIOR

Executive Director  
Office +1 404 853 5277  
Cell +1 404 309 5309  
brian.monaghan@cushwake.com

### ADAM THOMAS

Director, CCIM  
Office +1 404 853 5318  
Cell +1 770 361 2530  
adam.thomas@cushwake.com

Cushman & Wakefield  
1180 Peachtree Street NE  
Suite 3100  
Atlanta, GA 30309  
Main: +1 404 875 1000  
cushmanwakefield.com



# Kennesaw75

3825 Kennesaw 75 Pkwy  
Bldg 200  
Kennesaw, GA 30144



## INFORMATION

---

Total Available	30,000 sf - 71,542 sf
-----------------	-----------------------

---

Office Space	≈ 1,600 sf
--------------	------------

---

Dock High	16 (9' x 10')
-----------	---------------

---

Drive-Ins	2 (20' x 20')
-----------	---------------

---

Ceiling Height	28'
----------------	-----

---

Column Spacing	50' x 52'
----------------	-----------

---

Sprinkler	ESFR
-----------	------

---

Parking	96 Parking Spaces
---------	-------------------

---

Additional Parking	67 Parking Spaces
--------------------	-------------------

---

Outside Storage	Available
-----------------	-----------

---

Type of Roof	R-20 Roof Insulation
--------------	----------------------

---

# Kennesaw75

3825 Kennesaw 75 Pkwy  
 Bldg 200  
 Kennesaw, GA 30144



## WAREHOUSE

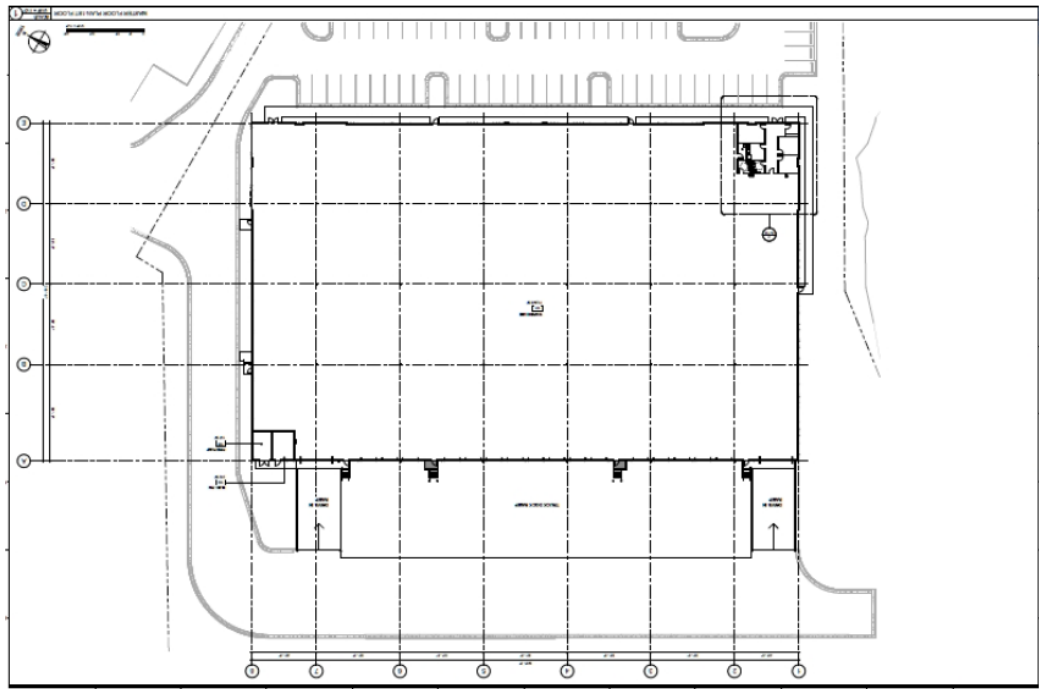

## OFFICE

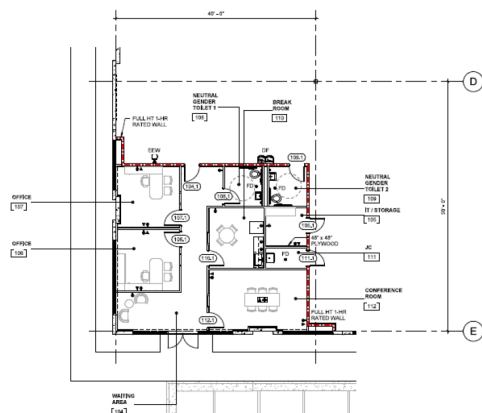

## ADDITIONAL PARKING

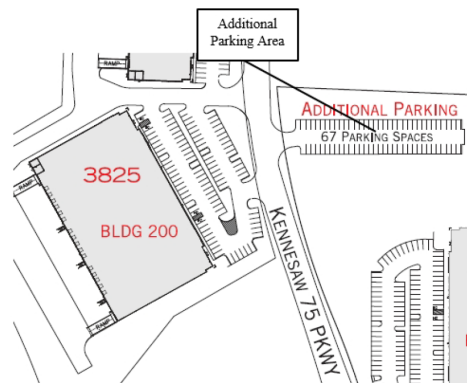

# Kennesaw75

3825 Kennesaw 75 Pkwy  
Bldg 200  
Kennesaw, GA 30144

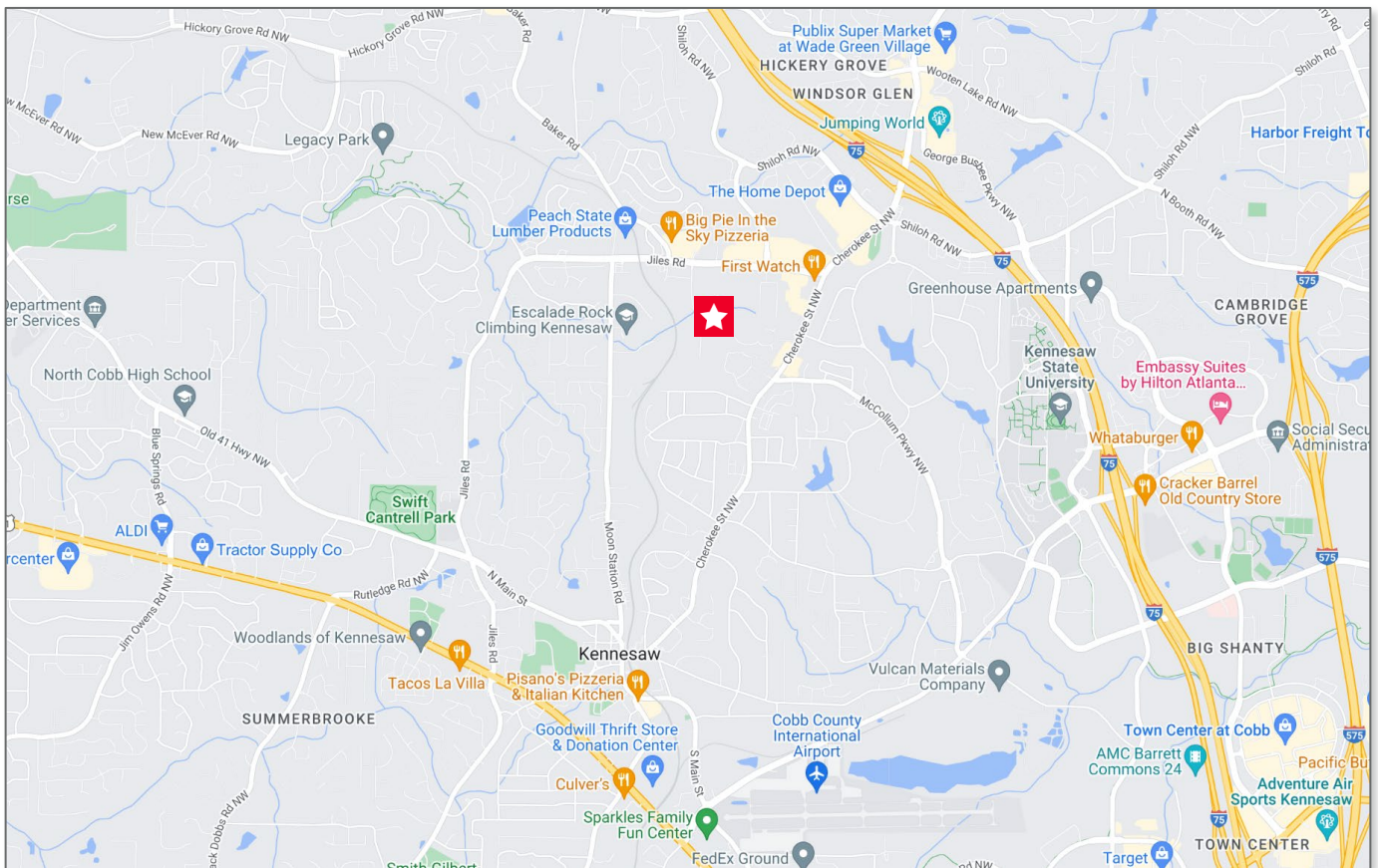

## **LISA PITTMAN, SIOR**

Executive Director  
Office +1 404 853 5277  
Cell +1 404 309 5309  
brian.monaghan@cushwake.com

## **ADAM THOMAS**

Director, CCIM  
Office +1 404 853 5318  
Cell +1 770 361 2530  
adam.thomas@cushwake.com