

# Vivint Building

SINGLE-TENANT OFFICE - SILICON SLOPES  
3401 NORTH ASHTON BOULEVARD - LEHI, UTAH



Cushman & Wakefield, as exclusive advisor, is pleased to present the opportunity to acquire the Vivint Building (the “Property”). This five-story, 125,000-sf, Class A, LEED Silver office building is in the heart of Lehi, Utah, a rapidly growing hub in the state’s thriving tech industry.

Lehi is a key driver of Utah’s unprecedented population growth, thanks to its central location in Silicon Slopes. Positioned between Salt Lake City to the north and Provo to the south, Lehi attracts top talent from two major population cores, making it the dominant hub for growth and innovation in the region. Lehi’s population grew by an impressive 6.9% in 2023, the second-highest city for population growth in the state of Utah.

The Property is fully leased to Vivint, a subsidiary of NRG Energy, Inc. (NYSE: NRG) providing credit-tenancy. Vivint has occupied the Property since it was built in 2014 and recently reinforced its commitment by renewing its lease for an additional three years before its previous term expired. The lease now extends through June 30, 2028, providing 3.75 years of WALT.

The Vivint Building stands out due to its Class A finishes and prime location in the strongest office submarket within Silicon Slopes.





### Asset Summary

Name:	Vivint Building
Address:	3401 North Ashton Boulevard Lehi, Utah
Property Type:	Single-tenant mid-rise office
Building Size:	125,000 net rentable sq. ft. 5 stories
Site Size:	6.00 acres
Parcel Number:	53-492-0001
Zoning:	RC (Resort Community)
Age:	2014
Parking:	500 spaces (4.00/1,000 sf ratio)

### Investment Highlights

Sales Price:	Contact brokers
Year 1 NOI:	\$1,955,414
In-Place Lease Rate:	\$25.00 psf
WALT:	3.75 years (as of September 2024)



### Exclusive Advisors:

**KIP PAUL**  
Vice Chairman  
Investment Sales  
801-303-5555  
kip.paul@cushwake.com

**MICHAEL KING**  
Director  
Investment Sales  
801-303-5421  
michael.king@cushwake.com

**JT REDD**  
Director  
Investment Sales  
801-303-5569  
jt.redd@cushwake.com

**CHRIS FIANDER-CARR, CFA**  
Financial Analyst  
801-303-5448  
chris.fiandercarr@cushwake.com

**PETE ANDREWS**  
Senior Marketing  
Specialist  
801-303-5410  
peter.andrews@cushwake.com

## Vivint Building

Cushman & Wakefield Copyright 2024. No warranty or representation, express or implied, is made to the accuracy or completeness of the information contained herein, and same is submitted subject to errors, omissions, change of price, rental or other conditions, withdrawal without notice, and to any special listing conditions imposed by the property owner(s). As applicable, we make no representation as to the condition of the property (or properties) in question. path: 1- Projects/Paul, K/1 - Flyers/3401nAshtonBlvd-Lehi



170 South Main Street, Suite 1600  
Salt Lake City, Utah 84101  
Tel 801-322-2000  
cushmanwakefield.com

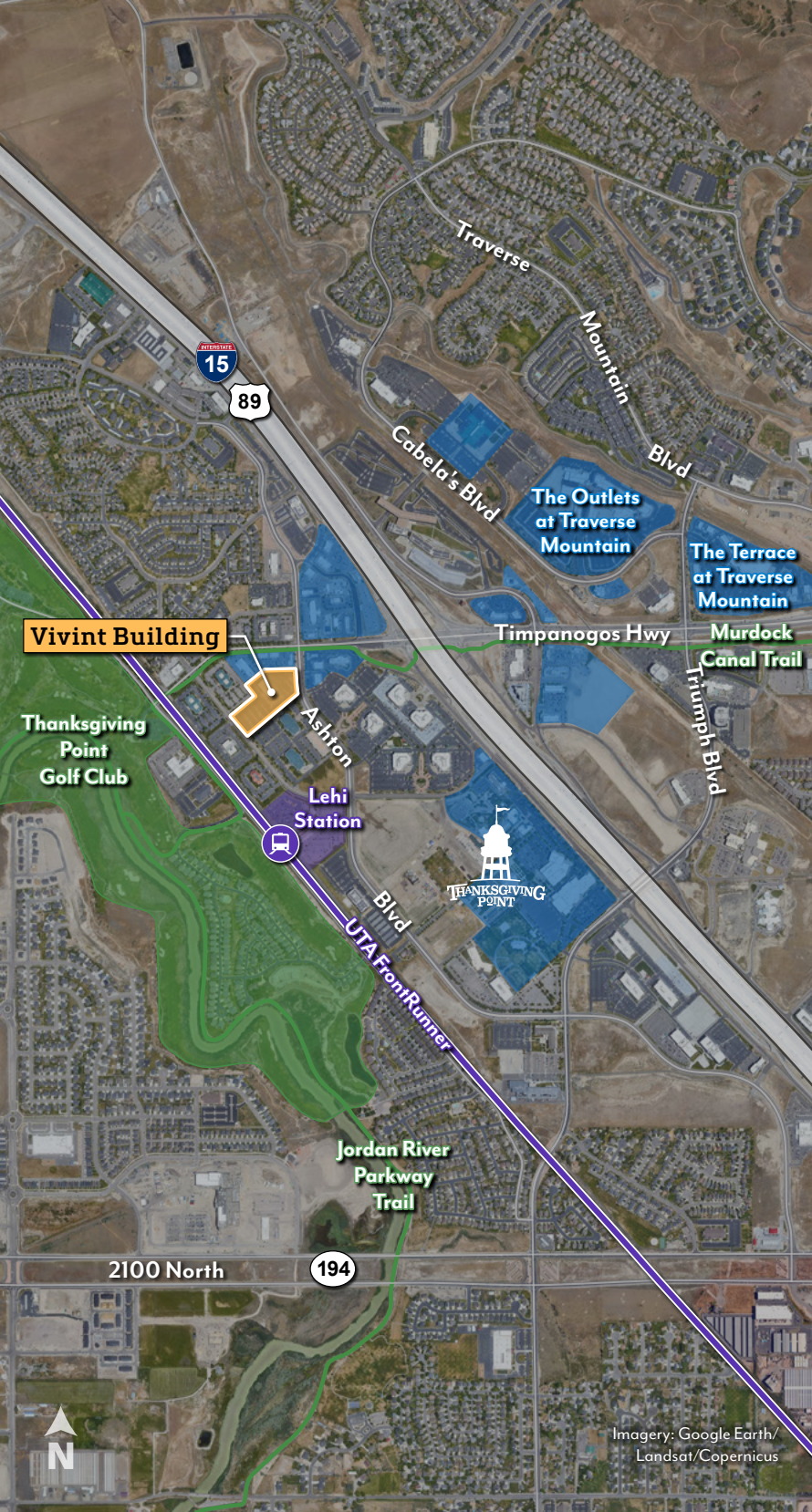

# SURROUNDING RETAIL AND AMENITIES

## THANKSGIVING POINT AREA



## ATTRACTIONS

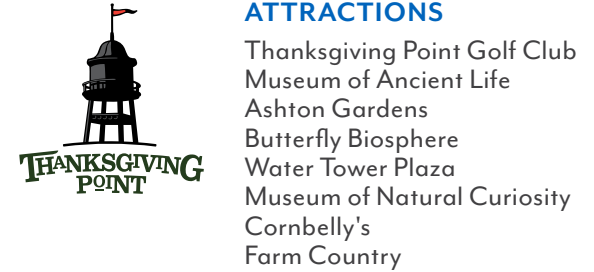

## TRAVERSE MOUNTAIN AREA



### Exclusive Advisors:

**KIP PAUL**  
Vice Chairman  
Investment Sales  
801-303-5555  
kip.paul@cushwake.com

**MICHAEL KING**  
Director  
Investment Sales  
801-303-5421  
michael.king@cushwake.com

**JT REDD**  
Director  
Investment Sales  
801-303-5569  
jt.redd@cushwake.com

**CHRIS FIANDER-CARR, CFA**  
Financial Analyst  
801-303-5448  
chris.fiandercarr@cushwake.com

**PETE ANDREWS**  
Senior Marketing  
Specialist  
801-303-5410  
peter.andrews@cushwake.com

## Vivint Building

Cushman & Wakefield Copyright 2024. No warranty or representation, express or implied, is made to the accuracy or completeness of the information contained herein, and same is submitted subject to errors, omissions, change of price, rental or other conditions, withdrawal without notice, and to any special listing conditions imposed by the property owner(s). As applicable, we make no representation as to the condition of the property (or properties) in question. path: 1- Projects/Paul, K/1 - Flyers/340InAshtonBlvd-Lehi



170 South Main Street, Suite 1600  
Salt Lake City, Utah 84101  
Tel 801-322-2000  
cushmanwakefield.com