

FOR LEASE AIRPORT 295 LOGISTICS PARK

12435 LEM TURNER ROAD | JACKSONVILLE, FL 32218



UP TO 500,000 SF AVAILABLE FOR LEASE NEW STATE-OF-THE-ART INDUSTRIAL PARK

- Three new warehouses
- Premier location in North Florida
- Immediate highway access with close proximity to Jacksonville International Airport and JAXPORT
- Seasoned Developer/Owner with proven national track record of industrial development
- Various space sizes available
- Single/Multi-Tenant building configurations available
- Multiple points of ingress and egress
- Visible from I-295
- ± 55 million consumers within an 8 hour drive time

LAND SIZE

±42 Acres

DELIVERY DATE

Q3 2024



On-site Trailer Parking



Class A Built-to-Suit office



32-FT Clear Height (Bldg 100 & 200)



Secure with the ability to privatize truck courts



36- FT Clear Height (Building 300)



Rear Load configurations



441 Auto Parking Spaces

Contact Info

JACOB HORSLEY
Executive Director
jacob.horsley@cushwake.com
+1 904 380 8335

TYLER NEWMAN
Executive Director
tyler.newman@cushwake.com
+1 904 380 8336

LEASED BY:



DEVELOPED BY:



AIRPORT 295 LOGISTICS PARK

SITE PLAN

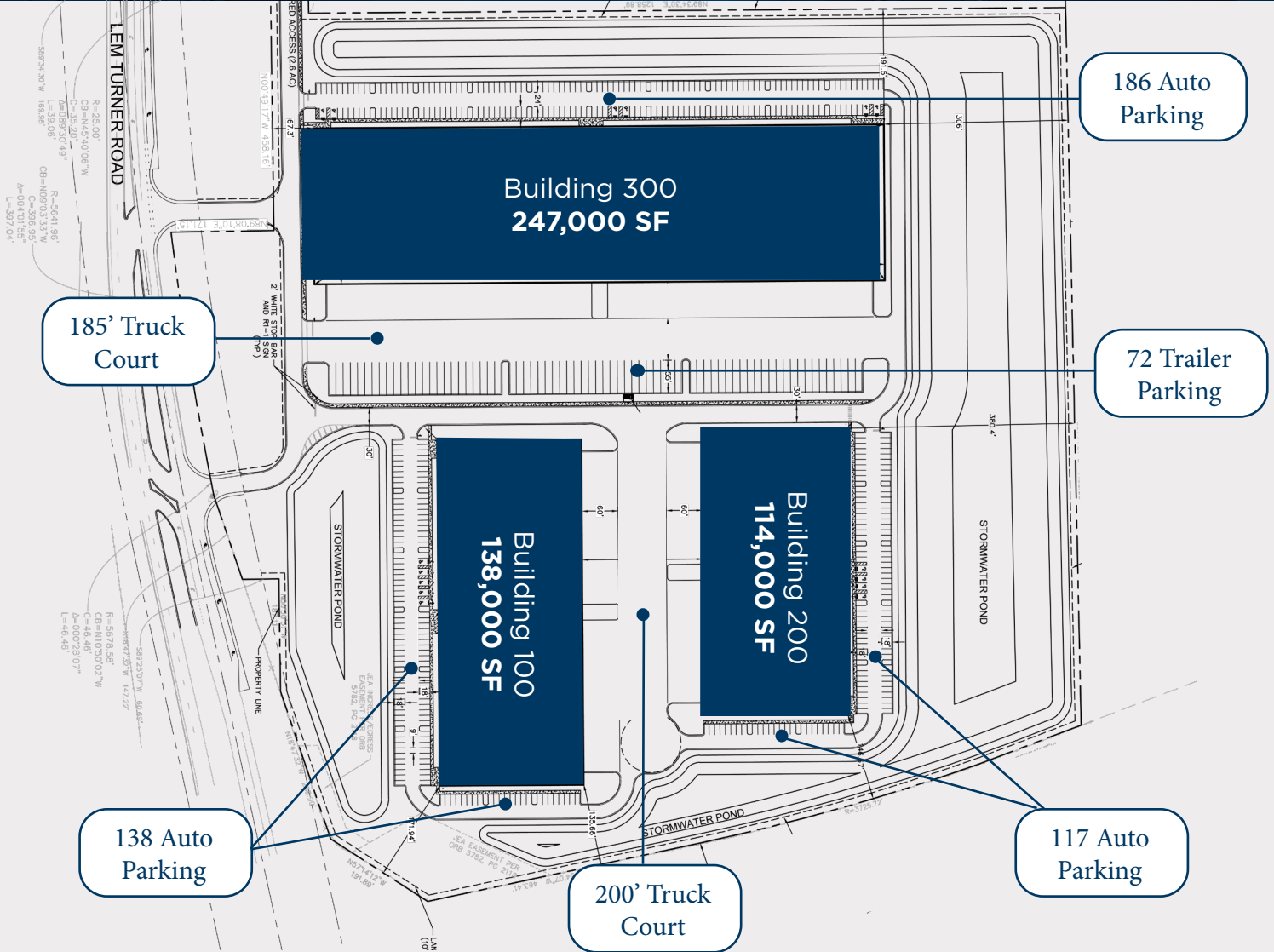

BUILDING FEATURES

BUILDING 100

- 138,000 SF
- 240' Building depth
- 32' Clear height
- 138 Parking spaces
- 200' Truck court (shared)

BUILDING 200

- 114,000 SF
- 240' Building depth
- 32' Clear height
- 117 Parking spaces
- 200' Truck court (shared)

BUILDING 300

- 247,000 SF
- 260' Building depth
- 36' Clear height
- 186 Parking spaces
- 72 Trailer Spaces
- 185' Truck Court

**12435 LEM TURNER ROAD AND
WEST I-295 BELTWAY**

LEASED BY: CUSHMAN & WAKEFIELD

DEVELOPED BY: SEEFRIED

AIRPORT 295 LOGISTICS PARK LOCATION MAP

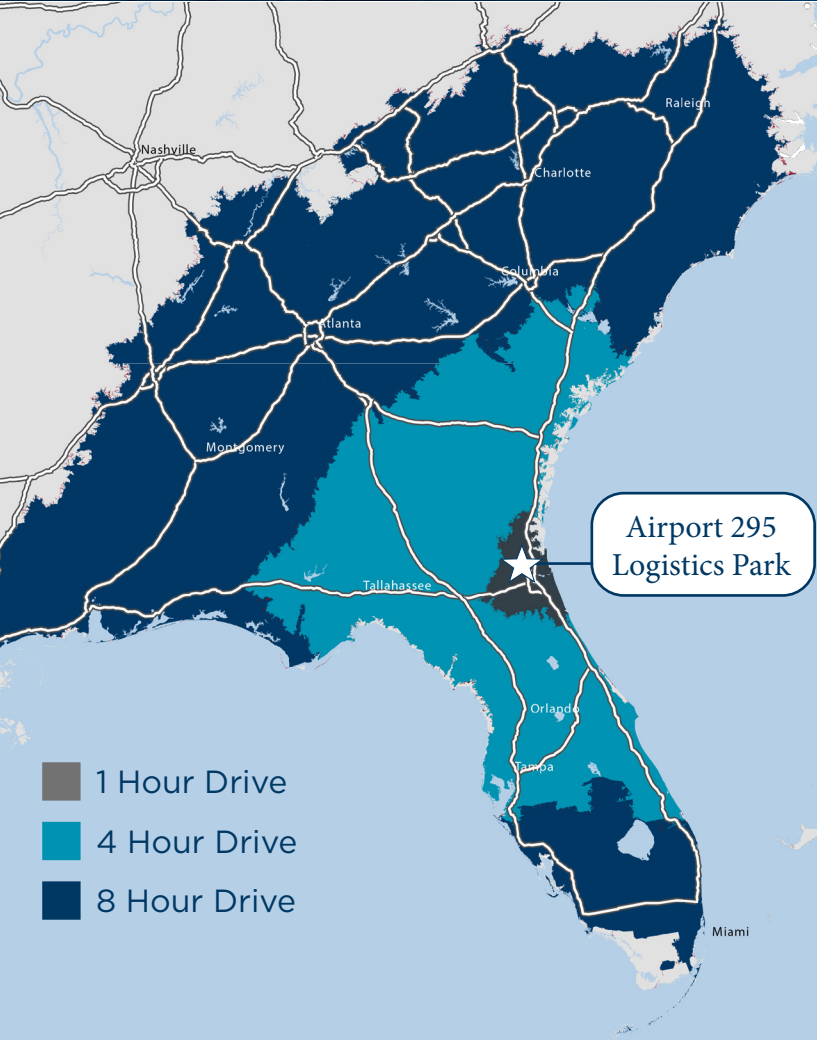

To I-295	<0.2 miles
To I-95	3.6 miles
To I-10	11 Miles
To Airport	5 miles

To JAXPORT Tallyrand	14.6 miles
To JAXPORT Blount Island	12 miles
To Orlando	156 miles
To Savannah	133 Miles

Contact Info

JACOB HORSLEY
Executive Director
jacob.horsley@cushwake.com
+1 904 380 8335

TYLER NEWMAN
Executive Director
tyler.newman@cushwake.com
+1 904 380 8336

LEASED BY:



DEVELOPED BY:

