



**CUSHMAN &
WAKEFIELD**

FOR LEASE

6 - 14231 BURROWS ROAD

RICHMOND, BC

3,240 SF Available



Graham Williams

Associate
+1 604 837 1819
graham.williams@cushwake.com

Noah Freedman

Associate Vice President
+1 604 833 3274
noah.freedman@cushwake.com

Ron J Emerson

Personal Real Estate Corporation
Vice President
+1 604 608 5921
ron.emerson@cushwake.com



**CUSHMAN &
WAKEFIELD**

FOR LEASE

6 - 14231 BURROWS ROAD

RICHMOND, BC

ASKING RENT

Contact listing agent

RENTABLE AREA

3,240 SF

AVAILABILITY

October 1st, 2024

ADDITIONAL RENT

\$5.66 + 5% mgmt fee

PROPERTY FEATURES

- Ample parking
- 100 amps of power (to be confirmed)
- One (1) dock loading door

ZONING

IL - The zone provides for a range of general industrial uses.

SITE PLAN

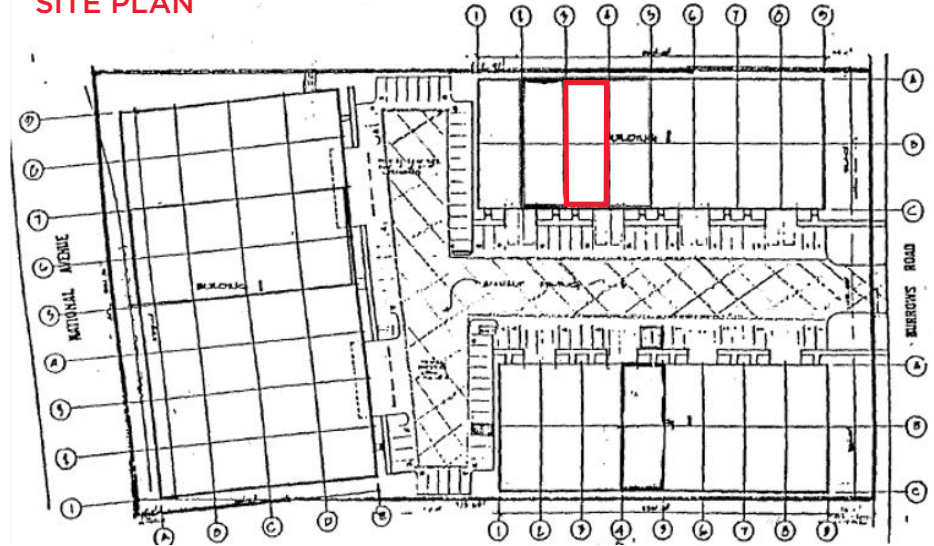

LOCATION MAP



Graham Williams

Associate
+1 604 837 1819
graham.williams@cushwake.com

Noah Freedman

Associate Vice President
+1 604 833 3274
noah.freedman@cushwake.com

Ron J Emerson

Personal Real Estate Corporation
Vice President
+1 604 608 5921
ron.emerson@cushwake.com

E.&O.E.: This communication is not intended to cause or induce breach of an existing agency agreement.

The information contained herein was obtained from sources which we deem reliable and, while thought to be correct, is not guaranteed by Cushman & Wakefield ULC 06/20 no

©2024 Cushman & Wakefield ULC. All rights reserved. The information contained in this communication is strictly confidential. This information has been obtained from sources believed to be reliable but has not been verified. No warranty or representation, express or implied, is made as to the condition of the property (or properties) referenced herein or as to the accuracy or completeness of the information contained herein, and same is submitted subject to errors, omissions, change of price, rental or other conditions, withdrawal without notice, and to any special listing conditions imposed by the property owner(s). Any projections, opinions or estimates are subject to uncertainty and do not signify current or future property performance.