

# Midtown Corporate Center

For Sale or Lease | 3634 Euclid Avenue, Cleveland, Ohio 44115



# Features

- 37,400 SF building in an excellent location in the heart of the Midtown Corridor
- 3,145 SF - 13,535 SF available for lease on the 2nd floor
- Plug and play work environment for office
- Located along the Health Tech Corridor, Cleveland's prime biomedical, healthcare and technology location



## Quick Stats

|                      |  |
|----------------------|--|
| BUILDING SIZE:       | 37,400 SF                                    |
| AVAILABLE FOR LEASE: | 3,145 SF - 13,535 SF (2 <sup>nd</sup> Floor) |
| # OF FLOORS:         | Two (2)                                      |
| LAND AREA:           | 1.08 AC                                      |
| PARCEL #'S:          | 10308016                                     |
| PARKING:             | 59 Surface Spaces                            |
| WALK SCORE:          | Very Walkable (70)                           |
| ASKING PRICE:        | Negotiable                                   |
| LEASE RATE:          | \$18.00/SF                                   |

# Available for Lease - 13,535 SF Contiguous

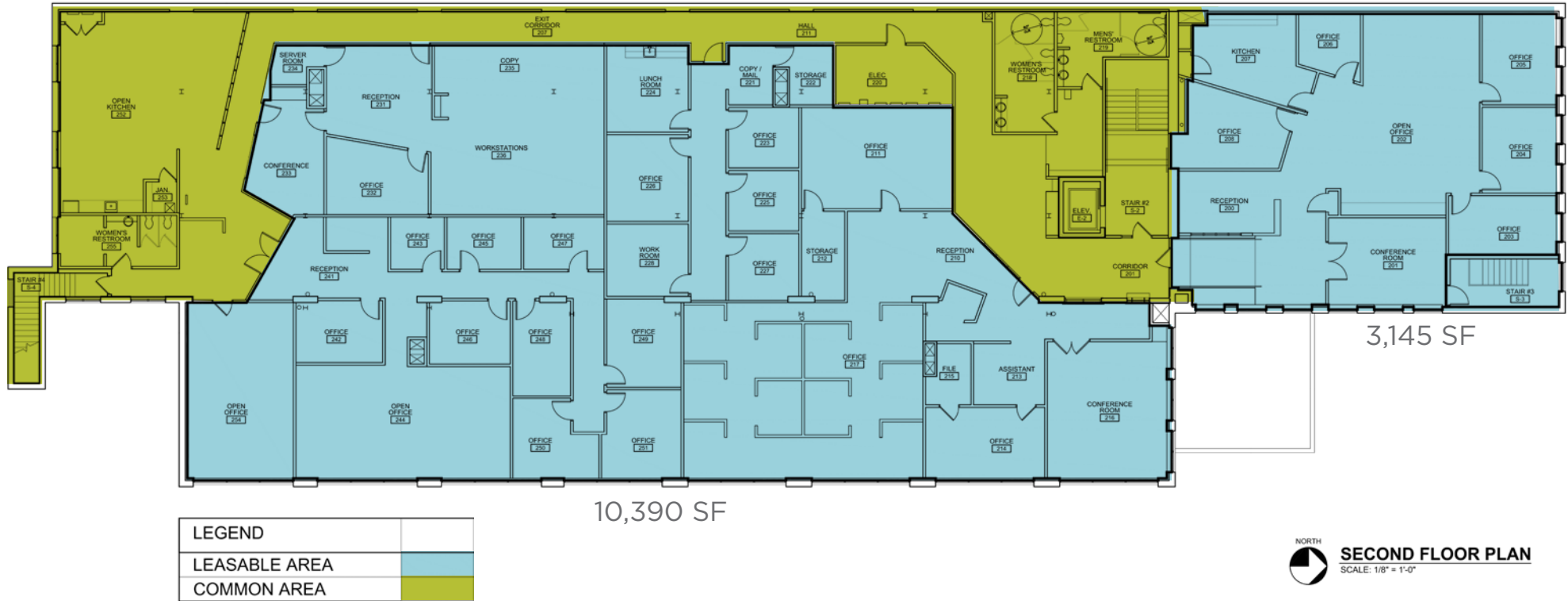

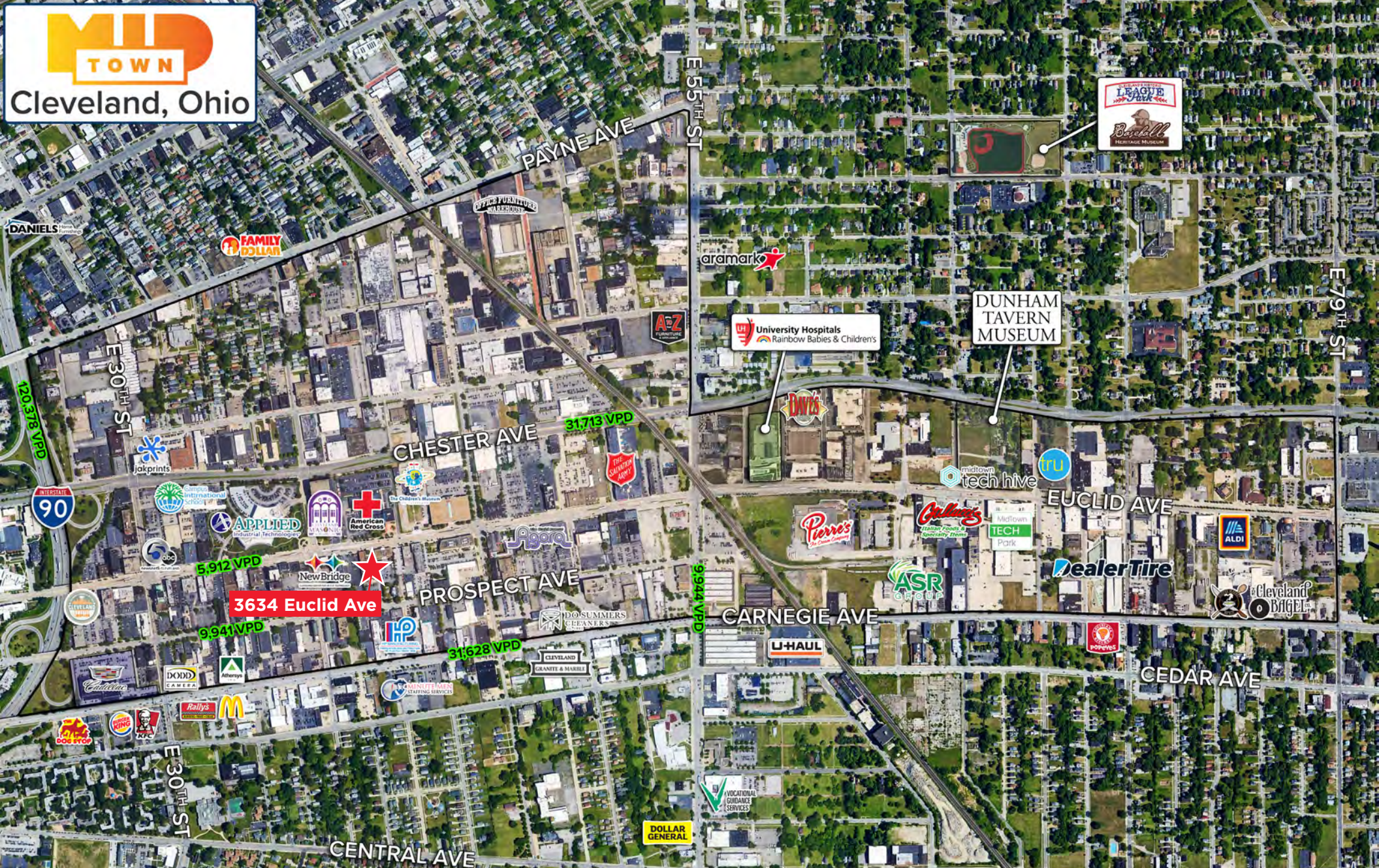

**258,234**  
Population  
(2024 | 5 Mile)

**34.9**  
Median Age  
(2024 | 5 Mile)

**120,499**  
Households  
(2024 | 5 Mile)

**\$66,358**  
Avg. Household Income  
(2024 | 5 Mile)

**12,146**  
Total Businesses  
(2024 | 5 Mile)

**171,666**  
Total Employees  
(2024 | 5 Mile)



## MIDTOWN CORPORATE CENTER

3634 EUCLID AVENUE,  
CLEVELAND, OHIO 44115

### JIM KRIVANEK

Vice President

[jkrivanek@crescorealestate.com](mailto:jkrivanek@crescorealestate.com)

+1 216 525 1498

### RICO PIETRO, SIOR

Principal

[rpietro@crescorealestate.com](mailto:rpietro@crescorealestate.com)

+1 216 525 1473



**CUSHMAN &  
WAKEFIELD**



**Cushman & Wakefield | CRESCO Real Estate**

6100 Rockside Woods Blvd, Suite 200  
Cleveland, Ohio 44131

[crescorealestate.com](http://crescorealestate.com)

©2024 Cushman & Wakefield. All rights reserved. The information contained in this communication is strictly confidential. This information has been obtained from sources believed to be reliable but has not been verified. NO WARRANTY OR REPRESENTATION, EXPRESS OR IMPLIED, IS MADE AS TO THE CONDITION OF THE PROPERTY (OR PROPERTIES) REFERENCED HEREIN OR AS TO THE ACCURACY OR COMPLETENESS OF THE INFORMATION CONTAINED HEREIN, AND SAME IS SUBMITTED SUBJECT TO ERRORS, OMISSIONS, CHANGE OF PRICE, RENTAL OR OTHER CONDITIONS, WITHDRAWAL WITHOUT NOTICE, AND TO ANY SPECIAL LISTING CONDITIONS IMPOSED BY THE PROPERTY OWNER(S). ANY PROJECTIONS, OPINIONS OR ESTIMATES ARE SUBJECT TO UNCERTAINTY AND DO NOT SIGNIFY CURRENT OR FUTURE PROPERTY PERFORMANCE.