



FOR SUBLEASE / FLOOR 15

980 HOWE STREET VANCOUVER BC

15,927 SF HIGH QUALITY
PLUG & PLAY OPPORTUNITY



**CUSHMAN &
WAKEFIELD**



— FOR SUBLEASE / FLOOR 15 —
980 HOWE STREET VANCOUVER BC
 15,927 SF HIGH QUALITY PLUG & PLAY OPPORTUNITY

ABOUT THE BUILDING

A class "A" LEED Gold certified office development. Clad in triple pane glass with dichroic accents, this state-of-the-art, 16-storey office building offers uncompromising quality in every detail. - A simple, clean and modern design combines warm wood finishes with elegant marble and a double height lobby - Innovative use of glass, colour and tinting allows ample daylight, uninterrupted views with floor-to-ceiling windows and energy conservation - Amenities include a penthouse conference facility with an outdoor garden, an exclusive tenant lounge and a fitness centre. www.980howe.com



PUBLIC TRANSPORTATION
 2 minute walk to City Centre Skytrain



CAR PARKING
 1 per 1,560 SF



EV CHARGING
 On-site



BICYCLE STORAGE
 On-site



CONFERENCE CENTRE
 Penthouse terrace and conference centre



FITNESS CENTRE
 On-site



AWARDS & CERTIFICATIONS
 BOMA Best Platinum
 LEED Gold EB & Shell certified
 Energy Star - Certified
 Rick Hansen Foundation Accessibility
 Gold Certification

FOR SUBLEASE / FLOOR 15

980 HOWE STREET VANCOUVER BC

15,927 SF HIGH QUALITY PLUG & PLAY OPPORTUNITY



AVAILABLE AREA

15th Floor

15,927 SF

FEATURES

Open plan desks, large boardrooms, meeting rooms, call rooms and collaboration spaces.

FURNITURE

Furniture available.

NET ASKING RATE

Contact listing agents for details

TAXES & OPERATING COSTS

\$25.09 psf, per annum for 2024

SUBLEASE EXPIRY DATE

August 31, 2026

AVAILABLE

Immediately





15TH FLOOR

15,927 SF

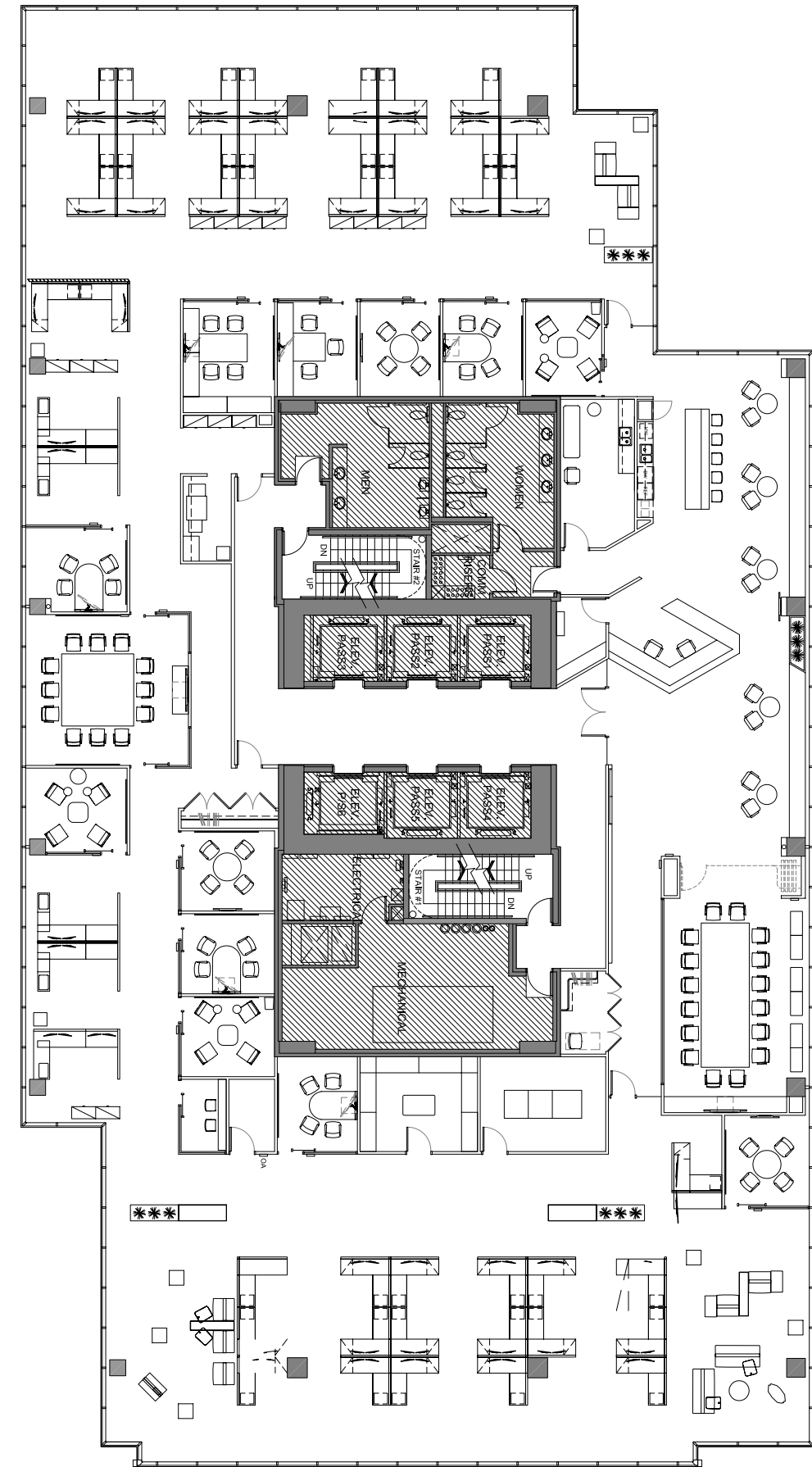

FOR SUBLEASE / FLOOR 15
980 HOWE STREET VANCOUVER BC
 15,927 SF HIGH QUALITY PLUG & PLAY OPPORTUNITY

- 1 Wall WALL CENTRE
- 2 HUNGRY GUYS kitchen
- 3 lululemon
- 4 level VANCOUVER
- 5 ZARA
- 6 Earls KITCHEN + BAR
- 7 NORDSTROM
- 8 JOEY RESTAURANTS
- 9 goodco. BARS

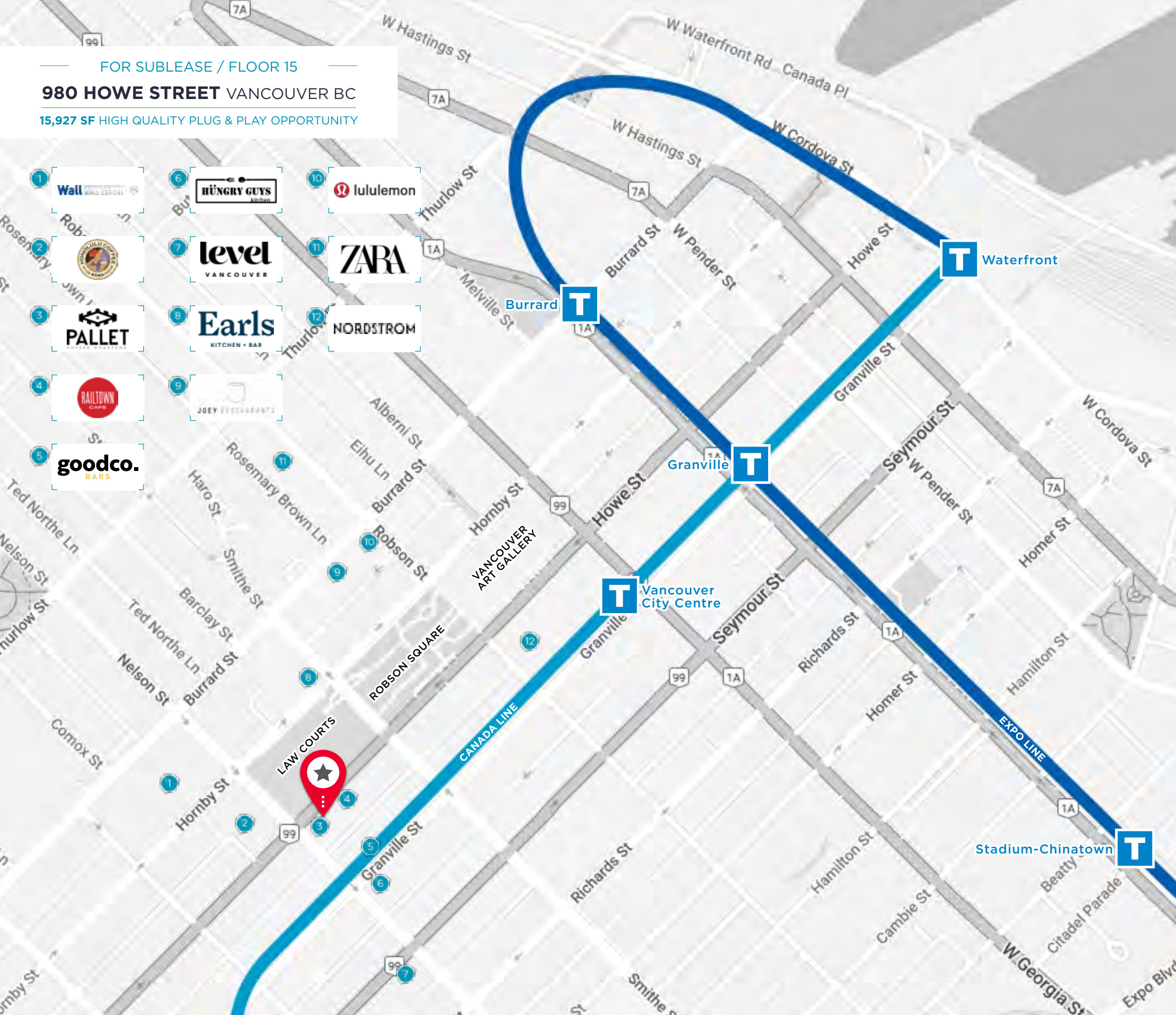

— FOR SUBLEASE / FLOOR 15 —

980 HOWE STREET VANCOUVER BC

15,927 SF HIGH QUALITY PLUG & PLAY OPPORTUNITY



BART CORBETT*

BG Corbett Realty Advisors Ltd.
Vice Chair
604 640 5881
bart.corbett@cushwake.com

JORDAN CORBETT

Associate Vice President
604 640 5815
jordan.corbett@cushwake.com



Suite 1200 - 700 West Georgia Street / PO Box 10023, Pacific Centre / Vancouver, BC V7Y 1A1 / 604 683 3111 / cushmanwakefield.ca

* Bart Corbett is licensed with BG Corbett Realty Advisors Ltd. and has a contractual relationship with Cushman & Wakefield ULC
E.&O.E.: This communication is not intended to cause or induce breach of an existing agency agreement. The information contained herein was obtained from sources which we deem reliable and, while thought to be correct, is not guaranteed by Cushman & Wakefield ULC (10/22/bg)