

**3213 S. 24TH STREET**  
Omaha, NE 68108

3,380 SF Turnkey Medical Office | For Lease



**Jorge Sotolongo** | Senior Associate | [jorge.sotolongo@lundco.com](mailto:jorge.sotolongo@lundco.com) | +1 402 212 4486  
**Noah Ludwick** | Associate | [noah.ludwick@lundco.com](mailto:noah.ludwick@lundco.com) | +1 402 548 4049

**LUNDCO.COM**

Cushman & Wakefield Copyright 2024. No warranty or representation, express or implied, is made to the accuracy or completeness of the information contained herein, and same is submitted subject to errors, omissions, change of price, rental or other conditions, withdrawal without notice, and to any special listing conditions imposed by the property owner(s). As applicable, we make no representation as to the condition of the property (or properties) in question.



# 3213 S. 24TH STREET

Omaha, NE 68108

3,380 SF Turnkey Medical Office | For Lease

## PROPERTY OVERVIEW



This prime medical office of approximately 3,380 SF, is a turnkey solution featuring nine (9) private exam rooms, nurses station, break room, ADA-compliant restrooms, and a recreation area. It boasts a prime location at 24th and Vinton Street, serving Downtown Omaha, South Omaha, and Council Bluffs, with direct access to I-80. The office is finished to a high quality, ensuring a professional and comfortable environment for both staff and patients.

## PROPERTY HIGHLIGHTS

Lease Rate	\$12.00 PSF NNN
NNN Expenses	Est. \$4.50 PSF
Total Available	3,380 SF
Building Size	7,080 SF
Year Built	1957
Total Site Area	49,050 SF
Zoning	CC
Parking Ratio	3:1000



## NEIGHBORHOOD DEMOGRAPHICS

	 POPULATION	 MEDIAN HOUSEHOLD INCOME	 NUMBER OF HOUSEHOLDS
1 Mile	16,879	\$52,998	5,774
3 Miles	116,563	\$51,422	52,161
5 Miles	247,274	\$54,330	108,423

**Jorge Sotolongo** | Senior Associate | [jorge.sotolongo@lundco.com](mailto:jorge.sotolongo@lundco.com) | +1 402 212 4486  
**Noah Ludwick** | Associate | [noah.ludwick@lundco.com](mailto:noah.ludwick@lundco.com) | +1 402 548 4049

450 Regency Parkway, Suite 200  
Omaha, NE 68114  
+1 402 393 8811  
[lundco.com](http://lundco.com)

# 3213 S. 24TH STREET

Omaha, NE 68108

3,380 SF Turnkey Medical Office | For Lease

## Photos



**Jorge Sotolongo** | Senior Associate | [jorge.sotolongo@lundco.com](mailto:jorge.sotolongo@lundco.com) | +1 402 212 4486  
**Noah Ludwick** | Associate | [noah.ludwick@lundco.com](mailto:noah.ludwick@lundco.com) | +1 402 548 4049

450 Regency Parkway, Suite 200  
Omaha, NE 68114  
+1 402 393 8811  
[lundco.com](http://lundco.com)

# 3213 S. 24TH STREET

Omaha, NE 68108

3,380 SF Turnkey Medical Office | For Lease

## Floor plan

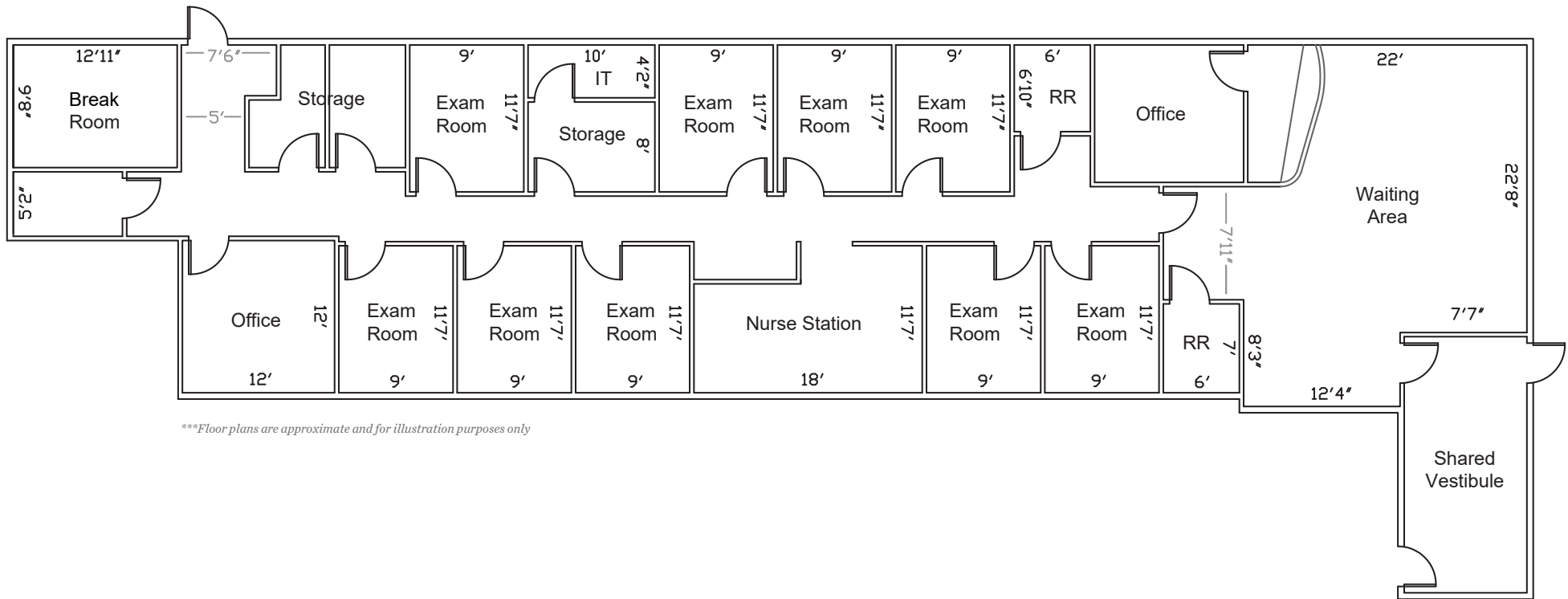

**Jorge Sotolongo** | Senior Associate | [jorge.sotolongo@lundco.com](mailto:jorge.sotolongo@lundco.com) | +1 402 212 4486  
**Noah Ludwick** | Associate | [noah.ludwick@lundco.com](mailto:noah.ludwick@lundco.com) | +1 402 548 4049

450 Regency Parkway, Suite 200  
Omaha, NE 68114  
+1 402 393 8811  
[lundco.com](http://lundco.com)

# 3213 S. 24TH STREET

Omaha, NE 68108

3,380 SF Turnkey Medical Office | For Lease

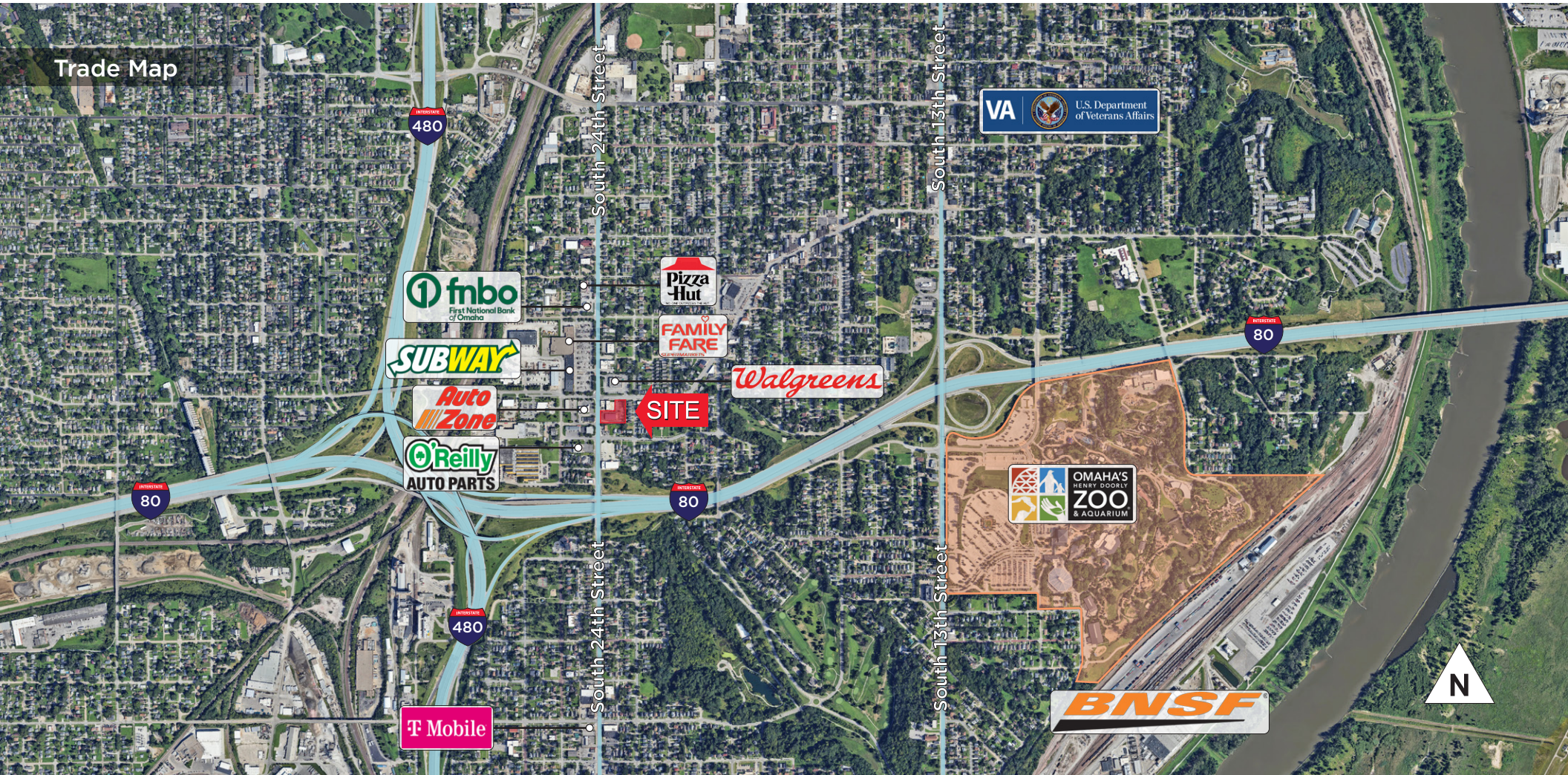

**Jorge Sotolongo** | Senior Associate | [jorge.sotolongo@lundco.com](mailto:jorge.sotolongo@lundco.com) | +1 402 212 4486  
**Noah Ludwick** | Associate | [noah.ludwick@lundco.com](mailto:noah.ludwick@lundco.com) | +1 402 548 4049

450 Regency Parkway, Suite 200  
Omaha, NE 68114  
+1 402 393 8811  
[lundco.com](http://lundco.com)