

**KEVIN GOLDTHWAITE**

Director

+1 916 403 1818

[kevin.goldthwaite@cushwake.com](mailto:kevin.goldthwaite@cushwake.com)

CA LIC #01911862

**SPENCER NIELSEN**

Senior Associate

+1 916 288 4531

[spencer.nielsen@cushwake.com](mailto:spencer.nielsen@cushwake.com)

CA LIC #01964163

FOR LEASE

# ANTELOPE ROAD

CITRUS HEIGHTS, CA 95621



# 7447 ANTELOPE ROAD

FOR LEASE

## PROPERTY HIGHLIGHTS

Asking Rate: \$1.65/RSF Full Service Gross

- Office space available starting at ±2,400 RSF
- Monument signage available
- On-site storage opportunities
- Close proximity to Interstate 80 and various retail amenities

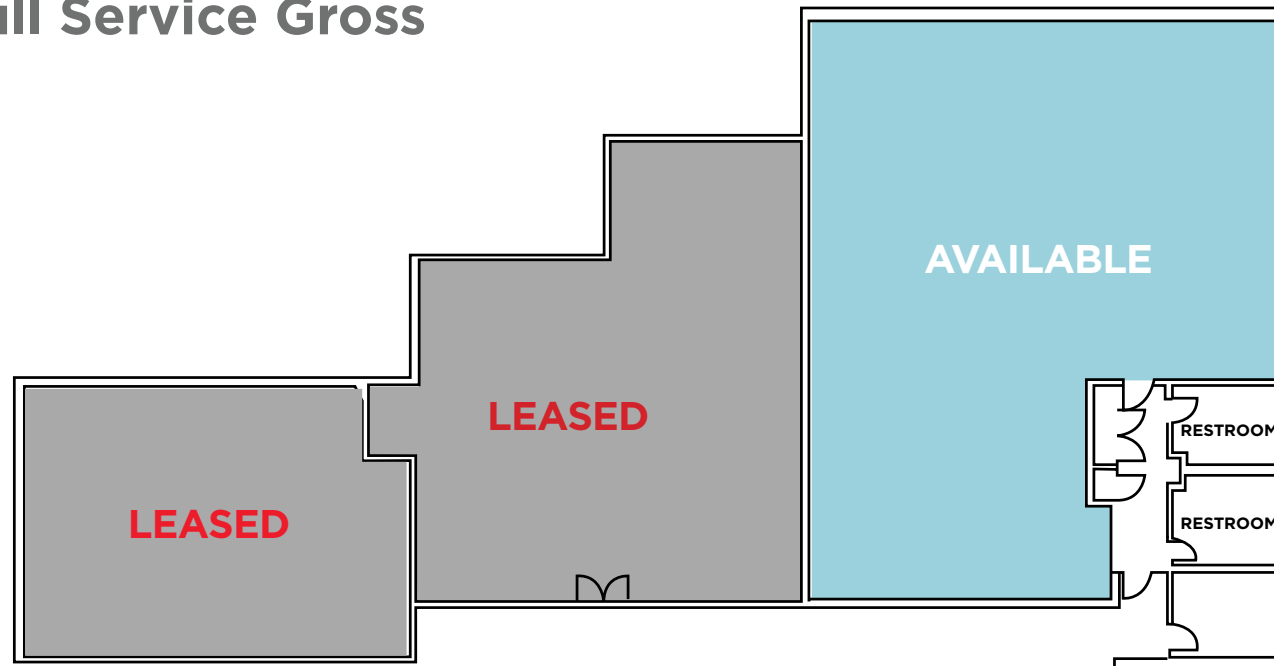

### CONTACT INFO

#### KEVIN GOLDTHWAITE

Director  
+1 916 403 1818  
kevin.goldthwaite@cushwake.com  
CA LIC #01911862

#### SPENCER NIELSEN

Senior Associate  
+1 916 288 4531  
spencer.nielsen@cushwake.com  
CA LIC #01964163

400 Capitol Mall, Suite 1800  
Sacramento, CA 95814  
+1 916 288 4800  
[cushmanwakefield.com](http://cushmanwakefield.com)



[View Site Specific COVID-19 Prevention Plan](#)

















7447 ANTELOPE RD.



ANTELOPE RD.

RUSCH PARK

AUBURN BLVD.































# PROPERTY PHOTOS

