



Property Highlights

- 1,230 SF - 5,000 SF available
- Office and flexible Warehouse options available
- 14' to 16' clear height
- Grade level drive-in and dock-high doors available
- Centrally located in both West Greensboro and the Triad Region
- Convenient access to Interstate 40 via Wendover Avenue
- \$11.00 SF, modified gross

Ryan Gioffre
Senior Director
+1 336 821 3822
ryan.gioffre@cushwake.com

628 Green Valley Road, Ste. 202
Greensboro, NC 27408
Main +1 336 668 9999
Fax +1 336 668 0888
cushmanwakefield.com

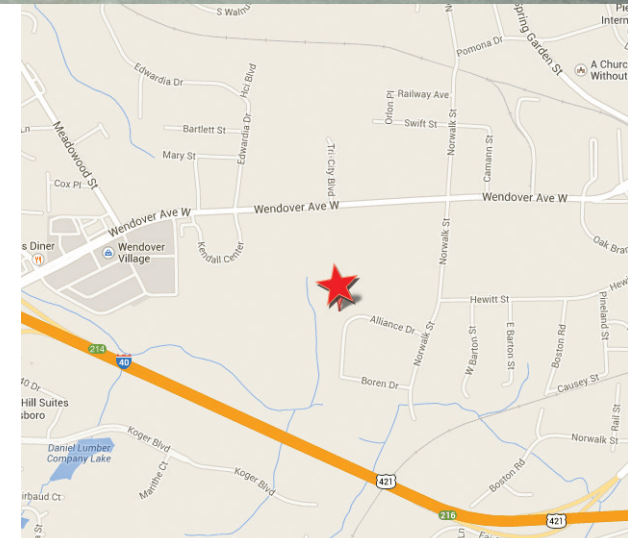



Site Plan
Dock Access

Ryan Gioffre
Senior Director
+1 336 821 3822
ryan.gioffre@cushwake.com

628 Green Valley Road, Ste. 202
Greensboro, NC 27408
Main +1 336 668 9999
Fax +1 336 668 0888
cushmanwakefield.com