

FOR SALE & LEASE



Property Highlights

131,975 +/- SF Class A Office Building

- Sale Price: \$7,500,000
- Lease Rate: \$18.50/SF Full Service
- Potential for full building availability
- Built in 1996
- 18.23 Acres
- On-site security
- Flexible / open floor plans
- Upgraded HVAC and controls
- Exterior is polished granite and glass curtain walls
- Three (3) passenger elevators and one (1) freight elevator
- 2,000 amp main panel with back-up generator for electrical
- Highly visible signage opportunities
- Currently 747 parking spaces (5.6 / 1,000), with the ability to add +/- 125 parking spaces
- One (1) loading dock with covered staging area

Ryan Gioffre
Senior Director
+1 336 821 3822
ryan.gioffre@cushwake.com

Ryan Conboy, SIOR
Senior Director
+1 336 821 3832
ryan.conboy@cushwake.com

628 Green Valley Road, Ste. 202
Greensboro, NC 27408
Main +1 336 668 9999
Fax +1 336 668 0888
cushmanwakefield.com

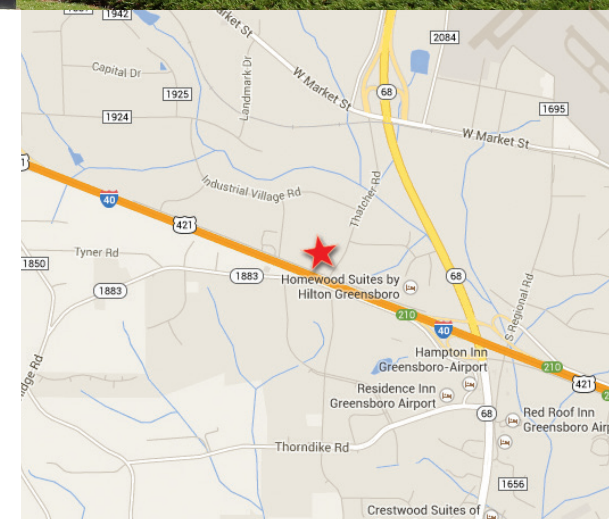



Ryan Gioffre
Senior Director
+1 336 821 3822
ryan.gioffre@cushwake.com

Ryan Conboy, SIOR
Senior Director
+1 336 821 3832
ryan.conboy@cushwake.com

628 Green Valley Road, Ste. 202
Greensboro, NC 27408
Main +1 336 668 9999
Fax +1 336 668 0888
cushmanwakefield.com

Property Photos



Ryan Gioffre
Senior Director
+1 336 821 3822
ryan.gioffre@cushwake.com

Ryan Conboy, SIOR
Senior Director
+1 336 821 3832
ryan.conboy@cushwake.com

628 Green Valley Road, Ste. 202
Greensboro, NC 27408
Main +1 336 668 9999
Fax +1 336 668 0888
cushmanwakefield.com

1st Floor: +/-15,718 RSF

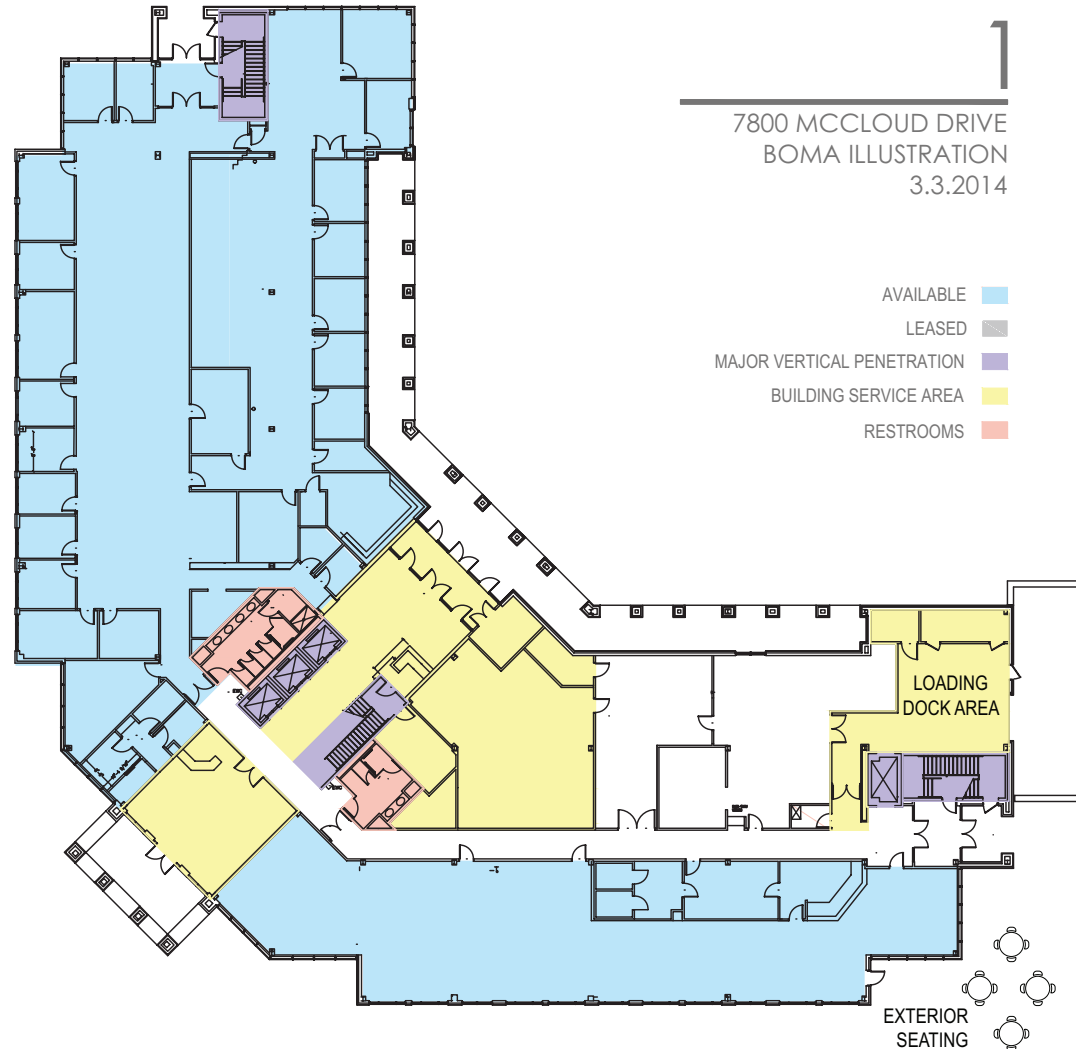

Ryan Gioffre
Senior Director
+1 336 821 3822
ryan.gioffre@cushwake.com

Ryan Conboy, SIOR
Senior Director
+1 336 821 3832
ryan.conboy@cushwake.com

628 Green Valley Road, Ste. 202
Greensboro, NC 27408
Main +1 336 668 9999
Fax +1 336 668 0888
cushmanwakefield.com

3rd Floor: 27,503 RSF

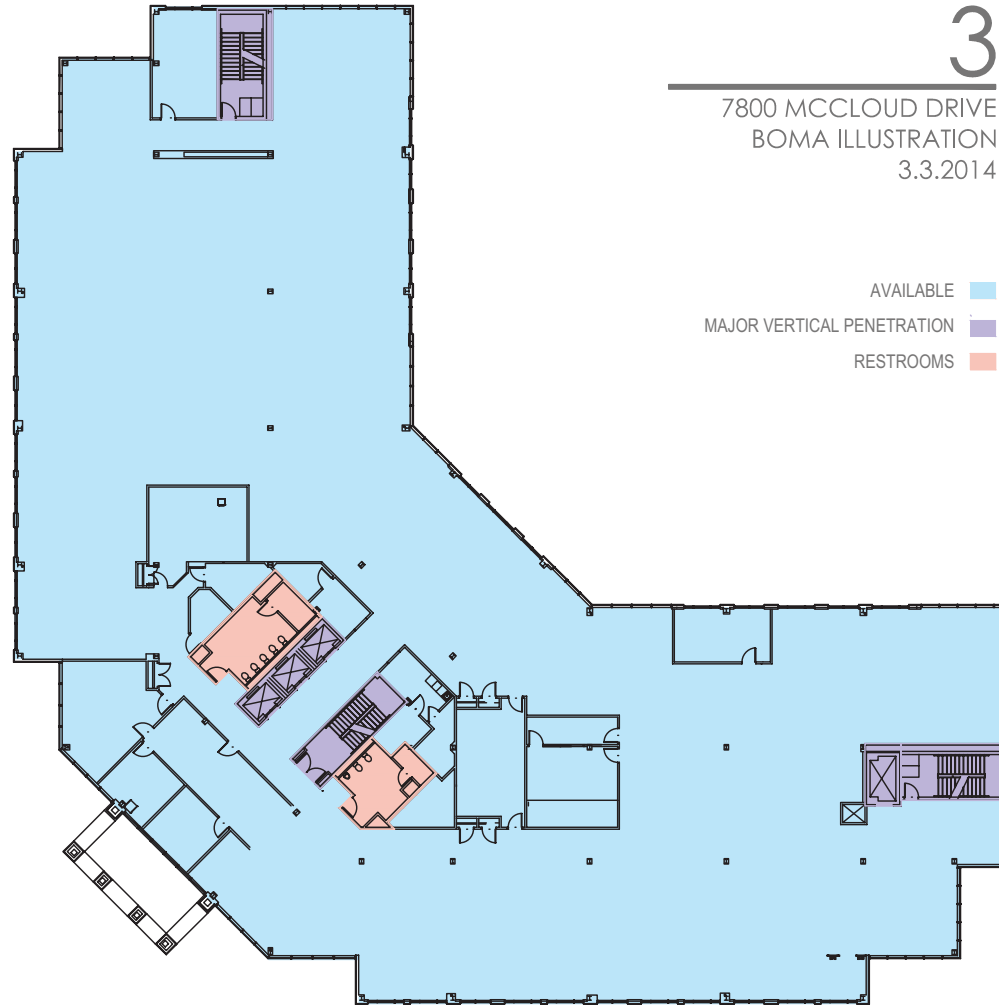

3

7800 MC CLOUD DRIVE
BOMA ILLUSTRATION
3.3.2014

AVAILABLE ■
MAJOR VERTICAL PENETRATION ■
RESTROOMS ■

Ryan Gioffre
Senior Director
+1 336 821 3822
ryan.gioffre@cushwake.com

Ryan Conboy, SIOR
Senior Director
+1 336 821 3832
ryan.conboy@cushwake.com

628 Green Valley Road, Ste. 202
Greensboro, NC 27408
Main +1 336 668 9999
Fax +1 336 668 0888
cushmanwakefield.com

4th Floor: 27,503 RSF

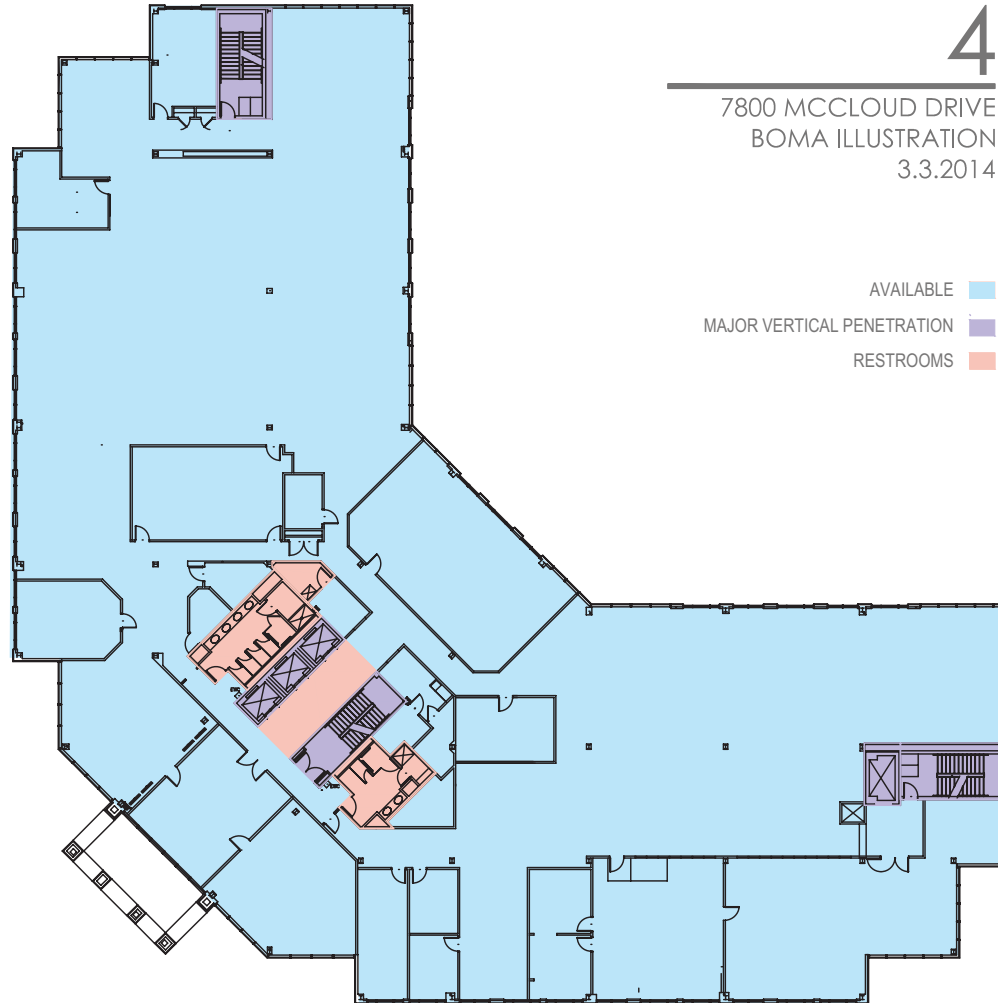

4

7800 MC CLOUD DRIVE
BOMA ILLUSTRATION
3.3.2014

AVAILABLE ■
MAJOR VERTICAL PENETRATION ■
RESTROOMS ■

Ryan Gioffre
Senior Director
+1 336 821 3822
ryan.gioffre@cushwake.com

Ryan Conboy, SIOR
Senior Director
+1 336 821 3832
ryan.conboy@cushwake.com

628 Green Valley Road, Ste. 202
Greensboro, NC 27408
Main +1 336 668 9999
Fax +1 336 668 0888
cushmanwakefield.com

5th Floor: 25,574 RSF



Ryan Gioffre
Senior Director
+1 336 821 3822
ryan.gioffre@cushwake.com

Ryan Conboy, SIOR
Senior Director
+1 336 821 3832
ryan.conboy@cushwake.com

628 Green Valley Road, Ste. 202
Greensboro, NC 27408
Main +1 336 668 9999
Fax +1 336 668 0888
cushmanwakefield.com