

Carowinds Distribution Center

355 Crestmont Blvd | Fort Mill, SC 29708



±172,850 - 214,850 SF

FOR SUBLEASE INDUSTRIAL/MANUFACTURING SPACE

- Ground Floor: ±214,850 SF
Divisible to ±172,500 SF
- Bonus Mezzanine: ±63,200 SF
Office, Breakroom, Production
Area with 3 Freight Elevators
- Total Facility Size: ±278,050 SF
- Facility Designed for Good
Manufacturing Practice
Standards
- Rear-Load Facility
- Concrete Tilt-Up
Construction
- 7 (9' x 10') Dock-High Doors
- 1 (12' x 14') Drive-In Doors
- ±32' Clear Height
- ESFR Sprinkler System
- ±45' x 52' Column Spacing
(Typical)
- Electrical Service
3000 Amps 277/480 Volt
- Fully Air Conditioned
- ±275 Auto Parking Spaces

Available 10/1/2022

Sublease Term Through 8/31/24

CALL TO TOUR

INDUSTRIAL/MANUFACTURING SPACE

±172,850 - 214,850 SF for Sublease

355 Crestmont Blvd | Fort Mill, SC 29708

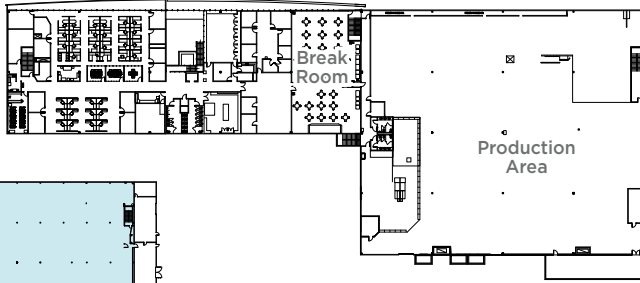

**SECOND FLOOR
MEZZANINE**
±63,200 SF

**±278,050
Total SF Available**

GROUND FLOOR
±214,850 SF

±42,000 SF can be
retained by sublandlord

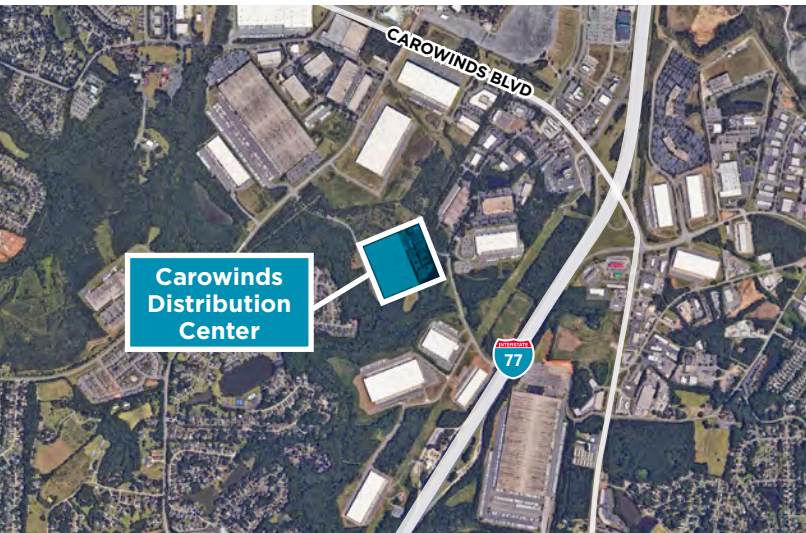
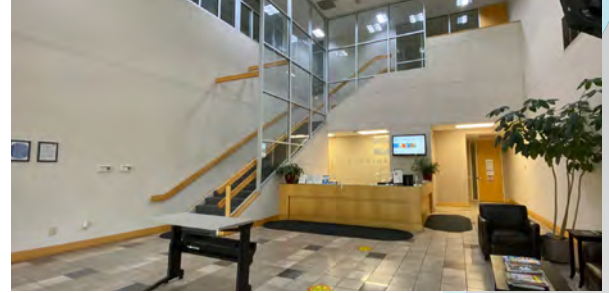

For more information, please contact:

ERIC RIDLEHOOVER
Senior Director
+1 704 335 4440
eric.ridlehoover@cushwake.com

TOM SNIDER
Executive Managing Director
+1 408 436 3639
tom.snider@cushwake.com

300 S. Tryon Street, Suite 1110
Charlotte, NC 28202

300 Santana Row, 5th Floor
San Jose, CA 95128

©2022 Cushman & Wakefield. All rights reserved. The information contained in this communication is strictly confidential. This information has been obtained from sources believed to be reliable but has not been verified. NO WARRANTY OR REPRESENTATION, EXPRESS OR IMPLIED, IS MADE AS TO THE CONDITION OF THE PROPERTY (OR PROPERTIES) REFERENCED HEREIN OR AS TO THE ACCURACY OR COMPLETENESS OF THE INFORMATION CONTAINED HEREIN, AND SAME IS SUBMITTED SUBJECT TO ERRORS, OMISSIONS, CHANGE OF PRICE, RENTAL OR OTHER CONDITIONS, WITHDRAWAL WITHOUT NOTICE, AND TO ANY SPECIAL LISTING CONDITIONS IMPOSED BY THE PROPERTY OWNER(S). ANY PROJECTIONS, OPINIONS OR ESTIMATES ARE SUBJECT TO UNCERTAINTY AND DO NOT SIGNIFY CURRENT OR FUTURE PROPERTY PERFORMANCE.