

FOR LEASE

355 Crestmont Drive | Fort Mill, SC 29708

Carowinds Distribution Center



±214,850 SF INDUSTRIAL/MANUFACTURING SPACE

- Ground Floor: ±214,850 SF
- Bonus Mezzanine: ±63,200 SF Office, Breakroom, Production Area with 3 Freight Elevators
- Total Facility Size: ±278,050 SF
- Facility Designed for Good Manufacturing Practice Standards
- Rear-Load Facility
- Concrete Tilt-Up Construction
- 7 (9' x 10') Dock-High Doors
- 1 (12' x 14') Drive-In Doors
- ±32' Clear Height
- ESFR Sprinkler System
- ±45' x 52' Column Spacing (Typical)
- Electrical Service 3000 Amps 277/480 Volt
- Fully Air Conditioned
- ±275 Auto Parking Spaces

FERMIN DEOCA

+1 704 335 4436

fermin.deoca@cushwake.com

MATT TREBLE

+1 704 335 4430

matt.treble@cushwake.com



Carowinds Distribution Center

±214,850 SF INDUSTRIAL/MANUFACTURING SPACE FOR LEASE

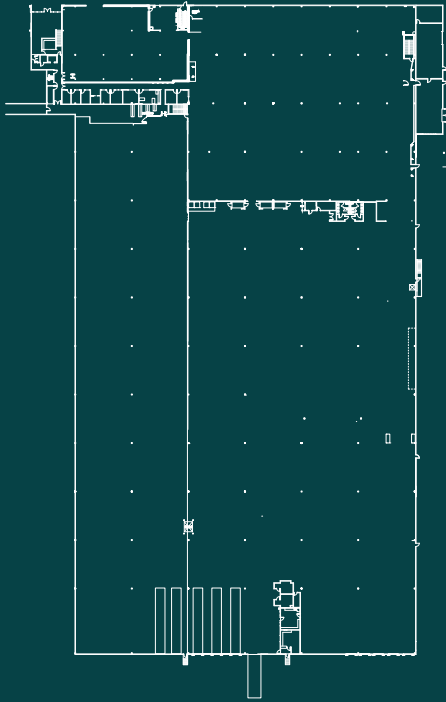

GROUND FLOOR
±214,850 SF

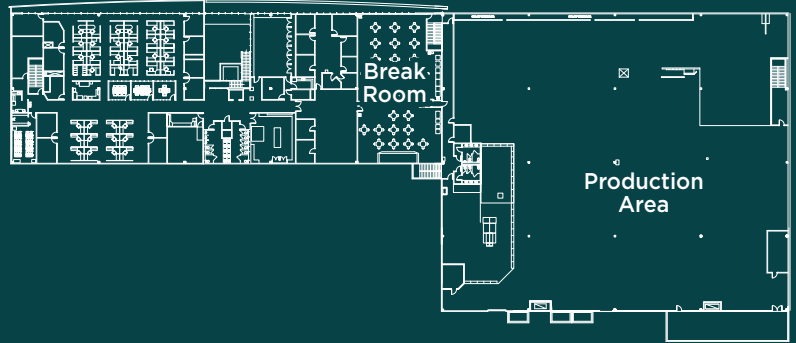

SECOND FLOOR
MEZZANINE
±63,200 SF

±278,050 SF
Total Facility Size

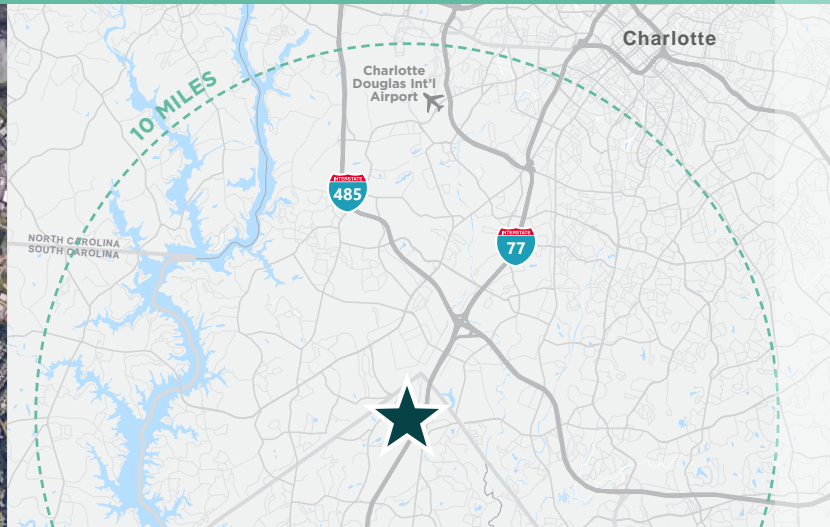

FOR MORE INFORMATION, PLEASE CONTACT

FERMIN DEOCA

+1 704 335 4436

fermin.deoca@cushwake.com

MATT TREBLE

+1 704 335 4430

matt.treble@cushwake.com



©2023 Cushman & Wakefield. All rights reserved. The information contained in this communication is strictly confidential. This information has been obtained from sources believed to be reliable but has not been verified. NO WARRANTY OR REPRESENTATION, EXPRESS OR IMPLIED, IS MADE AS TO THE CONDITION OF THE PROPERTY (OR PROPERTIES) REFERENCED HEREIN OR AS TO THE ACCURACY OR COMPLETENESS OF THE INFORMATION CONTAINED HEREIN, AND SAME IS SUBMITTED SUBJECT TO ERRORS, OMISSIONS, CHANGE OF PRICE, RENTAL OR OTHER CONDITIONS, WITHDRAWAL WITHOUT NOTICE, AND TO ANY SPECIAL LISTING CONDITIONS IMPOSED BY THE PROPERTY OWNER(S). ANY PROJECTIONS, OPINIONS OR ESTIMATES ARE SUBJECT TO UNCERTAINTY AND DO NOT SIGNIFY CURRENT OR FUTURE PROPERTY PERFORMANCE.