

2 BLOOR
STREET W

OFFICE FOR SUBLEASE

SUITE 1504 | 4,963 SF



CUSHMAN &
WAKEFIELD

2 BLOOR STREET W

Newly Built Model Suite
Suite 1504 - 4,963 SF (For Sublease)
Available Immediately

SPACE DETAILS

15th Floor 4,963 SF

Condition of Premises

- Gorgeous newly built model suite (constructed by Clearspace)
- Premises includes 5 offices, 1 boardroom (10 seats) and 2 meeting rooms (4-6 seats), open area with 19 workstations (based on current furniture layout)
- Polished concrete floors with exposed ceiling
- Glass interior offices
- Open concept with abundance of natural light and suspension lighting

Term May 30, 2030

Net Rent Negotiable

Additional Rent \$29.73 PSF (2024 Est.)

2 BLOOR STREET WEST BUILDING DETAILS

- There are 10 Armor gearless high-speed elevators with a capacity of 3,500 pounds or 22 persons.
- Located in the centre of the Bloor office district, part of a complex with three levels of retail extending from Yonge to Bay Street.
- Direct underground pedestrian connections to the Yonge/Bloor subway station beneath the Hudson Bay Centre and the Bay subway station under 1240 Bay Street.
- The building has undergone extensive renovations to the main lobby and common areas.



2 BLOOR STREET W

Newly Built Model Suite
Suite 1504 - 4,963 SF (For Sublease)
Available Immediately

FLOOR PLAN

[CLICK HERE FOR A VIRTUAL TOUR](#)

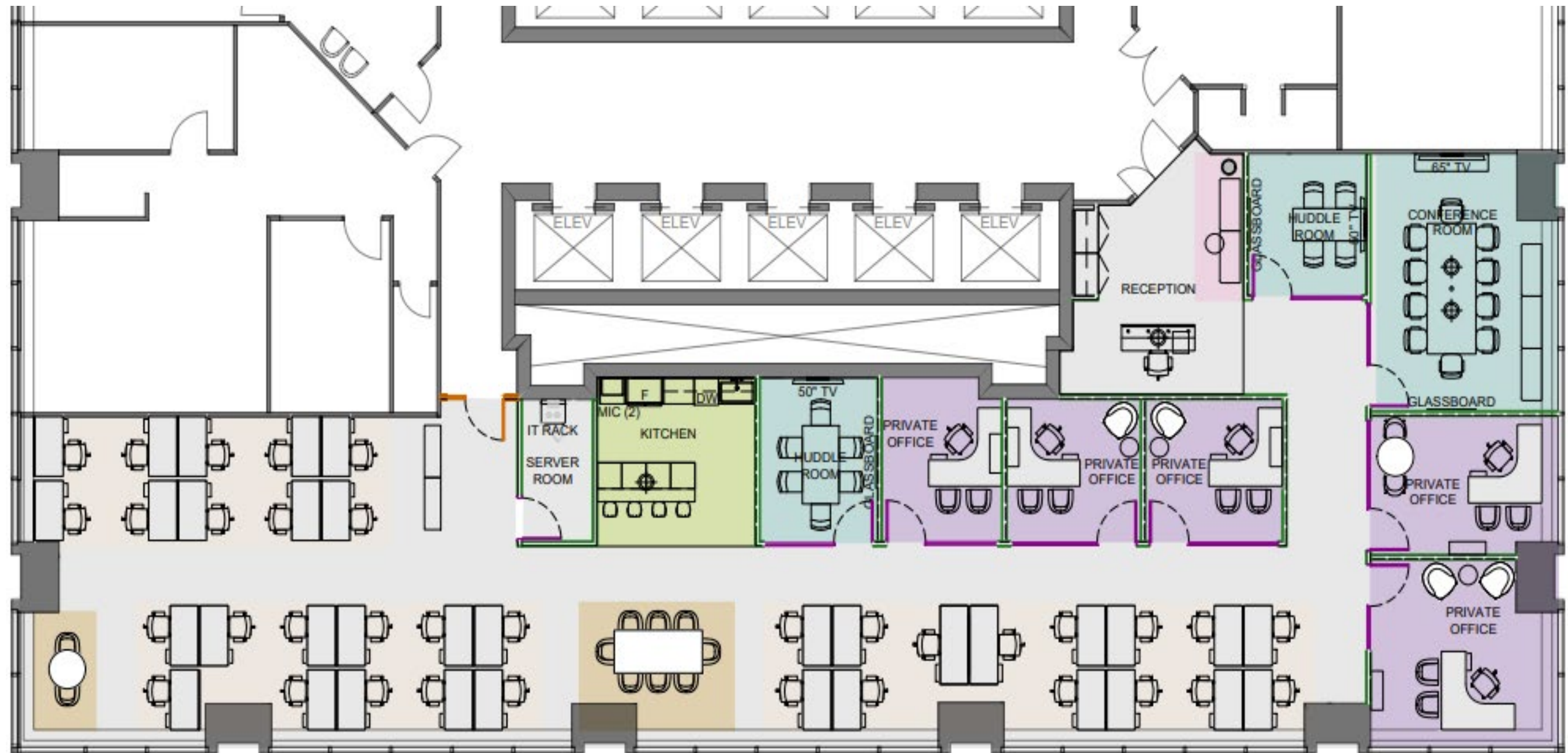

2 BLOOR STREET W

Newly Built Model Suite
Suite 1504 - 4,963 SF (For Sublease)
Available Immediately



Newly Renovated Ground Floor Lobby

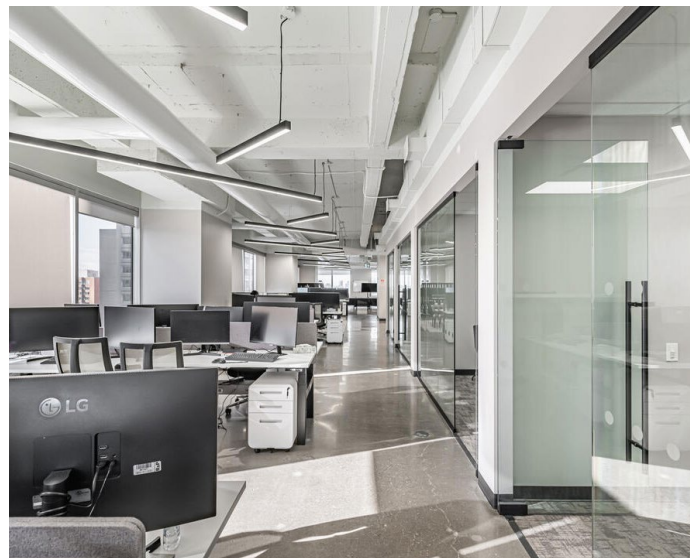

Images of interior premises

2 BLOOR STREET W



FOR MORE INFORMATION, CONTACT:

ERIC SHAW*
Executive Vice President
+1 416 359 2425
eric.shaw@cushwake.com

SABRINA OLIVER*
Associate
+1 416 359 2758
sabrina.oliver@cushwake.com

Cushman & Wakefield
161 Bay Street, Suite 1500
Toronto, ON M5J 2S1 | Canada
cushmanwakefield.com

