

4611 LISBORN DRIVE

CARMEL, IN 46033

8,800 Total Square Feet



PROPERTY HIGHLIGHTS



4611 LISBORN DRIVE | CARMEL, IN 46033

- 8,800 total square feet
- 2,200-6,600 square feet available for lease
- New, Class A construction
- Custom 14' drive-in door
- At-your-door parking
- Building signage available
- Immediate proximity to Bridgewater Country Club
- Asking sale price: \$2,300,000.00 (\$261.36/sf)
- Asking lease rate: \$25.00/sf net

FLOOR PLAN

4611 LISBORN DRIVE | CARMEL, IN 46033

8,800 TOTAL SF

- Suite 100: **LEASED**
- Suite 110: 2,200 sf
- Suite 120: 2,200 sf
- Suite 130: 2,200 sf
- Total Available: 6,600 sf

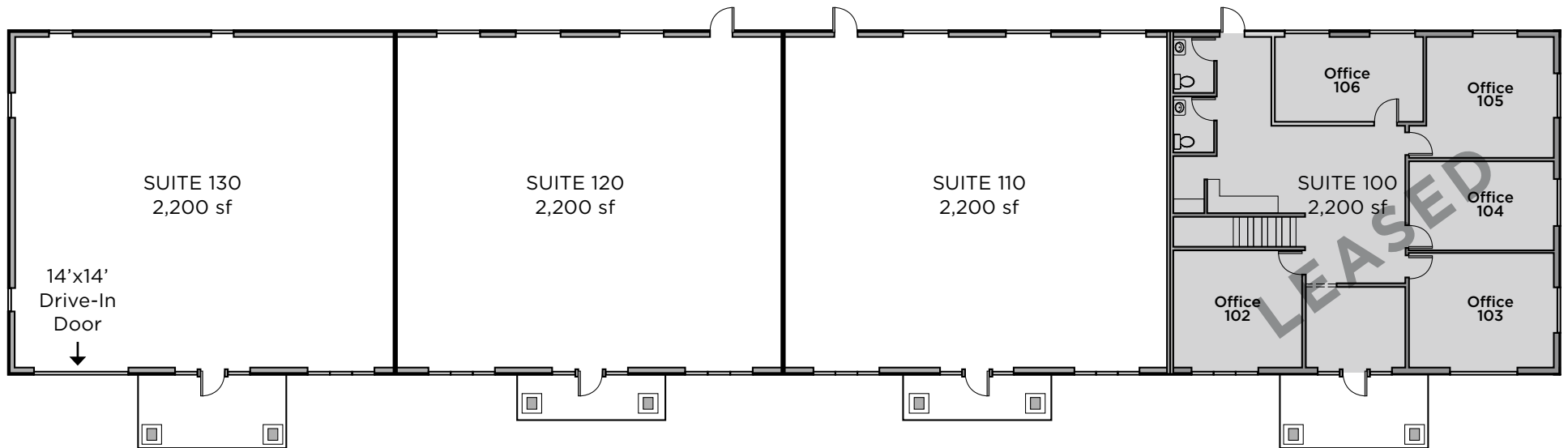

PROPERTY PHOTOS



AMENITY MAP

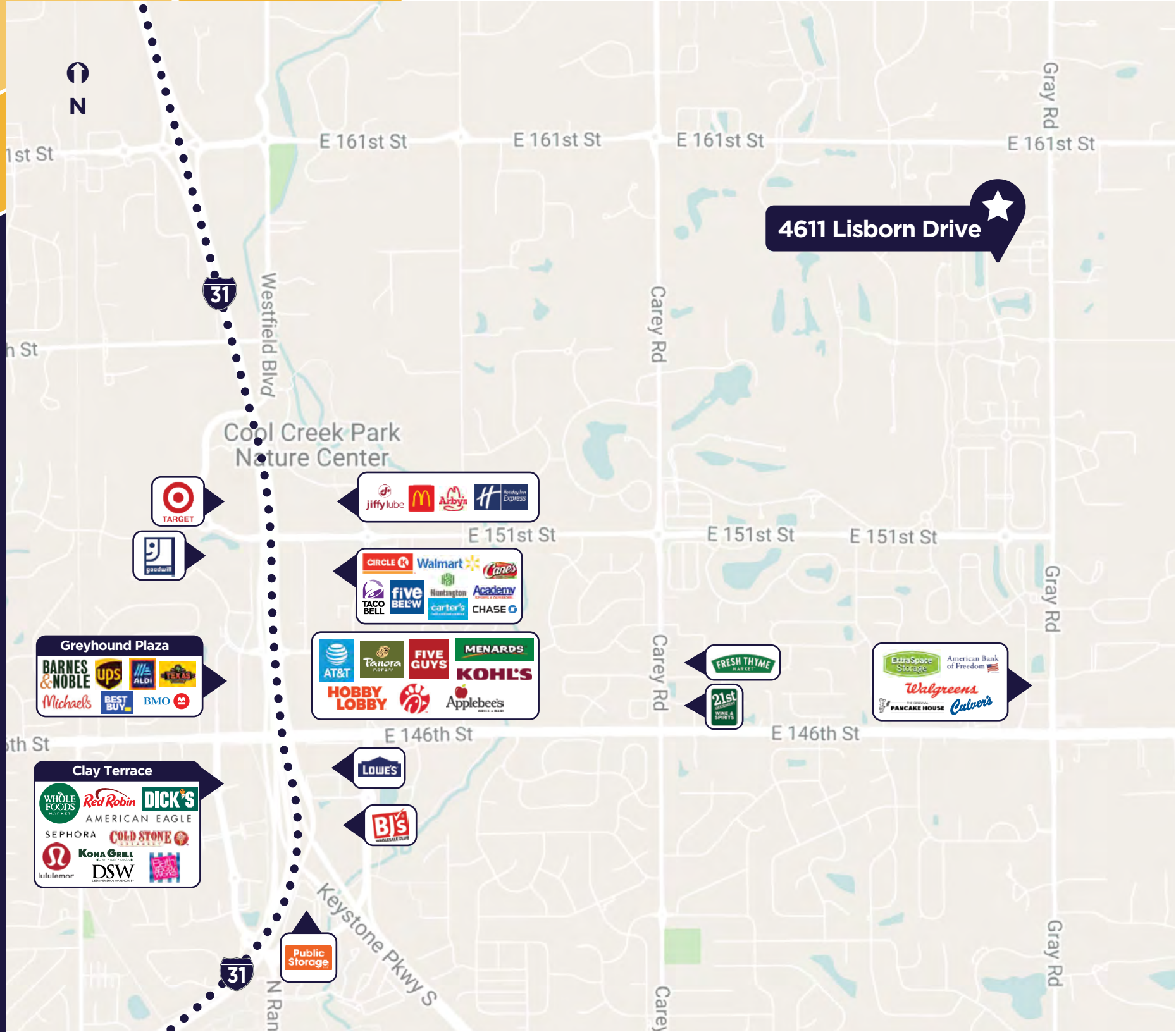

AERIAL MAP



4611 LISBORN DRIVE

KILLARNEY DR

LISBORN RD

LIMERICK DR

GRAY RD



For more information, please contact:

Bennett M. Williams

Director

Direct +1 317 639 0442

Mobile +1 317 414 4874

bennett.williams@cushwake.com

Megan Cuvelier

Director

Direct +1 317 352 5422

Mobile +1 317 760 8875

megan.cuvelier@cushwake.com

One American Square
Suite 1800
Indianapolis, IN 46282
cushmanwakefield.com

©2024 Cushman & Wakefield. All rights reserved. The information contained in this communication is strictly confidential. This information has been obtained from sources believed to be reliable but has not been verified. NO WARRANTY OR REPRESENTATION, EXPRESS OR IMPLIED, IS MADE AS TO THE CONDITION OF THE PROPERTY (OR PROPERTIES) REFERENCED HEREIN OR AS TO THE ACCURACY OR COMPLETENESS OF THE INFORMATION CONTAINED HEREIN, AND SAME IS SUBMITTED SUBJECT TO ERRORS, OMISSIONS, CHANGE OF PRICE, RENTAL OR OTHER CONDITIONS, WITHDRAWAL WITHOUT NOTICE, AND TO ANY SPECIAL LISTING CONDITIONS IMPOSED BY THE PROPERTY OWNER(S). ANY PROJECTIONS, OPINIONS OR ESTIMATES ARE SUBJECT TO UNCERTAINTY AND DO NOT SIGNIFY CURRENT OR FUTURE PROPERTY PERFORMANCE.