



TRADELANE AIRPORT CENTER – HOUSTON
19245 KENSWICK DRIVE, SUITE 100-200
HUMBLE, TX 77338
BUILDING 2

FOR LEASE

58,240 SF

LOCATION HIGHLIGHTS:

- Adjacent to George Bush International Airport (IAH)
- Access to Major Thoroughfares, including I-69, I-45, Beltway 8, and FM 1960.
- Desirable Location for Air Cargo Users

SPACE FEATURES

58,240 SF AVAILABLE

- 9,290 SF Office
- 48,950 SF Warehouse

UNIT FEATURES

- (20) 9'x10' Dock High Doors
- (3) 12'x14' Drive-In Ramp
- (1) 14'x14' Drive-In Ramp
- 52' x 53'-4" Column Spacing
- 24' Clear Height
- ESFR Sprinkler System
- Rear Load Configuration
- Ample Parking
- Fenced Truck Court / Paved Outside Storage

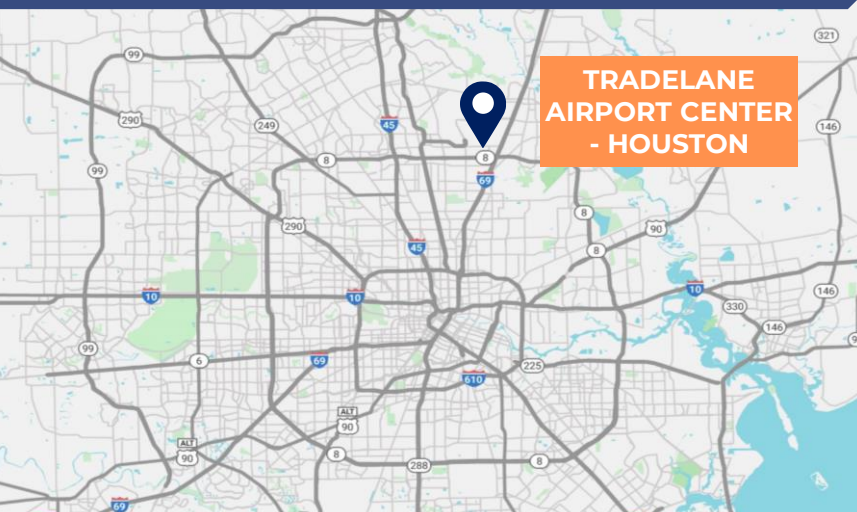



58,240 SF FLOOR PLAN

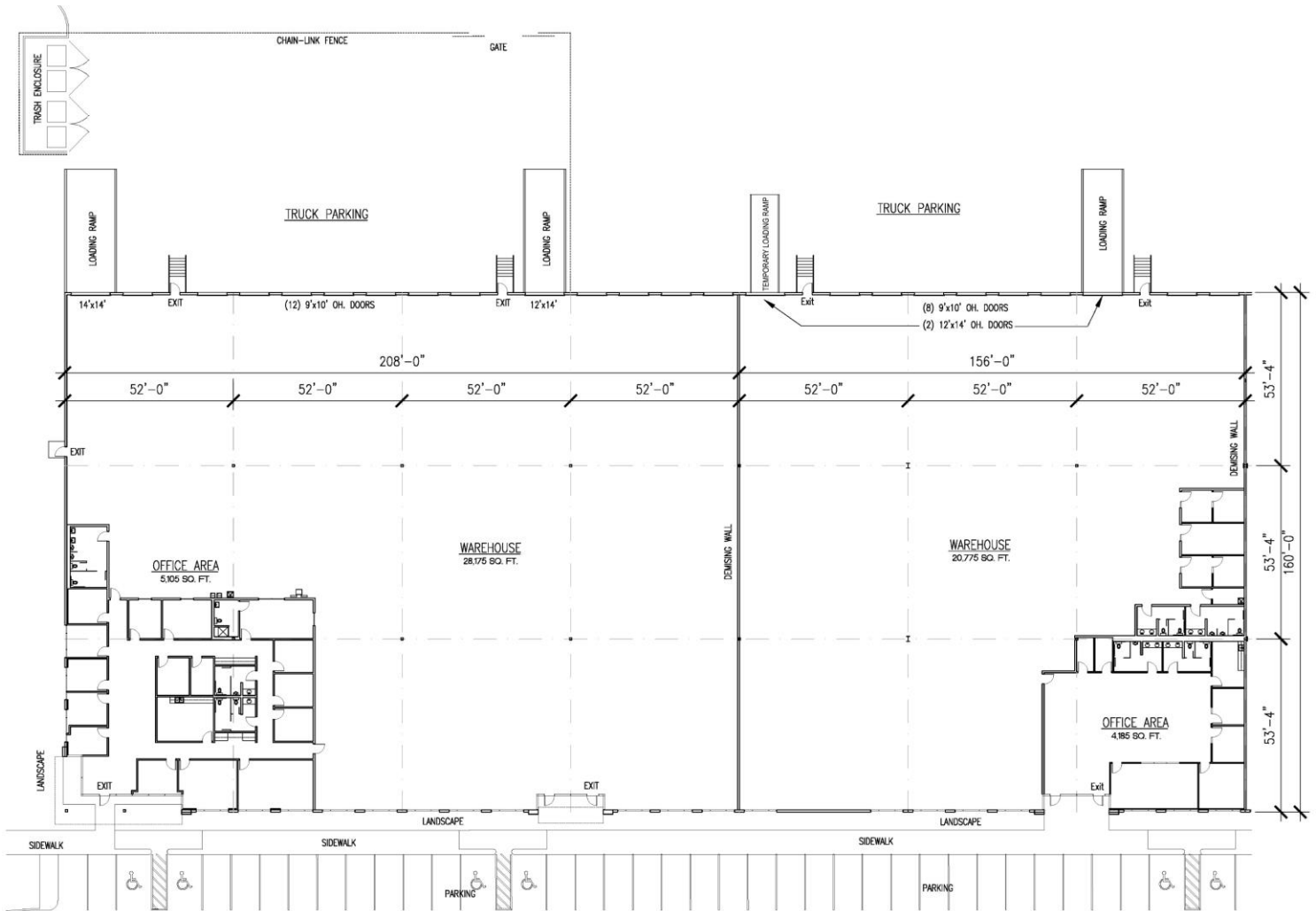



CONTACT US

JOHN KRUSE
MANAGING DIRECTOR
+1 713 304 4919
john.kruse@cushwake.com

CARTER HOLMES
SENIOR ASSOCIATE
+1 713 417 5447
carter.holmes@cushwake.com

KELLY LANDWERMEYER
MANAGING DIRECTOR
+1 713 249 4295
kelly.landwermeier@cushwake.com



CONTACT US

JOHN KRUSE
MANAGING DIRECTOR
+1 713 304 4919
john.kruse@cushwake.com

CARTER HOLMES
SENIOR ASSOCIATE
+1 713 417 5447
carter.holmes@cushwake.com

KELLY LANDWERMEYER
MANAGING DIRECTOR
+1 713 249 4295
kelly.landwermeier@cushwake.com