

25,232 SF FREESTANDING INDUSTRIAL BUILDING

AVAILABLE FOR LEASE



1346 S 28TH STREET, SAN DIEGO, CALIFORNIA 92113

BRANT ABERG, SIOR  
858.546.5464  
brant.aberg@cushwake.com  
CA Lic. 01773573

TRENT SMITH  
619.988.5340  
trent.smith@cushwake.com  
CA Lic. 02189114



Cushman & Wakefield  
12830 El Camino Real, Suite 100  
San Diego, CA 92130  
www.cushmanwakefield.com

# 1346 S 28TH STREET SAN DIEGO, CA 92113

## PROPERTY OVERVIEW

- 25,232 SF freestanding industrial building available for lease
- Dock & grade level loading doors
- ±18' warehouse clearance
- 1,200 amps, 120/240v 3-phase
- Fully sprinklered
- Secured yard
- Available February 2025
- Lease Rate: \$1.50 PSF Gross

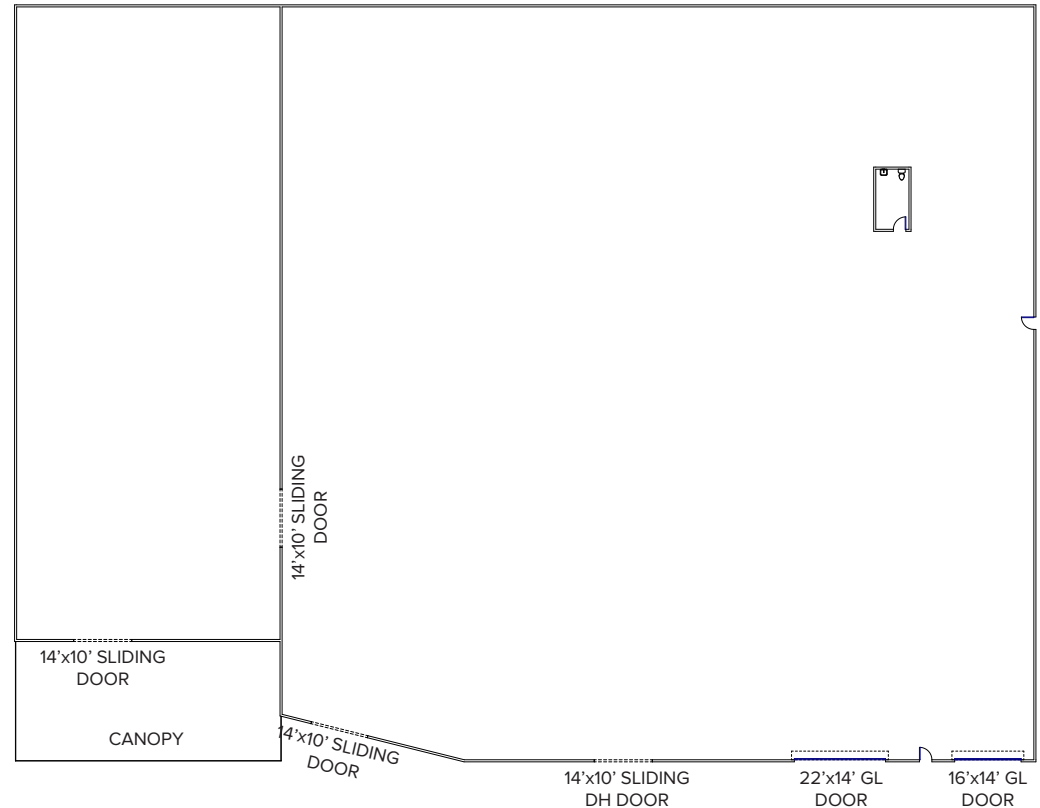

©CUSHMAN & WAKEFIELD. ALL RIGHTS RESERVED. THIS INFORMATION HAS BEEN OBTAINED FROM SOURCES BELIEVED TO BE RELIABLE BUT HAS NOT BEEN VERIFIED. NO WARRANTY OR REPRESENTATION, EXPRESS OR IMPLIED, IS MADE AS TO THE CONDITION OF THE PROPERTY (OR PROPERTIES) REFERENCED HEREIN OR AS TO THE ACCURACY OR COMPLETENESS OF THE INFORMATION CONTAINED HEREIN, AND SAME IS SUBMITTED SUBJECT TO ERRORS, OMISSIONS, CHANGE OF PRICE, RENTAL OR OTHER CONDITIONS, WITHDRAWAL WITHOUT NOTICE, AND TO ANY SPECIAL LISTING CONDITIONS IMPOSED BY THE PROPERTY OWNER(S).

**BRANT ABERG, SIOR**  
858.546.5464  
brant.aberg@cushwake.com  
CA Lic. 01773573

**TRENT SMITH**  
619.988.5340  
trent.smith@cushwake.com  
CA Lic. 02189114



Cushman & Wakefield  
12830 El Camino Real, Suite 100  
San Diego, CA 92130  
www.cushmanwakefield.com