



CUSHMAN &  
WAKEFIELD

11,500 SF AVAILABLE

# 3201 BEECHLEAF COURT

RALEIGH, NC 27604

# 11,500 RSF AVAILABLE

3201 BEECHLEAF COURT

## PROPERTY FEATURES

- 167,758 SF Class A Office Building
- Parking Ratio: 4.00/1,000 SF with 245
- Business campus environment conveniently located within close proximity to banks, hotels, residential communities, restaurants, and shopping.

## ON-SITE AMENITIES INCLUDE

- 24 Hour Access
- Controlled Access
- Day Care
- Signage available
- First floor lockers & showers
- Car Charging Stations

## SUITE 402 FEATURES

- 11,500 RSF Available on the 4<sup>th</sup> Floor
- Move-in ready

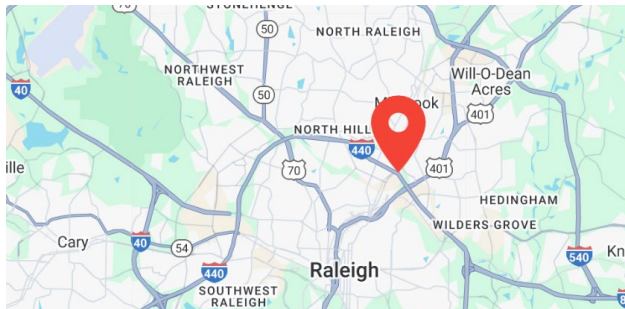

# SUITE 402 PHOTOS

11,500 SF



# FLOORPLAN

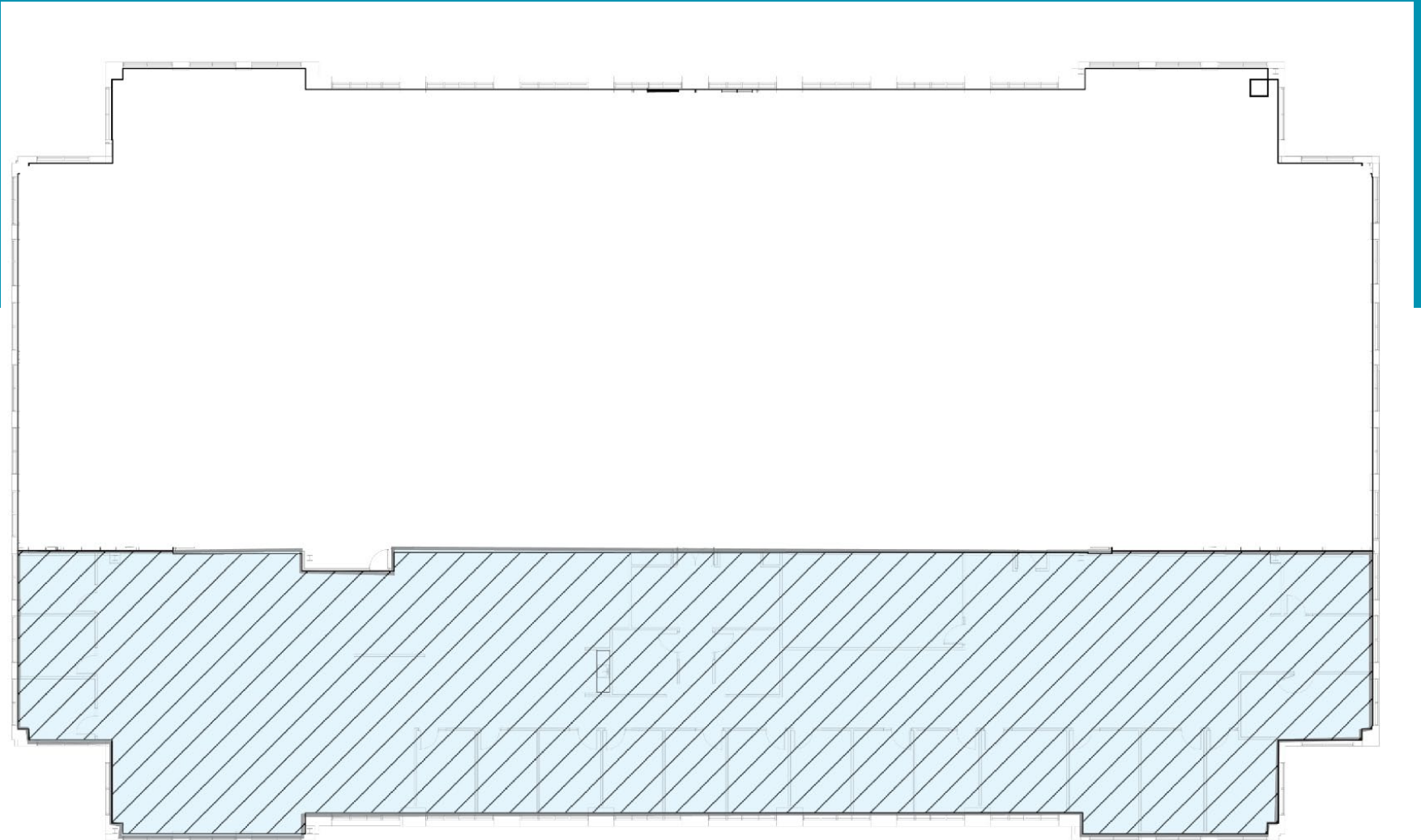

SUITE 402: 11,500 SF



## Contact Info

### **Kent Honeycutt**

Senior Director

+1 919 612 2766

[kent.honeycutt@cushwake.com](mailto:kent.honeycutt@cushwake.com)

1 Fenton Main St, Ste 480

Cary, NC 27511

[cushmanwakefield.com](http://cushmanwakefield.com)

©2021 Cushman & Wakefield. All rights reserved. The information contained in this communication is strictly confidential. This information has been obtained from sources believed to be reliable but has not been verified. NO WARRANTY OR REPRESENTATION, EXPRESS OR IMPLIED, IS MADE AS TO THE CONDITION OF THE PROPERTY (OR PROPERTIES) REFERENCED HEREIN OR AS TO THE ACCURACY OR COMPLETENESS OF THE INFORMATION CONTAINED HEREIN, AND SAME IS SUBMITTED SUBJECT TO ERRORS, OMISSIONS, CHANGE OF PRICE, RENTAL OR OTHER CONDITIONS, WITHDRAWAL WITHOUT NOTICE, AND TO ANY SPECIAL LISTING CONDITIONS IMPOSED BY THE PROPERTY OWNER(S). ANY PROJECTIONS, OPINIONS OR ESTIMATES ARE SUBJECT TO UNCERTAINTY AND DO NOT SIGNIFY CURRENT OR FUTURE PROPERTY PERFORMANCE.