

FOR SUBLEASE

±22,313 SF WITH SECURED YARD



**SIGNIFICANTLY
UPGRADED
POWER**

201 E. MAYFLOWER AVE.

Owned by:
Ledo Capital Group

NORTH LAS VEGAS, NV 89030

 **CUSHMAN &
WAKEFIELD**

PROPERTY FEATURES

- + ±22,313 Total SF
- + ±4,072 SF Office
- + ±18,241 SF Warehouse
- + 3,500 Amps, 277/480v, 3-Phase Power
- + 2 Dock Doors (8'x8')
- + 3 Grade Doors (14'x14')
- + 20' Clear Height
- + Sprinklers
- + Secured Yard
- + ±1.25 Acres
- + Concrete-tilt Construction
- + APN: 139-15-615-025
- + North Las Vegas Jurisdiction
- + M-2 Zoning

**BASE RENT:
\$1.20 PSF**

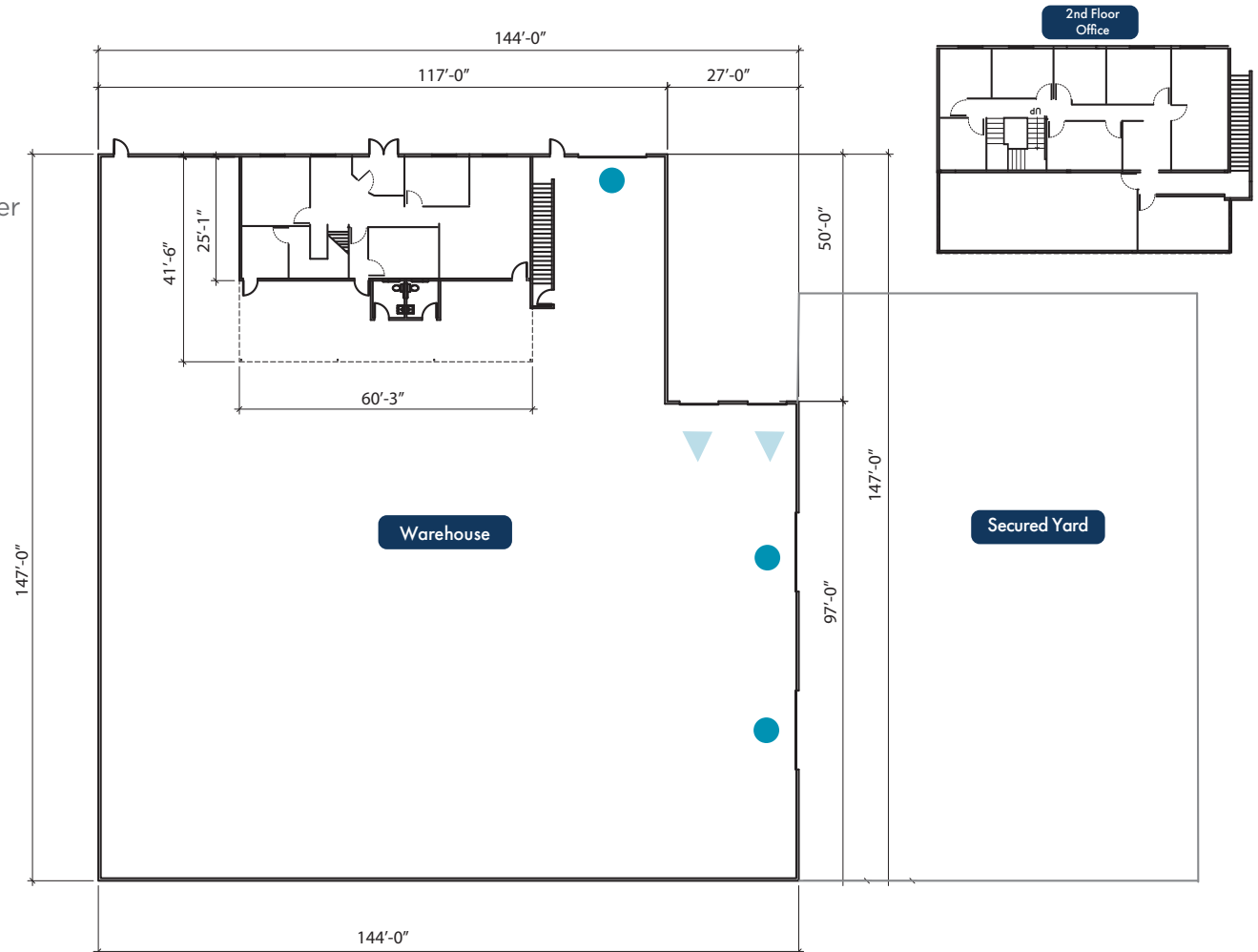

For Illustration Purposes Only. Not To Scale.

▼ DOCK DOOR

● GRADE DOOR



RECENT CAPITAL IMPROVEMENTS

- + New Seal Coat on Parking Lot and Yard Area (2022)
- + All New Evaporative Coolers in Warehouse (2022)
- + All New HVAC in Office (2022)
- + Exterior Building Paint (2022)
- + Roof Replaced in 2016 (Under Warranty until 2031)



201 E. Mayflower Ave., North Las Vegas, NV 89030

LOCATION AERIAL



LOCATION HIGHLIGHTS



CONTACT INFORMATION



Alma Cuevas, SIOR

Senior Director
Industrial Advisory Services
Mobile: +1 702 303 4412
alma.cuevas@cushwake.com
LIC #S.0180089.LLC



Jason Griffis

Senior Director
Industrial Advisory Services
Mobile: +1 702 205 3861
jason.griffis@cushwake.com
LIC #S.0178374



Michael Scher

Associate
Industrial Advisory Services
Mobile: +1 615 319 9963
michael.scher@cushwake.com
LIC #S.0189923