



GLOBE DISTRIBUTION  
CENTER

# 25300 GLOBE STREET

MORENO VALLEY, CA 92551

FOR LEASE | 402,540 SF Distribution Building

AVAILABLE  
August 1, 2024

 [globedistributioncenter.com](http://globedistributioncenter.com)

Chuck Belden, SIOR  
+1 909 942 4640  
chuck.belden@cushwake.com  
Lic. No: 00844840

Tim Pimentel, SIOR  
+1 909 942 4647  
tim.pimentel@cushwake.com  
Lic. No: 01421452

Brice Larson  
+1 909 942 4642  
brice.larson@cushwake.com  
Lic. No: 02056356

Chris Pimentel  
+1 909 942 4600  
chris.pimentel@cushwake.com  
Lic. No: 02207632





# GLOBE DISTRIBUTION CENTER

25300 GLOBE STREET  
MORENO VALLEY, CA

[globedistributioncenter.com](http://globedistributioncenter.com)

## PROPERTY FEATURES



402,540 SF Distribution Building



3,000 Amp Building Service (480/277 Volt, 3-Phase)



72 Dock High Doors (8'6"x10')



8,698 SF Office Space (3,958 SF West side/ 4,740 SF East side)



191' Fully Secured Concrete Truck Court



1 Grade Level Loading Door (12'x14')



141 Auto Parking



80 Trailer Parking



32' Clear Height



ESFR Sprinkler System



3% Skylights



Excellent I-215 Freeway via Harley Knox Blvd on/off ramps

Chuck Belden, SIOR  
+1 909 942 4640  
chuck.belden@cushwake.com  
Lic. No: 00844840

Tim Pimentel, SIOR  
+1 909 942 4647  
tim.pimentel@cushwake.com  
Lic. No: 01421452

Brice Larson  
+1 909 942 4642  
brice.larson@cushwake.com  
Lic. No: 02056356

Chris Pimentel  
+1 909 942 4600  
chris.pimentel@cushwake.com  
Lic. No: 02207632





# GLOBE DISTRIBUTION CENTER

25300 GLOBE STREET  
MORENO VALLEY, CA

## SITE PLAN

[globedistributioncenter.com](http://globedistributioncenter.com)

**191'**  
Truck Court

**72**  
Dock Doors

**80**  
Trailer Stalls

**141**  
Auto Parking

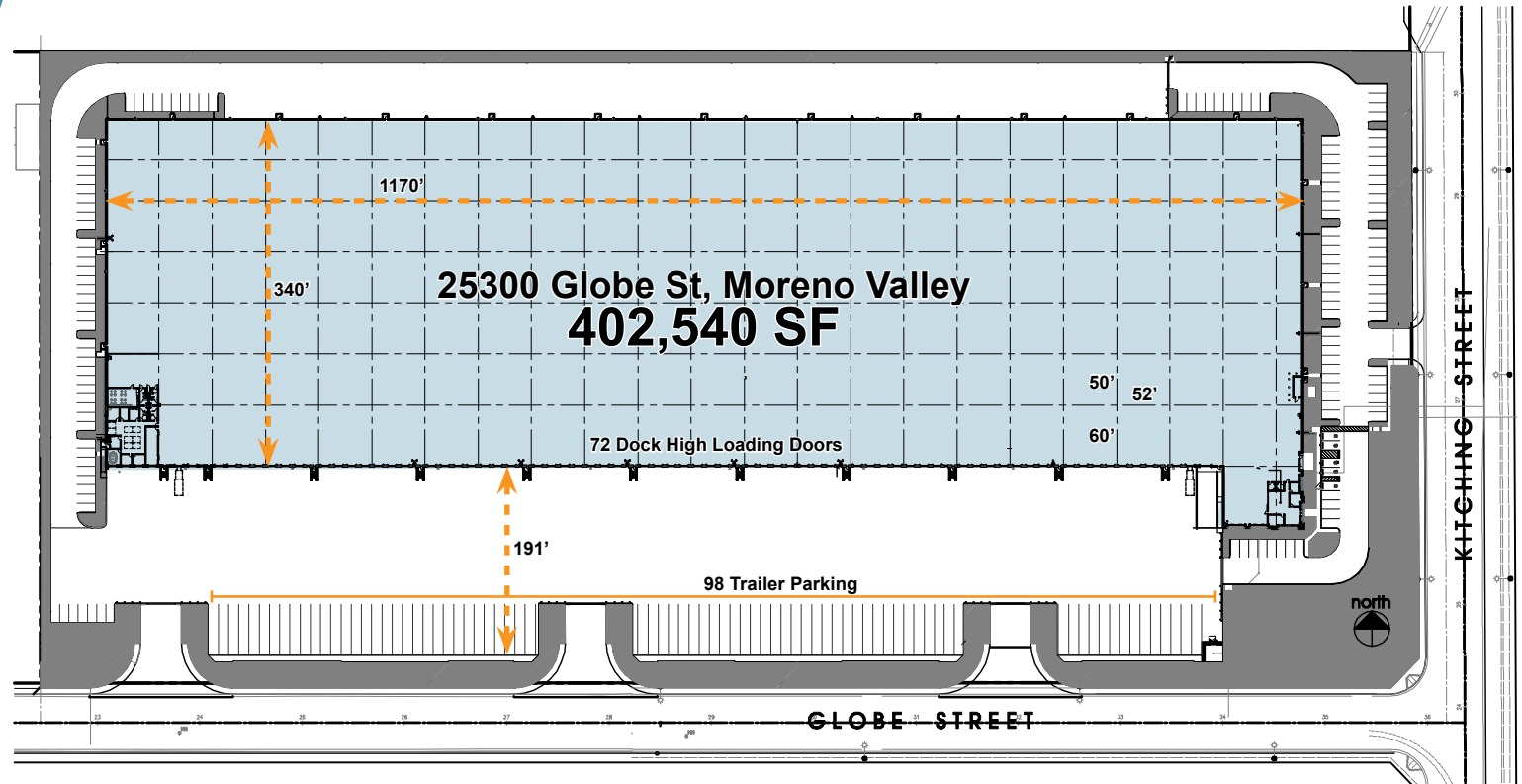

Marketing & Management by:



**IDS**  
REAL ESTATE GROUP

Chuck Belden, SIOR  
+1 909 942 4640  
chuck.belden@cushwake.com  
Lic. No: 00844840

Tim Pimentel, SIOR  
+1 909 942 4647  
tim.pimentel@cushwake.com  
Lic. No: 01421452

Brice Larson  
+1 909 942 4642  
brice.larson@cushwake.com  
Lic. No: 02056356

Chris Pimentel  
+1 909 942 4600  
chris.pimentel@cushwake.com  
Lic. No: 02207632





# GLOBE DISTRIBUTION CENTER

25300 GLOBE STREET  
MORENO VALLEY, CA

## CORPORATE NEIGHBORS

[globedistributioncenter.com](http://globedistributioncenter.com)

Designated Truck Route



Chuck Belden, SIOR  
+1 909 942 4640  
chuck.belden@cushwake.com  
Lic. No: 00844840

Tim Pimentel, SIOR  
+1 909 942 4647  
tim.pimentel@cushwake.com  
Lic. No: 01421452

Brice Larson  
+1 909 942 4642  
brice.larson@cushwake.com  
Lic. No: 02056356

Chris Pimentel  
+1 909 942 4600  
chris.pimentel@cushwake.com  
Lic. No: 02207632



©2023 Cushman & Wakefield. All rights reserved. This information has been obtained from sources believed to be reliable but has not been verified. NO WARRANTY OR REPRESENTATION, EXPRESS OR IMPLIED, IS MADE AS TO THE CONDITION OF THE PROPERTY (OR PROPERTIES) REFERENCED HEREIN OR AS TO THE ACCURACY OR COMPLETENESS OF THE INFORMATION CONTAINED HEREIN, AND SAME IS SUBMITTED SUBJECT TO ERRORS, OMISSIONS, CHANGE OF PRICE, RENTAL OR OTHER CONDITIONS, WITHDRAWAL WITHOUT NOTICE, AND TO ANY SPECIAL LISTING CONDITIONS IMPOSED BY THE PROPERTY OWNER(S).



# GLOBE DISTRIBUTION CENTER

25300 GLOBE STREET  
MORENO VALLEY, CA

## LOCATION MAP

 [globedistributioncenter.com](http://globedistributioncenter.com)



UNINCORPORATED  
RIVERSIDE COUNTY

Chuck Belden, SIOR  
+1 909 942 4640  
chuck.belden@cushwake.com  
Lic. No: 00844840

Tim Pimentel, SIOR  
+1 909 942 4647  
tim.pimentel@cushwake.com  
Lic. No: 01421452

Brice Larson  
+1 909 942 4642  
brice.larson@cushwake.com  
Lic. No: 02056356

Chris Pimentel  
+1 909 942 4600  
chris.pimentel@cushwake.com  
Lic. No: 02207632





# GLOBE DISTRIBUTION CENTER

25300 GLOBE STREET  
MORENO VALLEY, CA

 [globedistributioncenter.com](http://globedistributioncenter.com)

Marketing &  
Management by:



Chuck Belden, SIOR  
+1 909 942 4640  
chuck.belden@cushwake.com  
Lic. No: 00844840

Tim Pimentel, SIOR  
+1 909 942 4647  
tim.pimentel@cushwake.com  
Lic. No: 01421452

Brice Larson  
+1 909 942 4642  
brice.larson@cushwake.com  
Lic. No: 02056356

Chris Pimentel  
+1 909 942 4600  
chris.pimentel@cushwake.com  
Lic. No: 02207632



**CUSHMAN &  
WAKEFIELD**